



STAINLESS STEEL

# Fabricated Economy SINKS

## One & Two Compartments



**Item #:** \_\_\_\_\_ **Qty #:** \_\_\_\_\_

**Model #:** \_\_\_\_\_

**Project #:** \_\_\_\_\_



K-700  
Removable  
Side Splashes  
Fits Left OR  
Right Side

Fabricated Bowls are Welded Together at the Seams

**MATERIAL:**

1 5/8" diameter stainless steel legs with 1" adjustable stainless steel bullet feet.

Entire unit is 16 gauge 304 stainless steel.

Gussets - stainless steel.

**MECHANICAL:**

- Supply is 1/2" IPS hot & cold.
- Faucet holes on 8" centers.
- Faucets are not included **(see accessories)**.
- Waste drains are 1 1/2" IPS S/S basket type, located in center of sink bowl, and are included.

**FEATURES:**

Backsplash has tile edge for ease of installation.

Sink bowls are 3/4" coved corner and meet NSF requirements.

Rolled Rim Edge for additional strength.

Sink Bowls are 14" deep for greater capacity.

**NOTE: 15" x 15" bowls are 12" deep.**

**CONSTRUCTION:**

All TIG welded.

Welded areas blended to match adjacent surfaces and to a satin finish.

Gussets welded to a die-formed reinforced plate.



Customer Service Available To Assist You **1-800-645-3166** 8:30 am - 8:00 pm E.S.T.

Email Orders To: [customer@advancetabco.com](mailto:customer@advancetabco.com). For Smart Fabrication™ Quotes, Email To: [smartfab@advancetabco.com](mailto:smartfab@advancetabco.com) or Fax To: 631-586-2933

**NEW YORK**  
Fax: (631) 242-6900

**GEORGIA**  
Fax: (770) 775-5625

**TEXAS**  
Fax: (972) 932-4795

**NEVADA**  
Fax: (775) 972-1578

# DIMENSIONS and SPECIFICATIONS

TOL Overall: ± .500"  
Interior: ± .250"

ALL DIMENSIONS ARE TYPICAL

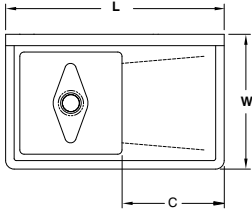

1 COMP - 1 DRBD

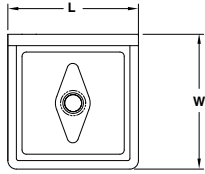

1 COMP

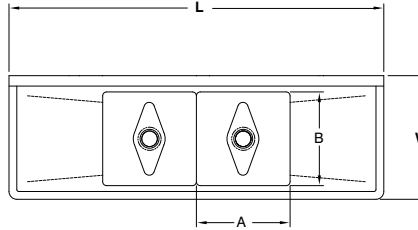

2 COMP - 2 DRBD

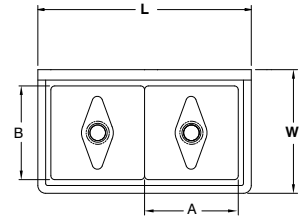

2 COMP

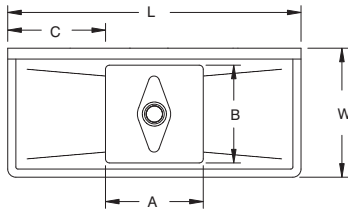

1 COMP - 2 DRBD

ACCESSORIES	Model #	Qty
DRAINS		
FAUCETS		



	MODEL #	Length L	Width W	Bowl Size A & B	Drbd. Length C	# of Drbrds.	Drbd. Location	Wt
ONE COMPARTMENT	FC-1-1818	23"	24"	18"x18"	N/A	0	None	60 lbs.
	FC-1-1818-18RorL	38 1/2"	24"		18"	1	Specify	65 lbs.
	FC-1-1818-24RorL	44 1/2"	24"		24"	1	Specify	70 lbs.
	FC-1-1818-18RL	54"	24"		18"	2	R & L	90 lbs.
	FC-1-1818-24RL	66"	24"	24"	2	R & L	100 lbs.	
	FC-1-1824	23"	30"	18"x24"	N/A	0	None	67 lbs.
	FC-1-1824-18RorL	38 1/2"	30"		18"	1	Specify	105 lbs.
	FC-1-1824-24RorL	45"	30"		24"	1	Specify	115 lbs.
FC-1-1824-18RL	54"	30"	18"		2	R & L	120 lbs.	
FC-1-1824-24RL	66"	30"	24"	2	R & L	130 lbs.		
TWO COMPARTMENTS	FC-1-2424	29"	30"	24"x24"	N/A	0	None	90 lbs.
	FC-1-2424-18RorL	45"	30"		18"	1	Specify	118 lbs.
	FC-1-2424-24RorL	50 1/2"	30"		24"	1	Specify	123 lbs.
	FC-1-2424-18RL	60"	30"		18"	2	R & L	135 lbs.
	FC-1-2424-24RL	72"	30"	24"	2	R & L	145 lbs.	
	FC-2-1515**	35"	20 1/2"	15"x15"	N/A	0	None	78 lbs.
	FC-2-1818	41"	24"	18"x18"	N/A	0	None	83 lbs.
	FC-2-1818-18RorL	56 1/2"	24"		18"	1	Specify	90 lbs.
FC-2-1818-18RL	72"	24"	18"		2	R & L	105 lbs.	
FC-2-1818-24RL	84"	24"	24"		2	R & L	115 lbs.	
FC-2-1824	41"	30"	18"x24"	N/A	0	None	115 lbs.	
FC-2-1824-18RorL	56 1/2"	30"		24"	1	Specify	130 lbs.	
FC-2-1824-24RorL	62 1/2"	30"		24"	1	Specify	140 lbs.	
FC-2-1824-18RL	72"	30"		18"	2	R & L	145 lbs.	
FC-2-1824-24RL	84"	30"	24"	2	R & L	160 lbs.		
FC-2-2424	53"	30"	24"x24"	N/A	0	None	138 lbs.	
FC-2-2424-18RorL	68 1/2"	30"		18"	1	Specify	155 lbs.	
FC-2-2424-18RL	84"	30"		18"	2	R & L	210 lbs.	
FC-2-2424-24RorL	74 1/2"	30"		24"	1	Specify	195 lbs.	
FC-2-2424-24RL	96"	30"	24"	2	R & L	225 lbs.		

\*\*15" x 15" Bowls are 12" Deep

