



STAINLESS STEEL Cocktail Workstations NSF 18" and 21" Wide Units

Item #: _____ Qty #: _____
 Model #: _____
 Project #: _____



SLW Series
18" Wide Units



CRW Series
21" Wide Units

FEATURES:

- 23" x 15" x 8" insulated ice bin on either left or right side.
- Two removable injection molded 3-pack plastic bottle racks.
- 24" embossed and seamless drainboard.
- 4" high backsplash.
- Black powder coated cross-braced legs with adjustable black plastic bullet feet.
- Optional 7-circuit cold plate sealed into bottom of ice bin.

MECHANICAL:

- 1" IPS drains in drainboard and ice bin.
- 1/2" IPS drain (ice bin with optional cold plate)

MATERIAL:

- Ice Bin, Front Apron, Backsplash:** 22 gauge, 300 stainless steel
- Sides:** 20 gauge, 430 stainless steel
- Understructure:** 22 gauge, galvanneal front/back; 11 gauge electrogalvanneal leg channel
- Legs:** Black powder coated 1 5/8" O.D. 18 gauge, galvanized steel with adjustable black plastic bullet feet
- Ice Bin Insulation:** 2 lbs. density styrofoam (non-cold plate models); 2 lbs. density foam-in-place
- Cold Plate:** Cast aluminum with 7 circuits (5 syrup and 2 water lines) with 5/16" diameter stainless steel bump and swedge ends

OPTIONAL:

- SU-10** - Upgrade to stainless steel legs and bullet feet
- SU-40** - Prep unit for installation of speed rail
- SU-68** - Omit corrugation on drainboard

18" WIDE			21" WIDE			Overall Length	Ice Bin Capacity	Ice Bin Location
Model #	Approx. Weight	Approx. Cu. Ft.	Model #	Approx. Weight	Approx. Cu. Ft.			
SLW-4L	65 lbs.	12	CRW-4L	72 lbs.	13	47"	54 lbs.	Left
SLW-4R	65 lbs.	12	CRW-4R	72 lbs.	13	47"	54 lbs.	Right

With 7-Circuit Cold Plate

SLW-4L-7	100 lbs.	12	CRW-4L-7	108 lbs.	13	47"	54 lbs.	Left
SLW-4R-7	100 lbs.	12	CRW-4R-7	108 lbs.	13	47"	54 lbs.	Right



Customer Service Available To Assist You 1-800-645-3166 8:30 am - 8:00 pm E.S.T.

For Orders & Customer Service:
 Email: customer@advancetabco.com or Fax: 631-242-6900

For Smart Fabrication™ Quotes:
 Email: smartfab@advancetabco.com or Fax: 631-586-2933

DIMENSIONS and SPECIFICATIONS

TOL Overall: ± .500" Interior: ± .250"

ALL DIMENSIONS ARE TYPICAL

SLW Series

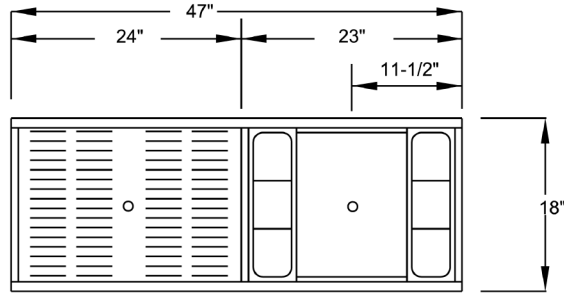
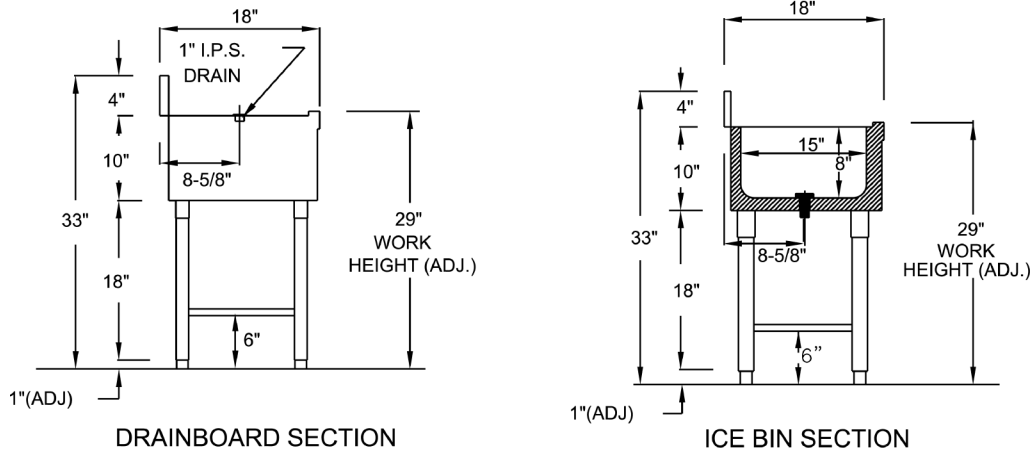

CRW Series

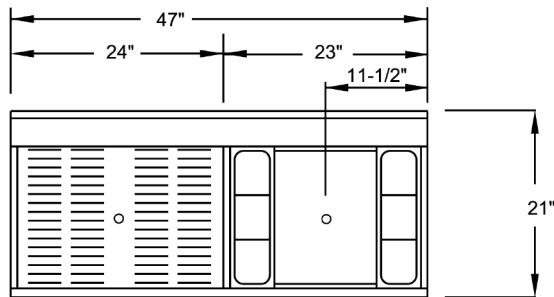
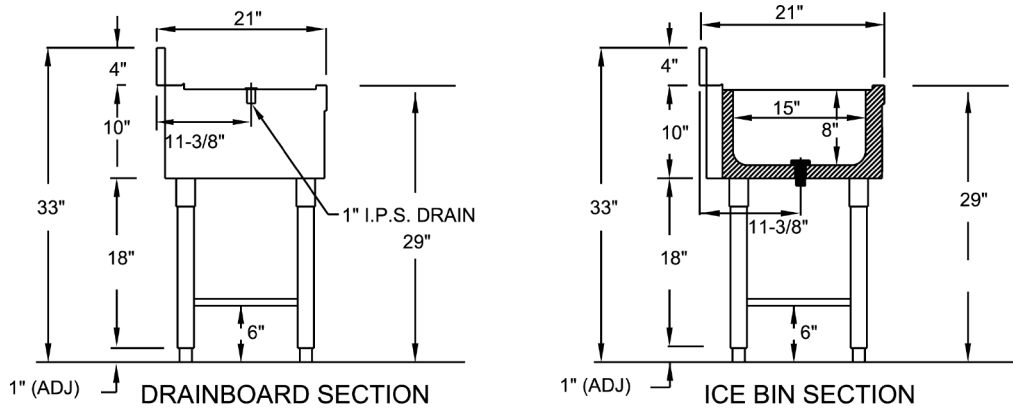

ADVANCE TABCO is constantly engaged in a program of improving our products. Therefore, we reserve the right to change specifications without prior notice.