

**Item #:** \_\_\_\_\_ **Qty #:** \_\_\_\_\_  
**Model #:** \_\_\_\_\_  
**Project #:** \_\_\_\_\_



MODEL #	Length	A	Wt.
EDC-1548-X	48"	15"	155 lbs.
EDC-1560-X	60"	15"	195 lbs.
EDC-1572-X	72"	15"	225 lbs.
EDC-1848-X	48"	18"	170 lbs.
EDC-1860-X	60"	18"	205 lbs.
EDC-1872-X	72"	18"	245 lbs.

## DETAILS and SPECIFICATIONS

### FEATURES:

FLAT TOP is furnished with a 1 5/8" sanitary rolled rim on the front and 1 5/8" square bend edges on the 2 sides and rear.  
 Rear flush panel along the rear of the base unit.

### MATERIAL:

TOP is heavy gauge stainless steel with galvanized hat channel.  
 BODY is heavy gauge stainless steel.  
 LEGS are 1 5/8" diameter tubular stainless steel with stainless steel gussets and 1" adjustable stainless steel bullet feet.

### CONSTRUCTION:

All TIG welded. Exposed areas finished to match adjacent surfaces.  
 Entire Top is mechanically polished to a satin finish and is sound deadened.  
 Roll formed embossed galvanized hat channels are secured to top by means of structural sound-deadening adhesive and weld studs.  
 UNIT-BODY DESIGN sides, back and shelf are welded to form a single rigid structure.  
 Gussets welded to support hat sections.

TOL ± .500"

ALL DIMENSIONS ARE TYPICAL

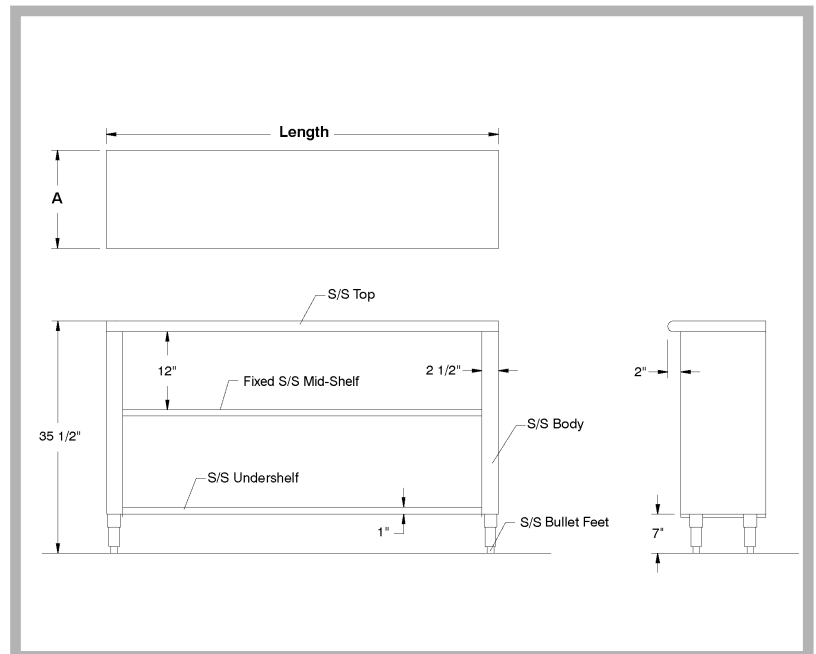

**Customer Service Available To Assist You 1-800-645-3166 8:30 am - 8:00 pm E.S.T.**  
 Email Orders To: [customer@advancetabco.com](mailto:customer@advancetabco.com). For Smart Fabrication™ Quotes, Email To: [smartfab@advancetabco.com](mailto:smartfab@advancetabco.com) or Fax To: 631-586-2933

**NEW YORK**  
 Fax: (631) 242-6900

**GEORGIA**  
 Fax: (770) 775-5625

**TEXAS**  
 Fax: (972) 932-4795

**NEVADA**  
 Fax: (775) 972-1578