



STAINLESS STEEL HEAVY DUTY WORK TABLES With Undershef



MSLAG-X Series
Flat Top



KMSLAG-X Series
5" Backsplash



Item #: _____ **Qty #:** _____
Model #: _____
Project #: _____

FEATURES:

MSLAG: Top is furnished with 1 5/8" square bend on sides and 1 5/8" sanitary rolled rim on front and rear & square sides.

KMSLAG: Top is furnished with 1 5/8" square bend on sides and 1 5/8" sanitary rolled rim on front with 5" Rear Splash.

Two hat-channels stud welded under tabletop to reinforce and maintain a level work surface.

Aluminum die cast "leg-to-shelf" clamp secures shelf to leg eliminating unsightly nuts and bolts. Undershef is fully adjustable.

CONSTRUCTION:

All TIG welded. Exposed weld areas polished to match adjacent surface.

Top is sound deadened.

Roll formed embossed galvanized hat channels are secured to top by means of structural adhesive and weld studs.

Gussets welded to support hat channels.

MATERIAL:

- TOP:** 16 gauge stainless steel type "304" series.
- SHELF:** 18 gauge stainless steel.
- LEGS:** 1 5/8" diameter tubular Stainless steel.
Stainless steel gussets. 1" adjustable stainless steel bullet feet.



Stainless Steel Bullet Feet standard on Series

| MSLAG SERIES | | | |
|--------------|------|----------------------|----------|
| W | L | Flat Top w/Undershef | WT. |
| 24" | 24" | MSLAG-242-X | 47 lbs. |
| | 30" | MSLAG-240-X | 54 lbs. |
| | 36" | MSLAG-243-X | 59 lbs. |
| | 48" | MSLAG-244-X | 68 lbs. |
| | 60" | MSLAG-245-X | 83 lbs. |
| | 72" | MSLAG-246-X | 97 lbs. |
| | 84" | MSLAG-247-X | 115 lbs. |
| | *96" | MSLAG-248-X | 129 lbs. |
| 30" | 24" | MSLAG-302-X | 50 lbs. |
| | 30" | MSLAG-300-X | 56 lbs. |
| | 36" | MSLAG-303-X | 63 lbs. |
| | 48" | MSLAG-304-X | 82 lbs. |
| | 60" | MSLAG-305-X | 101 lbs. |
| | 72" | MSLAG-306-X | 111 lbs. |
| | 84" | MSLAG-307-X | 124 lbs. |
| | *96" | MSLAG-308-X | 147 lbs. |

| KMSLAG SERIES | | | |
|---------------|------|----------------------------|----------|
| W | L | 5" Rear Splash w/Undershef | WT. |
| 24" | 24" | KMSLAG-242-X | 49 lbs. |
| | 30" | KMSLAG-240-X | 56 lbs. |
| | 36" | KMSLAG-243-X | 63 lbs. |
| | 48" | KMSLAG-244-X | 77 lbs. |
| | 60" | KMSLAG-245-X | 88 lbs. |
| | 72" | KMSLAG-246-X | 105 lbs. |
| | 84" | KMSLAG-247-X | 122 lbs. |
| | *96" | KMSLAG-248-X | 140 lbs. |
| 30" | 24" | KMSLAG-302-X | 54 lbs. |
| | 30" | KMSLAG-300-X | 62 lbs. |
| | 36" | KMSLAG-303-X | 69 lbs. |
| | 48" | KMSLAG-304-X | 86 lbs. |
| | 60" | KMSLAG-305-X | 107 lbs. |
| | 72" | KMSLAG-306-X | 123 lbs. |
| | 84" | KMSLAG-307-X | 139 lbs. |
| | *96" | KMSLAG-308-X | 160 lbs. |

*All 8 ft. Tables Provided With 6 Legs



Customer Service Available To Assist You **1-800-645-3166** 8:30 am - 8:00 pm E.S.T.

Email Orders To: customer@advancetabco.com. For Smart Fabrication™ Quotes, Email To: smartfab@advancetabco.com or Fax To: 631-586-2933

NEW YORK
Fax: (631) 242-6900

GEORGIA
Fax: (770) 775-5625

TEXAS
Fax: (972) 932-4795

NEVADA
Fax: (775) 972-1578

DETAILS and SPECIFICATIONS

TOL \pm .500"

ALL DIMENSIONS ARE TYPICAL

MSLAG-X SERIES

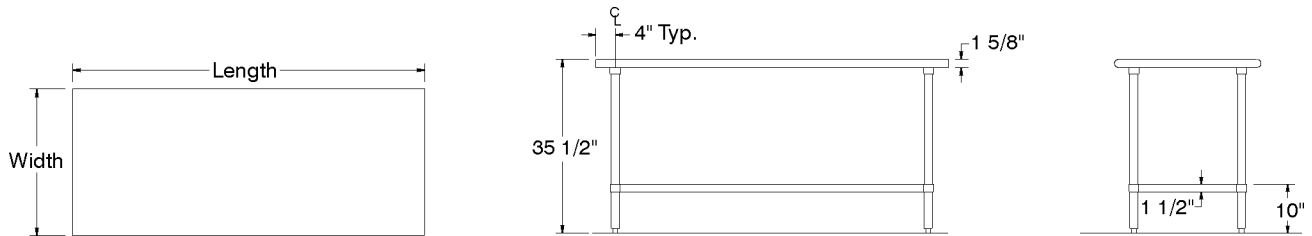

KMSLAG-X SERIES

