



# HIGH VOLUME PORTABLE BAR WITH STAINLESS STEEL WORK AREA (TOP, BACK & SIDES)



Item #:	_____	Qty #:	_____
Model #:	_____		
Project #:	_____		

**Designed For Heavy-Duty Use. Perfect for High Volume or Dual Operation!**

**Custom Colors Available!  
(Exterior Only. See below for details)**

**FEATURES:**

Corrugated Stainless Steel Work Top, Back and Sides  
Two 19" x 13-1/2" x 11" insulated ice bin. Complete with drain & shut-off valve

**R-8-7 MODEL:**

Two 19" x 13-1/2" x 11" insulated ice bin with 7 Circuit Post Mix Cold Plate. Includes Stainless Steel bottom, complete with drain & shut-off valve

**NOTE:** Ice Bins are located at each end. If a cold plate unit is required, it will be installed in the right ice bin

- Dual speed rails to hold up to 10 bottles of liquor
- Two Towel Rings
- Open bottom shelf for glass rack storage
- 4 - 6" Heavy Duty Swivel Casters, 2 with brakes

**MATERIAL:**

**CONSTRUCTION:** Mica Laminate, black finish  
Stainless steel bottom

**WORK AREA:** Stainless Steel top, back and sides

**CASTERS:** Rubber

**SPEED RAILS:** Stainless Steel

Model #	Size L x W x H	Bar Top Width	Cubic Feet	Weight
R-8-B	95.75" x 24.5" x 47"	12"	117	700
R-8-B-7	95.75" x 24.5" x 47"	12"	117	750

**Available Accessories**

- Upgrade to Stainless Steel Speed Rails (Set of 2) - **Model BK-2**
- Upgrade to Double Tier Stainless Steel Speed Rails (Set of 2) - **Model DT-2**
- Three Sided Continuous Bumper - **Model A-73**
- Custom Mica Colors - **Model A-74**  
(Custom colors include exterior finishes only (Bar front and sides. Additional charge for bar top.  
All interiors are standard black finish)



**Customer Service Available To Assist You 1-800-645-3166 8:30 am - 8:00 pm E.S.T.**

For Orders & Customer Service:  
Email: customer@advancetabco.com or Fax: 631-242-6900

For Smart Fabrication™ Quotes:  
Email: smartfab@advancetabco.com or Fax: 631-586-2933

# DIMENSIONS and SPECIFICATIONS

TOL ± .125"

ALL DIMENSIONS ARE TYPICAL

## R-8-B SERIES

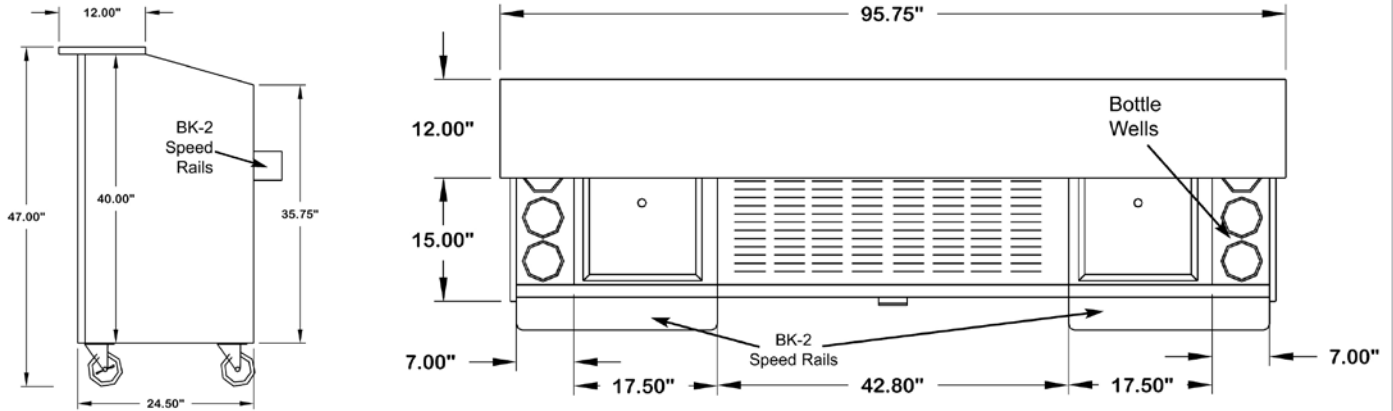

## R-8-B-7 SERIES WITH 7 CIRCUIT COLD PLATE

