



Redefining Healthcare Food Service

Reflection Series

Solid Top Station

Model Numbers:

**AEST2, AEST3, AEST4, AEST5,
AEST6**

With Alluserv you are not just buying a product. You are receiving our team's service commitment to get the most value from your investment in our products. We will provide you with:

- A team of knowledgeable experts with over 100 years of combined experience to help you understand and receive the most from your product throughout its service life
- Detailed instructions and specification on cleaning and application to best maintain your equipment
- A national service network and service manuals for our extensive product offering.



SOLID TOP STATION

APPLICATION

The Reflection Series counters can support any tray line layout. The solid top stand station is applicable for many different uses. Whatever your needs are Alluserv can help furnish them.

CONSTRUCTION

The solid top stand is constructed with a heavy duty gauge stainless steel top with square turn down on all sides as standard, as well as a stainless steel under shelf. The unit will be equipped with 1-5/8" stainless steel legs.

CASTERS

The unit is mounted on adjustable feet as standard. 5" heavy duty swivel casters, two fitted with brakes are available as options.

Options

- Work shelf
- Duplex outlet
- Overhead shelf
- Casters
- 3-bar tray slide
- Full service guard

Warranty

- Two years parts and one year labor

Reflection Series

Solid Top Station



SIZE	LENGTH
2 WELL	38"
3 WELL	52"
4 WELL	66"
5 WELL	80"
6 WELL	94"

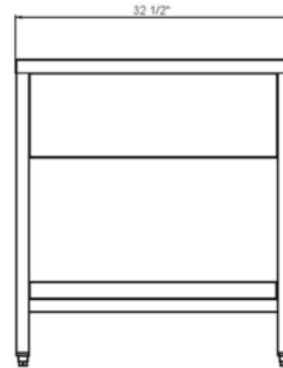
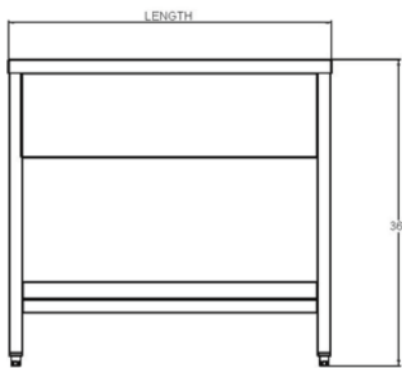

DIMENSIONS

MODEL	OVERALL SIZE			CASE WEIGHT LBS
	D	L	H	
AEST2	32-1/2"	38"	36"	145
AEST3	32-1/2"	52"	36"	190
AEST4	32-1/2"	66"	36"	235
AEST5	32-1/2"	80"	36"	280
AEST^	32-1/2"	94"	36"	325



901 West 14th Street | Suite 200 | Washington, MO | 63090 | toll free 888-892-2213 | fax 636-239-8435 | alluserv.com