



# BLUE AIR Commercial Refrigeration Inc.

[ D-Series ]

## Reach-In Solid Swing Door Refrigerator

### BSR23T



#### WARRANTY

- 18 Months Parts and Labor, 5 Years on Compressor in USA



Conforms to NSF/ANSI 7(ETL)

223 W. Rosecrans Ave. Gardena, CA. 90248 USA

Tel : 1.866.677.8500 / 310.808.0102  
Fax : 310.808.0242 / 310.808.0262



# BLUE AIR Commercial Refrigeration Inc.

## BSR23T Top Mount Reach-In Solid Swing Door Refrigerator

D-Series

### Product Specification

| MODEL NAME                 | BSR23T                  |
|----------------------------|-------------------------|
| Product Description        | Refrigerator            |
| Capacity(Cu.ft.)           | 23                      |
| Exterior Dimensions(WxDxH) | 26 3/4" x 31" x 82 3/8" |
| Net Weight(lbs)            | 233 lbs                 |
| Foot                       | Caster 4                |
| Door Type                  | 1 Door (Swing)          |
| Door Stopper               | Equipped (105°)         |
| Shelves                    | 4 ea                    |
| Input                      | AC 115V / 60Hz          |
| Amps                       | 5A                      |
| Compressor(Hp)             | 1/3 HP                  |
| Refrigerant                | R-134a                  |
| Range of Temperature       | 28~39 °F                |
| Easy to Service            | Sliding Condensing Unit |

\* BLUE AIR has the right to change specifications without further notice.

- 5" Diameter Swivel Casters with front brakes
- Door open Warning Alarm
- Durable Usage door Gasket
- Elegant Round Corners
- Conforms to NSF/ANSI 7(ETL)

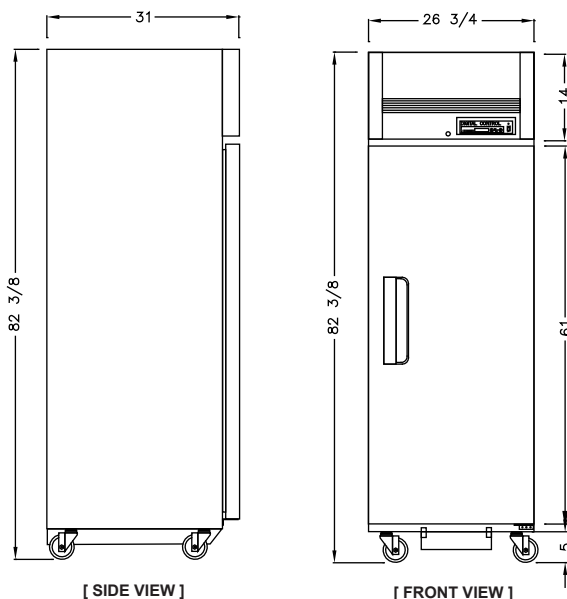

- Top Mounted Refrigeration System.
- Stainless Steel Interior and Exterior.  
The excellent quality of stainless steel helps minimize dents, scratches, and rust. In addition, our stainless steel offers long-life durability and easy maintenance.
- Defrost Water Evaporation fan system
- Digital Temperature controller  
Easy to operate & Perform problem shooting.
- Self-Closing & Stay Open Door.
- Recessed Handles.  
Our patented smooth and elegant door handles prevent shipping damage and handle breakage.
- High Density Cell Polyurethane Insulation (CFC free).  
CFC free and high density cell foam is used to ensure environment-friendliness and greater energy efficiency.
- Round Corner
- Door Locks - each door is equipped with individual locks
- Field Door Reversible (Left Hinge)
- Air Guard - Enable to ensure proper air flow and cooling
- In Candescent light interior

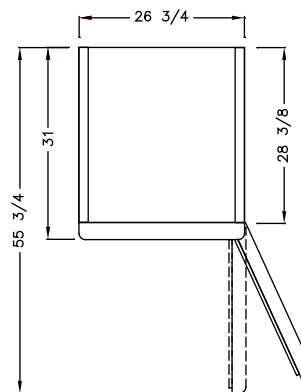

### WARRANTY

- 18 Months Parts and Labor, 5 Years on Compressor in USA



BLUE AIR Commercial Refrigeration Inc.

223 W. Rosecrans Ave.  
Gardena, CA. 90248 USA

Tel : 1.866.677.8500 / 310.808.0102  
Fax : 310.808.0242 / 310.808.0262

<http://www.Blueairinc.com>  
Email : [info@blueairinc.com](mailto:info@blueairinc.com)