

STANDARD FEATURES

- ◆ ½ hp motor(s)
- ◆ Factory installed fan/speed/heat switch
- ◆ Galvanized steel fan wheels & housings
- ◆ Aluminum airfoil shaped directional vanes
- ◆ Aluminum base frame
- ◆ White aluminum or stainless steel housing
- ◆ Keyhole slots in backplate for quick wall mounting
- ◆ UL Listed (United States & Canada)
- ◆ Two year parts warranty
- ◆ Crafted with Pride in the USA

HEATER FEATURES

- ◆ Helical coil with point suspension of elements for longer life
- ◆ Available single or three phase
- ◆ Easily replaceable heater elements
- ◆ Galvanized steel frame
- ◆ Thermally protected against overheating

OPTIONAL FEATURES

- ◆ Reduced kW available (consult factory)

| MODEL WHITE ALUMINUM | MODEL STAINLESS STEEL | Nozzle Width (in) | Max. Vel. (fpm) | Avg. Outlet Velocity (fpm) | Air Volume (scfm) | # Motor(s) @ hp | Power Rating (kW) | Outlet Velocity Unif. (%) | # Fans | Electric Capacity (kW) | Temp Rise °F | Net Wgt. (lbs) | Ship Wgt. (lbs) |
|----------------------|-----------------------|-------------------|-----------------|----------------------------|-------------------|-----------------|-------------------|---------------------------|--------|------------------------|--------------|----------------|-----------------|
| ASR1036E-3X | ASR1036E-3X-SS | 36" | 3500 | 1965 | 1812 | 1 @ ½ | .68 | 79.6 | 2 | 10.0 | 18 | 52 | 71 |
| ASR1042E-3X | ASR1042E-3X-SS | 42" | 3500 | 1716 | 1752 | 1 @ ½ | .75 | 78.6 | 2 | 10.0 | 18 | 55 | 81 |
| ASR1048E-3X | ASR1048E-3X-SS | 48" | 3500 | 1504 | 1882 | 1 @ ½ | .73 | 54.6 | 2 | 10.0 | 18 | 56 | 83 |
| ASR1060E-3X | ASR1060E-3X-SS | 60" | 3500 | 1225 | 1817 | 1 @ ½ | .74 | 27.0 | 2 | 10.0 | 18 | 63 | 95 |
| ASR2060E-3X | ASR2060E-3X-SS | 60" | 3500 | 1805 | 2726 | 2 @ ½ | 1.18 | 74.0 | 3 | 15.0 | 18 | 96 | 121 |
| ASR2072E-3X | ASR2072E-3X-SS | 72" | 3500 | 1965 | 3624 | 2 @ ½ | 1.36 | 71.9 | 4 | 20.0 | 18 | 100 | 140 |

| ELECTRIC HEATER DATA | | | | | | | |
|----------------------|-----------------|----------------|-----------------|-----------------|---------|---------|-------------------------------|
| ALUMINUM | STAINLESS STEEL | 208/240/1* | 208/3 | 240/3 | 480/3 | 600/3** | Temp. Rise °F @ kW |
| ASR1036E-3X | ASR1036E-3X-SS | 7.5 or 10.0 kW | 7.5 or 10.0 kW | 7.5 or 10.0 kW | 10.0 kW | 10.0 kW | 14° @ 7.5 kW / 18° @ 10.0 kW |
| ASR1042E-3X | ASR1042E-3X-SS | 7.5 or 10.0 kW | 7.5 or 10.0 kW | 7.5 or 10.0 kW | 10.0 kW | 10.0 kW | 14° @ 7.5 kW / 18° @ 10.0 kW |
| ASR1048E-3X | ASR1048E-3X-SS | 7.5 or 10.0 kW | 7.5 or 10.0 kW | 7.5 or 10.0 kW | 10.0 kW | 10.0 kW | 14° @ 7.5 kW / 18° @ 10.0 kW |
| ASR1060E-3X | ASR1060E-3X-SS | 7.5 or 10.0 kW | 7.5 or 10.0 kW | 7.5 or 10.0 kW | 10.0 kW | 10.0 kW | 14° @ 7.5 kW / 18° @ 10.0 kW |
| ASR2060E-3X | ASR2060E-3X-SS | N/A | 15.0 kW | 15.0 kW | 15.0 kW | 15.0 kW | 18° @ 15.0 kW |
| ASR2072E-3X | ASR2072E-3X-SS | N/A | 15.0 or 20.0 kW | 15.0 or 20.0 kW | 20.0 kW | 20.0 kW | 14° @ 15.0 kW / 18° @ 20.0 kW |

*Two circuits are required when combined amp draw of motor(s) and heater(s) is greater than 48 amps.

**A separate 120/208 or 240/1 circuit required for the motor.

| MOTOR VOLTAGES/AMP DRAWS | | |
|--------------------------|-------|---------|
| Horsepower | 1/2 | 1/2 |
| Speed | 3 | 3 |
| Volts | 120 | 208/240 |
| Phase | 1 | 1 |
| Hertz** | 50/60 | 50/60 |
| Amps per Motor | 7.2 | 4.0 |

**Operation at 50 HZ will generate approximately a 17% reduction in performance.

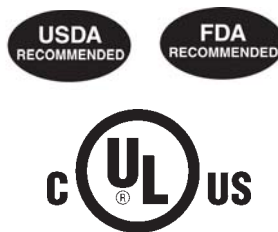

| | HEATER AMP DRAWS @ kW | | | | | |
|---------|-----------------------|-------|-------|-------|-------|-------|
| | 208/1 | 240/1 | 208/3 | 240/3 | 480/3 | 600/3 |
| 10.0 kW | 48.0* | 41.7 | 27.8 | 24.1 | 12.0 | 10 |
| 15.0 kW | N/A | 62.5* | 41.6 | 36.1 | 18.0 | 15.1 |
| 20.0 kW | N/A | 83.3* | 55.1* | 48.1* | 24.1 | 20.1 |

*total heater amp draw; two circuits required

Sound level measured 10' (3m) from the unit in free field:
ASR-E **67 dBA**

Berner reserves the right to alter specifications without prior notice.

TOP VIEW

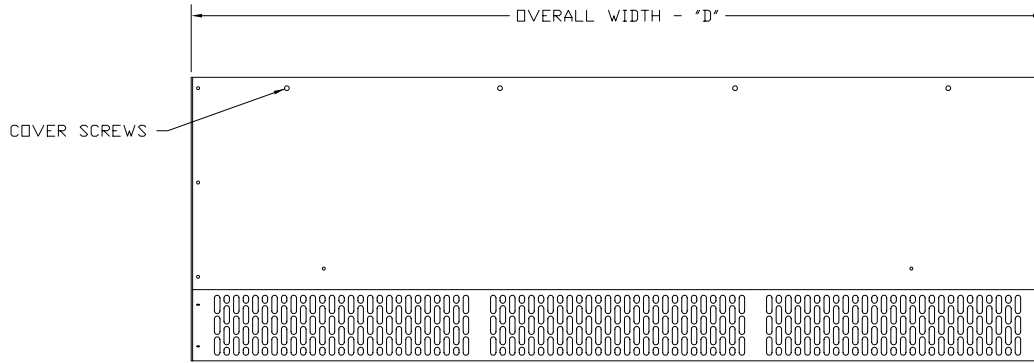

THE ARISTOCRAT

AIR DOOR ELECTRIC HEATED SINGLE & THREE SPEED

NOTES:

- ⚠ AIR CURTAIN MUST BE INSTALLED SO AIR STREAM IS NOT OBSTRUCTED WHEN DEFLECTED 20° TO EITHER SIDE OF C.
- ⚠ ELECTRICAL CONNECTIONS ARE TO BE FLEXIBLE.
- ⚠ FIELD VERIFY DIMENSIONS.
- ⚠ ANCHORS TO SUPPORTING STRUCTURE TO BE SUPPLIED BY OTHERS.
- ⚠ ADEQUACY OF SUPPORTING STRUCTURE IS TO BE VERIFIED BY A PROFESSIONAL STRUCTURAL ENGINEER.

FRONT VIEW

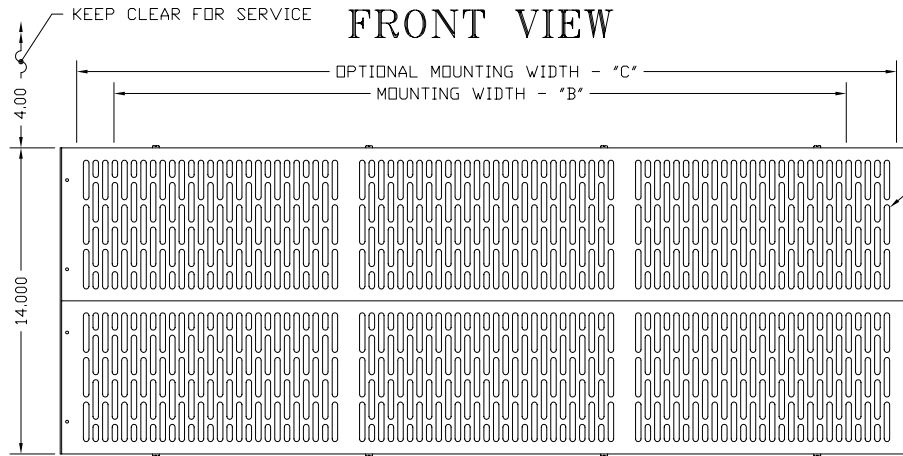

END VIEW

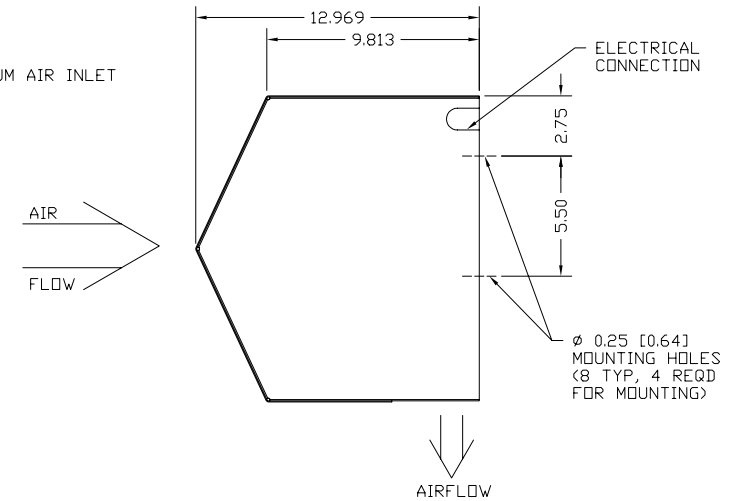

BOTTOM VIEW

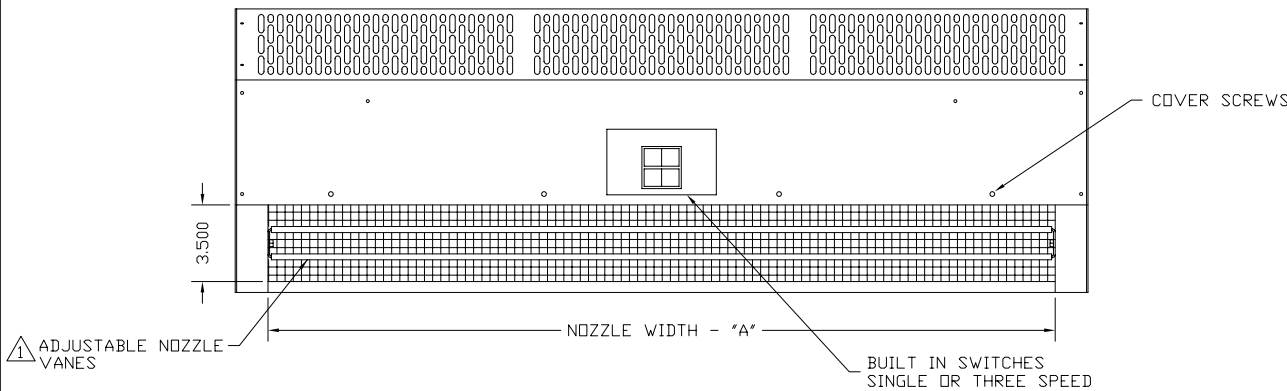

| MODEL | NOZZLE "A" | MOUNTING "B" | MOUNTING "C" | OVERALL "D" |
|-----------|----------------|----------------|----------------|----------------|
| AS*1036E† | 36.00 [91.44] | 33.50 [85.09] | 37.50 [95.25] | 39.00 [99.06] |
| AS*1042E† | 42.00 [106.68] | 39.50 [100.33] | 43.50 [110.49] | 45.00 [114.30] |
| AS*1048E† | 48.00 [121.92] | 45.50 [115.57] | 49.50 [125.73] | 51.00 [129.54] |
| ASF1060E | 60.00 [152.40] | 57.50 [146.05] | 61.50 [156.21] | 63.00 [160.02] |
| ASF1072E | 72.00 [182.88] | 69.50 [176.53] | 73.50 [186.69] | 75.00 [190.50] |

REPLACE "*" WITH "F" OR "R" FOR FRONT OR REAR DOOR (SINGLE SPEED ONLY). REPLACE "†" WITH "-3X" FOR 3-SPD (REAR DOOR ONLY)

| | | | |
|----------|-------------|--------|---|
| DWG. NO. | LWAT0067 | TITLE: | BERNER |
| DATE | 11OCT05 | | MODEL ARISTOCRAT AIR DOOR |
| BY | A. Johnston | | SINGLE SPEED & 3-SPEED ELECTRIC HEATED |
| REPLACES | | | |
| BY | | | BERNER INTERNATIONAL CORP. NEW CASTLE, PA. |