

REACH-IN FREEZER

Product Specifications

3F - Three Section Freezer with Solid Doors

Self-Contained

Stainless steel front, aluminum end panels and interior.



OPTIONS AND ACCESSORIES

- | | |
|---|--|
| • Stainless steel case back | • Adjustable Legs |
| • Pan slide assemblies | • Half doors |
| • Increased refrigeration systems | • Pass-Thru |
| • Stainless steel shelves | • Remote models |
| • Digital thermometer | • Shallow-Depth |
| • Rehinging of doors (<i>consult factory</i>) | • Hinged glass doors |
| • Expansion valve system | • Special electrical requirements (<i>consult factory</i>) |

Consult factory for other model configurations, options and accessories.

DIMENSIONAL DATA

Net Capacity (cu. ft.)	70 (1982 cu l)
Width, Overall (in.)	78 (1981 mm)
Depth, Overall (incl. handles) (in.)	35 ³ / ₈ (899 mm)
Depth [less doors] (in.)	32 (813 mm)
Depth [doors open 90°] (in.)	55 ¹ / ₂ (1410 mm)
Clear Door Width (in.)	19 ³ / ₈ (492 mm)
Clear Door Height (in.)	58 ⁵ / ₈ (1489 mm)
Height, Overall (incl. 5" casters) (in.)	82 ¹ / ₄ (2089 mm)
No. of Doors	3
No. of Shelves	9
Shelf Area (sq. ft.)	61.2 (5.7 sq m)
Tray Slide Capacity (per section)	16 ea.

REFRIGERANT DATA

Condensing Unit Size (H.P.)	3/4
Capacity (BTU/Hr)*	3575

ELECTRICAL DATA

Cabinet	115/208-230/60/1
Feed Wires (incl. ground)	4
Condensing Unit	208-230/60/1
Total Amps	11.9
Cabinet Amps	2.9
Defrost Amps	9.6
Power Cord Supplied	No

SHIPPING DATA

Height - Crated (in.)	85 ¹ / ₂ (2172 mm)
Width - Crated (in.)	90 (2286 mm)
Depth - Crated (in.)	42 (1067 mm)
Volume - crated (cu. ft.)	187 (5295 cu l)
Weight Standard - Crated (lbs.)	790 (358 kg)
Weight SS - Crated (lbs.)	905 (411 kg)
Weight Standard - Uncrated (lbs.)	580 (263 kg)
Weight SS - Uncrated (lbs.)	695 (315 kg)

* Rating @ -15°F evaporator, 90°F ambient
Figures in parentheses reflect metric equivalents.

IMPORTANT NOTE: If the cabinet is located directly against a wall and/or under a low ceiling, a minimum clearance of 12" is required.

Project Name:

Model Specified:

Location:

Item No:

Quantity:

APPROVAL:

Continental
Refrigerator

Toll-Free: 800-523-7138
Phone: 215-244-1400
Fax: 215-244-9579

539 Dunksferry Road
Bensalem, PA 19020
www.continentalrefrigerator.com

Standard Design Features

REFRIGERATION SYSTEM

Environmentally-safe R-404A refrigerant

CABINET ARCHITECTURE

3" non-CFC polyurethane foam insulation

Chrome-plated flow line handles

Cam action, lift off hinges

Self-closing doors

Magnetic snap-in door gasket

Cylinder lock in each door

5" casters

Heavy-duty epoxy-coated steel shelves

MODEL FEATURES

Automatic interior lighting

External dial thermometer

Automatic, energy-saving, electric condensate evaporator

Automatic electric defrost

Energy saving switch for door heaters

STANDARD

Stainless steel front, aluminum end panels and interior

SUFFIX SA

Stainless steel exterior, aluminum interior

SUFFIX SS

Stainless steel exterior and interior

REACH-IN FREEZER

3F - Three Section Freezer with Solid Doors

Self-Contained

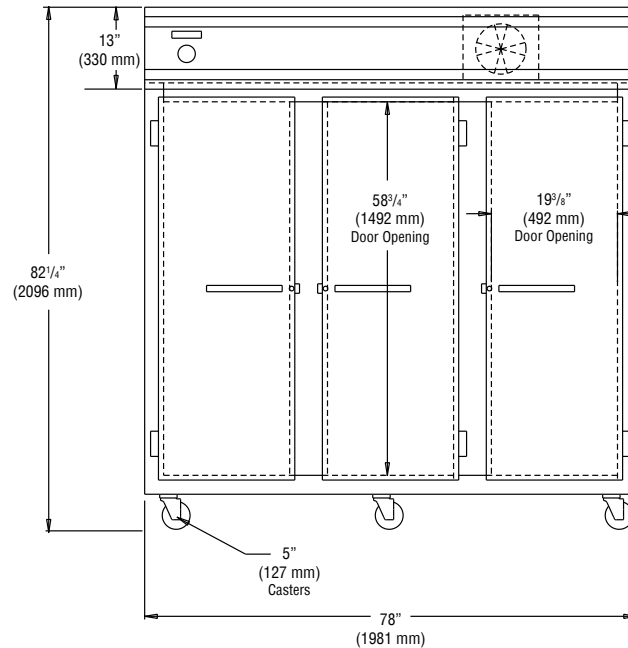

FRONT VIEW

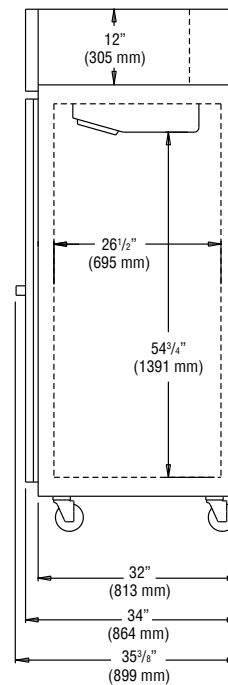

SIDE VIEW

Continental
Refrigerator

Toll-Free: 800-523-7138
Phone: 215-244-1400
Fax: 215-244-9579

539 Dunkserry Road
Bensalem, PA 19020
www.continentalrefrigerator.com

Due to our continued efforts in developing innovative products, specifications subject to change without notice.



MADE IN THE U.S.A.

© Copyright 2013, Continental Refrigerator.
A Division of National Refrigeration & Air Conditioning Products, Inc.