

# Continental

## Refrigerator

Project Name: \_\_\_\_\_  
 Model Specified: \_\_\_\_\_  
 Location: \_\_\_\_\_  
 Item No. \_\_\_\_\_ Quantity: \_\_\_\_\_

### Display Back Bar Refrigerators

Models:  BBC50-GD  BBC59-GD  BBC69-GD  
 BBC79-GD  BBC90-GD

### Standard Features



Model BBC90-GD

- Available in 50", 59", 69", 79", 90" Widths
- Modern, State-of-the-Art Styling
- Performance Rated Refrigeration System Utilizing Environmentally Safe R-134a Refrigerant
- Front Breathing
- Wear Resistant Black Vinyl Coated Steel Exterior with 304 Series Stainless Steel Countertop
- Heavy-Duty, Long Lasting, Galvanized Steel Interior with Reinforced Stainless Steel Floor
- Stainless Steel Reinforced Threshold Sills for Ease of Loading
- Cylinder Keyed Security Lock and Magnetic Snap-In Gasket on Each Door
- Full Length, Extra Large, Non-Corrosive, Plasticized Fin Evaporator Coil Provides Uniform Air Flow Distribution to Maintain Constant Product Temperature and Quick Uniform Recovery
- Heavy Duty, Adjustable and Epoxy-Coated Steel Shelves
- Easily Accessible and Serviceable Slide-Out Condensing Unit
- Readily Removable Front, Rear and Side Venting Louvered Grills Allow Greater Condenser Air Flow for Tight Fit Installations
- Fluorescent Interior Lighting
- Automatic, Energy Saving, Non-Electric Condensate Disposal
- High Density, Non-CFC Polyurethane Foamed-In-Place Insulation

### Options & Accessories

- |                                                                                      |                                                                                          |
|--------------------------------------------------------------------------------------|------------------------------------------------------------------------------------------|
| <input type="checkbox"/> 6" Adjustable Legs                                          | <input type="checkbox"/> Pass Thru                                                       |
| <input type="checkbox"/> Remote -R                                                   | <input type="checkbox"/> SS Models - Stainless Steel Exterior, Galvanized Steel Interior |
| <input type="checkbox"/> Additional Shelves                                          | <input type="checkbox"/> Electric Condensate                                             |
| <input type="checkbox"/> Stainless Steel Shelves                                     | <input type="checkbox"/> Heavy Duty Pilasters and Shelf Clips                            |
| <input type="checkbox"/> 4" Locking Casters                                          | <input type="checkbox"/> Condensing Unit on the Right                                    |
| <input type="checkbox"/> Stainless Steel Interior for NSF 7 - approved for open food |                                                                                          |
| <input type="checkbox"/> Shallow Depth                                               |                                                                                          |



Approval: \_\_\_\_\_



A Division of National Refrigeration & A/C Products, Inc.  
 539 Dunksferry Road Bensalem, PA 19020  
 (800) 523-7138 Fax: (215) 244-9579  
 www.continentalrefrigerator.com

Printed in U.S.A  
 March, 2009

Project Name: \_\_\_\_\_ Model Specified: \_\_\_\_\_  
 Location: \_\_\_\_\_ Item No. \_\_\_\_\_ Quantity: \_\_\_\_\_

**SPECIFICATIONS**

**DIMENSIONAL DATA**

	<b>Model BBC50-GD</b>	<b>Model BBC59-GD</b>	<b>Model BBC69-GD</b>	<b>Model BBC79-GD</b>	<b>Model BBC90-GD</b>
Net Capacity (cu. ft.)	16	22	26	28	35
Barrel Capacity (# of Barrel Type Kegs)	—	2	3	4	4
Straight Wall Capacity (# of Straight Wall Kegs)	2	3	3	4	5
Width, Overall (in.)	50	59	69	79	90
Depth, Overall, (in.) (incl. Hdls. & Bumpers)	28 <sup>5</sup> / <sub>8</sub>	28 <sup>5</sup> / <sub>8</sub>	28 <sup>5</sup> / <sub>8</sub>	28 <sup>5</sup> / <sub>8</sub>	28 <sup>5</sup> / <sub>8</sub>
Height, Overall (in.)	36 <sup>3</sup> / <sub>4</sub>	36 <sup>3</sup> / <sub>4</sub>	36 <sup>3</sup> / <sub>4</sub>	36 <sup>3</sup> / <sub>4</sub>	36 <sup>3</sup> / <sub>4</sub>
Number of Doors	2	2	2	3	3
Number of Shelves	4	4	4	6	6
Condensing Unit Size (H.P.)	1/3	1/3	1/3	1/2	1/2
Refrigerant	R-134a	R-134a	R-134a	R-134a	R-134a
Cabinet Electrical Specs	115/60/1	115/60/1	115/60/1	115/60/1	115/60/1
Total Amps	9.6	9.6	10.3	13	13
Power Supply Cord (10 ft.)	yes	yes	yes	yes	yes
Shipping Weight (lbs.)	355	385	415	455	505
Shipping Height (in.)	46	46	46	46	46
Shipping Length (in.)	58	65	78	109	109
Shipping Depth (in.)	42	42	42	42	42

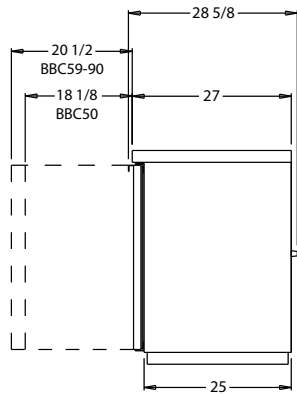

**BBC50,59,69,79 & 90  
SIDE VIEW**

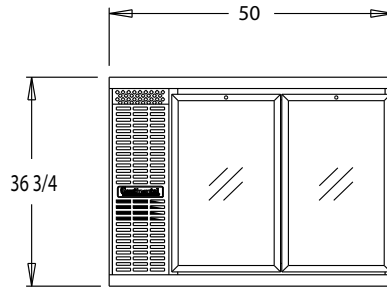

**BBC50-GD FRONT VIEW**

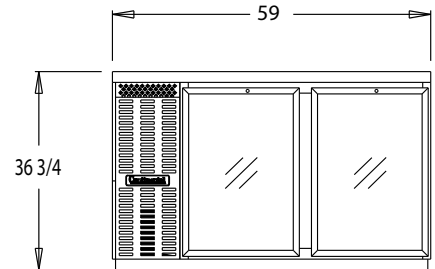

**BBC59-GD FRONT VIEW**

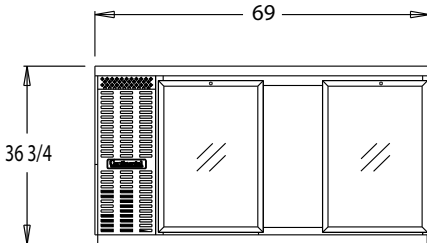

**BBC69-GD FRONT VIEW**

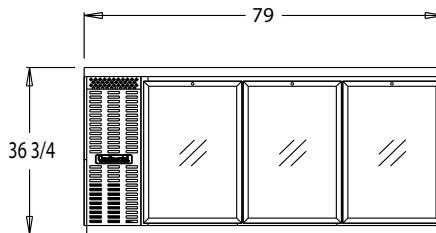

**BBC79-GD FRONT VIEW**

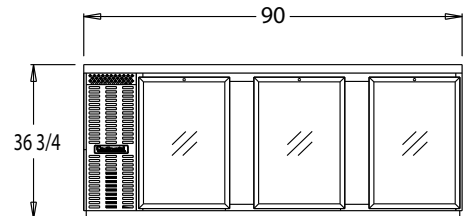

**BBC90-GD FRONT VIEW**