

PROJECT NAME: _____

LOCATION: _____

SPECIFIER ITEM NO. _____ **QTY:** _____

ENCORE PART NO. _____

Encore® Wall Mount Pot Sink Faucet with
 Straight Swing Spout and Cross Handles

KL34-801x Series

- KL34-8010 10" Straight swing spout
- KL34-8012 12" Straight swing spout
- KL34-8014 14" Straight swing spout
- KL34-8018 18" Straight swing spout

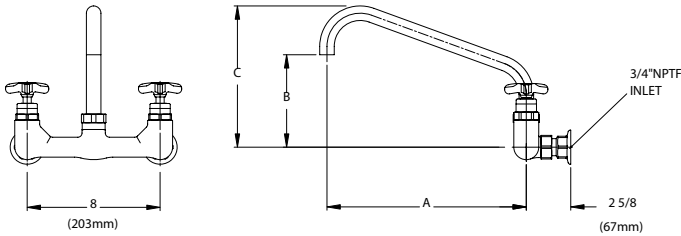

Dimensions shown in inches (mm) are for reference only
 and are subject to change.

3/4" NPT Female Inlets
 Operating Temperature: 40 - 180°F (5 - 83°C)
 Operating Pressure: 20 - 125psi

Approximate shipping weight - 9 lbs
 Warranty - 2 years parts

Solid heavy duty cast body is specification and commercial quality.

Commercial Quality Features

- Straight swing spout design
- Cross handle design
- Built-in check valves to prevent cross-flow and back-flow
- Leak proof double O-ring spout design
- 1" diameter spout offers unrestricted water flow for quick filling of pots and kettles

SANIGUARD® Product Protection

- Permanently incorporated on all touch points of Encore plumbing fixtures
- Inorganic, silver ion technology inhibits growth of common bacteria, yeasts, mold and fungi, minimizes cross-contamination

SPECIFICATIONS:

Wall Mount Kettle Faucet to be Encore KL34 Series in the following configuration:

- _____ KL34-8010 10" Straight Swing Spout
- _____ KL34-8012 12" Straight Swing Spout
- _____ KL34-8014 14" Straight Swing Spout
- _____ KL34-8018 18" Straight Swing Spout

Faucet body to be constructed of polished chrome plated brass with total lead content less than 0.25% by weighted average. Faucet to have 8" adjustable inlet centers. Handles to be cross and incorporated with SANIGUARD treatment. Color coded temperature indexes shall meet international standards. Valves to be 1/4-turn with integral check valve to prevent cross-flow and back-flow. Spout to be straight swing style with leak proof double O-ring seal design and full flow Quik-Fil™ 1" dia. opening for flow rate of 5.0gpm @ 60psi.

Model No.	A	B	C
KL34-8010	10" (254mm)	4-7/8" (124mm)	7-3/4" (197mm)
KL34-8012	12" (305mm)	5-5/8" (143mm)	8-1/2" (216mm)
KL34-8014	14" (355mm)	6-1/4" (158mm)	9-1/4" (235mm)
KL34-8018	18" (457mm)	7-7/8" (200mm)	10-7/8" (276mm)

COMPLIES WITH:
 THE FEDERAL "REDUCTION OF LEAD
 IN DRINKING WATER ACT" -
 2011 - US SENATE BILL NO. S.3874
 NSF/ANSI 61/9, ANNEX G

