

PROJECT NAME: _____
LOCATION: _____
SPECIFIER ITEM NO. _____ **QTY:** _____
ENCORE PART NO. _____

Encore® Deck Mount Pot Sink Faucet with Straight Swing Spout and Cross Handles

KL36-801x Series

- KL36-8010 10" Straight Swing Spout
- KL36-8012 12" Straight Swing Spout
- KL36-8018 18" Straight Swing Spout

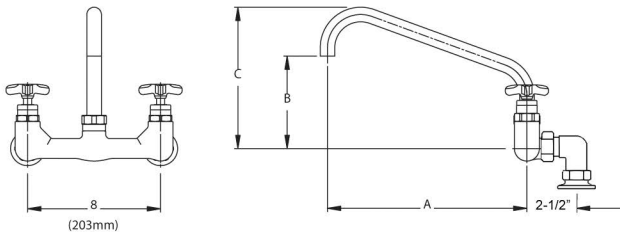

Dimensions shown in inches (mm) are for reference only and are subject to change.

3/4" NPT Female Inlets
 Operating Temperature: 40 - 180°F (5 - 83°C)
 Operating Pressure: 20 - 125psi

Approximate shipping weight - 9 lbs
 Warranty - 2 years parts

Solid heavy duty cast body is specification and commercial quality.

Commercial Quality Features

- Straight swing spout design
- Cross handle design
- Built-in check valves to prevent cross-flow and back-flow
- Leak proof double O-ring spout design
- 1" diameter spout offers unrestricted water flow for quick filling of pots and kettles

SANIGUARD® Product Protection

- Permanently incorporated on all touch points of Encore plumbing fixtures
- Inorganic, silver ion technology inhibits growth of common bacteria, yeasts, mold and fungi, minimizes cross-contamination

SPECIFICATIONS:

Deck Mount Kettle Faucet to be Encore KL36 Series in the following configuration:

- _____ KL36-8010 10" Straight Swing Spout
- _____ KL36-8012 12" Straight Swing Spout
- _____ KL36-8018 18" Straight Swing Spout

Faucet body to be constructed of polished chrome plated brass with total lead content less than 0.25% by weighted average. Faucet to have 8" adjustable inlet centers. Handles to be cross and incorporated with SANIGUARD treatment. Color coded temperature indexes shall meet international standards. Valves to be 1/4-turn with integral check valve to prevent cross-flow and back-flow. Spout to be straight swing style with leak proof double O-ring seal design and full flow Quik-Fil™ 1" dia. opening for flow rate of 5.0gpm @ 60psi.

Model No.	A	B	C
KL36-8010	10" (254mm)	4-1/2" (114mm)	8-1/4" (210mm)
KL36-8012	12" (305mm)	5-5/8" (143mm)	9-1/4" (235mm)
KL36-8018	18" (457mm)	7-7/8" (200mm)	10-7/8" (276mm)



COMPLIES WITH:
 ASME A112.18.1-2005
 CSA B125.1-05
 NSF/ANSI 61/9, ANNEX G
 SECTION 116875 OF THE
 CALIFORNIA HEALTH & SAFETY CODE
 (COMMONLY KNOWN AS AB1953)
 VERMONT ACT 193
 UNIFORM PLUMBING CODE

