

PROJECT NAME: _____

LOCATION: _____

SPECIFIER ITEM NO. _____ **QTY:** _____

ENCORE PART NO. _____

Encore[®] Wall Mount Faucet with Rigid
Gooseneck Spout and 4" (102mm)
Wrist Blade Handles

KL54-1x0x-RE4 Series

- KL54-1100-RE4 3" Spout, Ceramic Valves
- KL54-1000-RE4 3" Spout, Compression Valves
- KL54-1102-RE4 6" Spout, Ceramic Valves
- KL54-1002-RE4 6" Spout, Compression Valves
- KL54-1101-RE4 8" Spout, Ceramic Valves
- KL54-1001-RE4 8" Spout, Compression Valves

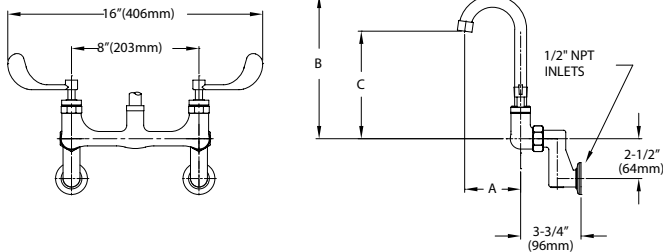

Dimensions shown in inches (mm) are for reference only and are subject to change.

1/2" NPSM Female Inlets
Operating Temperature: 40 - 180°F (5 - 83°C)
Operating Pressure: 15 - 125psi
1-1/8" (29mm) holes for backsplash are recommended to accommodate 1/2" supply nipples.

Approximate shipping weight -5 lbs
Warranty - 2 years parts

Solid heavy duty cast body is specification and commercial quality

Commercial Quality Features

- Rigid gooseneck spout design
- ADA-compliant 4" (102mm) wrist blade handles
- Built-in check valve to prevent cross-flow and back-flow
- Stainless steel spout

SANIGUARD[®] Product Protection

- Permanently incorporated on all touch points of Encore plumbing fixtures
- Inorganic, silver ion technology inhibits growth of common bacteria, yeasts, mold and fungi, minimizes cross-contamination

SPECIFICATIONS:

Wall Mount Faucet to be Encore KL54 Series in the following configuration:

- _____ KL54-1100-RE4 3" Spout, Ceramic Valves
- _____ KL54-1000-RE4 3" Spout, Compression Valves
- _____ KL54-1102-RE4 6" Spout, Ceramic Valves
- _____ KL54-1002-RE4 6" Spout, Compression Valves
- _____ KL54-1101-RE4 8" Spout, Ceramic Valves
- _____ KL54-1001-RE4 8" Spout, Compression Valves

Faucet body to be constructed of polished chrome plated brass with total lead content less than 0.25% by weighted average. 4" wrist blade handles to be incorporated with SANIGUARD treatment. Valves to be 1/4-turn with integral check valve to prevent cross-flow and back-flow. Spout to be stainless steel rigid gooseneck style. Color coded temperature indexes shall meet international standards. 2.2gpm aerator @ 60psi standard with full flow stream bubbler screen spout tip.

Model No.	A	B	C
KL54-1100-RE4	3-1/2" (89mm)	9" (229mm)	6-3/8" (160mm)
KL54-1000-RE4	3-1/2" (89mm)	9" (229mm)	6-3/8" (160mm)
KL54-1102-RE4	6" (152mm)	10-1/4" (260mm)	6-1/4" (160mm)
KL54-1002-RE4	6" (152mm)	10-1/4" (260mm)	6-1/4" (160mm)
KL54-1101-RE4	8-1/2" (216mm)	12-3/4" (324mm)	7" (178mm)
KL54-1001-RE4	8-1/2" (216mm)	12-3/4" (324mm)	7" (178mm)

COMPLIES WITH:
THE FEDERAL "REDUCTION OF LEAD
IN DRINKING WATER ACT" -
2011 - US SENATE BILL NO. S.3874
NSF/ANSI 61/9, ANNEX G

