

**PROJECT NAME:** \_\_\_\_\_

**LOCATION:** \_\_\_\_\_

**SPECIFIER ITEM NO.** \_\_\_\_\_ **QTY:** \_\_\_\_\_

**ENCORE PART NO.** \_\_\_\_\_

Encore<sup>®</sup> Wall Mount Faucet with  
Tubular Swing Spout and Lever Handles

**KL54-8xxx-SE1 Series**

- KL54-8106-SE1 6" Spout, Ceramic Valves
- KL54-8006-SE1 6" Spout, Compression Valves
- KL54-8108-SE1 8" Spout, Ceramic Valves
- KL54-8008-SE1 8" Spout, Compression Valves
- KL54-8110-SE1 10" Spout, Ceramic Valves
- KL54-8010-SE1 10" Spout, Compression Valves
- KL54-8112-SE1 12" Spout, Ceramic Valves
- KL54-8012-SE1 12" Spout, Compression Valves
- KL54-8114-SE1 14" Spout, Ceramic Valves
- KL54-8014-SE1 14" Spout, Compression Valves
- KL54-8116-SE1 16" Spout, Ceramic Valves
- KL54-8016-SE1 16" Spout, Compression Valves

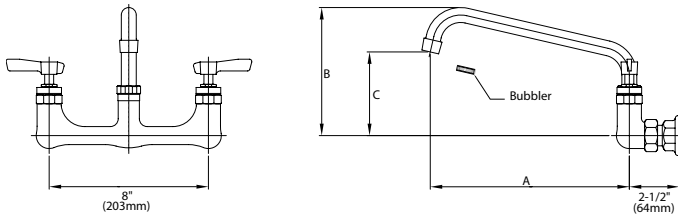

Dimensions shown in inches (mm) are for reference only and are subject to change.

1-1/2" (29mm) hole for backsplash is recommended to accommodate 1/2" supply nipples.

1/2" NPT Female Inlets

Operating Temperature: 40 - 180°F (5 - 83°C)

Operating Pressure: 15 - 125psi

Approximate shipping weight - 5 lbs  
Warranty - 2 years parts

Solid heavy duty cast body is specification and commercial quality

**Commercial Quality Features**

- Tubular swing spout design
- ADA-compliant lever handles
- Built-in check valve to prevent cross-flow and back-flow
- Leak proof double O-ring spout design
- Stainless steel spout

**SANIGUARD<sup>®</sup> Product Protection**

- Permanently incorporated on all touch points of Encore plumbing fixtures
- Inorganic, silver ion technology inhibits growth of common bacteria, yeasts, mold and fungi, minimizes cross-contamination

**SPECIFICATIONS:**

Wall Mount Faucet to be Encore KL54 Series in the following configuration:

- \_\_\_\_\_ KL54-8106-SE1 6" Spout, Ceramic Valves
- \_\_\_\_\_ KL54-8006-SE1 6" Spout, Compression Valves
- \_\_\_\_\_ KL54-8108-SE1 8" Spout, Ceramic Valves
- \_\_\_\_\_ KL54-8008-SE1 8" Spout, Compression Valves
- \_\_\_\_\_ KL54-8110-SE1 10" Spout, Ceramic Valves
- \_\_\_\_\_ KL54-8010-SE1 10" Spout, Compression Valves
- \_\_\_\_\_ KL54-8112-SE1 12" Spout, Ceramic Valves
- \_\_\_\_\_ KL54-8012-SE1 12" Spout, Compression Valves
- \_\_\_\_\_ KL54-8114-SE1 14" Spout, Ceramic Valves
- \_\_\_\_\_ KL54-8014-SE1 14" Spout, Compression Valves
- \_\_\_\_\_ KL54-8116-SE1 16" Spout, Ceramic Valves
- \_\_\_\_\_ KL54-8016-SE1 16" Spout, Compression Valves

Faucet body to be constructed of polished chrome plated brass with total lead content less than 0.25% by weighted average. Lever handles to be incorporated with SANIGUARD treatment. Valves to be 1/4-turn with integral check valve to prevent cross-flow and back-flow. Spout to be stainless steel tubular swing style with leak proof double O-ring seal design. Color coded temperature indexes shall meet international standards. 2.2gpm aerator @ 60psi standard with full flow stream bubbler screen spout tip.

Model No.	A	B	C
KL54-8106-SE1	6" (152mm)	5-9/16" (141mm)	3-5/16" (84mm)
KL54-8006-SE1	6" (152mm)	5-9/16" (141mm)	3-5/16" (84mm)
KL54-8108-SE1	8" (203mm)	6-1/16" (154mm)	3-13/16" (96mm)
KL54-8008-SE1	8" (203mm)	6-1/16" (154mm)	3-13/16" (96mm)
KL54-8110-SE1	10" (254mm)	6-1/2" (165mm)	4-1/4" (108mm)
KL54-8010-SE1	10" (254mm)	6-1/2" (165mm)	4-1/4" (108mm)
KL54-8112-SE1	12" (305mm)	6-15/16" (176mm)	4-11/16" (120mm)
KL54-8012-SE1	12" (305mm)	6-15/16" (176mm)	4-11/16" (120mm)
KL54-8114-SE1	14" (355mm)	7-7/16" (187mm)	5-3/16" (131mm)
KL54-8014-SE1	14" (355mm)	7-7/16" (187mm)	5-3/16" (131mm)
KL54-8116-SE1	16" (406mm)	7-7/8" (200mm)	5-5/8" (143mm)
KL54-8016-SE1	16" (406mm)	7-7/8" (200mm)	5-5/8" (143mm)

**COMPLIES WITH:**  
ASME A112.18.1-2005  
CSA B125.1-05  
NSF/ANSI 61/9, ANNEX G  
SECTION 116875 OF THE  
CALIFORNIA HEALTH & SAFETY CODE  
(COMMONLY KNOWN AS AB1953)  
VERMONT ACT 193  
UNIFORM PLUMBING CODE

