

CORRECTIONAL PROOF/HOT CABINET MODEL 126-PH-1836-CM

FEATURES AND BENEFITS:

- Non-insulated proof/hot cabinet operates as either a proofer for basic yeast doughs or a holding cabinet for hot foods.
- 2025 Watt heater holds foods at up to 180°F.; proofing with 1000 Watts allows for temperatures of 80° to 95°F., with relative humidity of 95%.
- Body constructed of non-corrosive, Hi-Tensile aluminum with extruded frame fully welded for strength.
- One piece, reinforced, full length door swings 270°. Heavy duty security hinges attached with tamper-proof fasteners.
- Extended slide latch with two lock hasps secures 80% of door for maximum security. Easy to read, through the door thermometer.
- Interlocking extruded sidewalls hold 18" x 26" pans and plastic food boxes on 1-1/2" centers. Reinforced with additional vertical extruded channels which are riveted and welded in place.
- Heavy duty extruded aluminum tie bar welded in place.
- Heavy duty 5" swivel casters, two with brakes. Provides mobility when fully loaded.

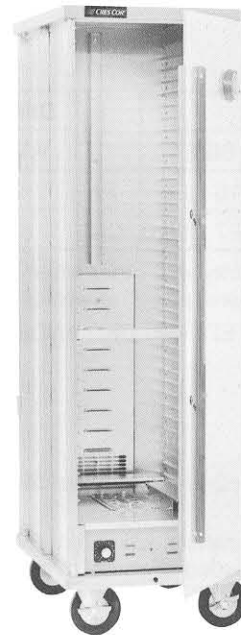

126-PH-1836-CM



ACCESSORIES and OPTIONS (Available at extra cost):

- Drip Trough
- Corner Bumpers
- Perimeter Bumper
- Push Handle
- Left-Hand Hinged Door
- Various Caster Options

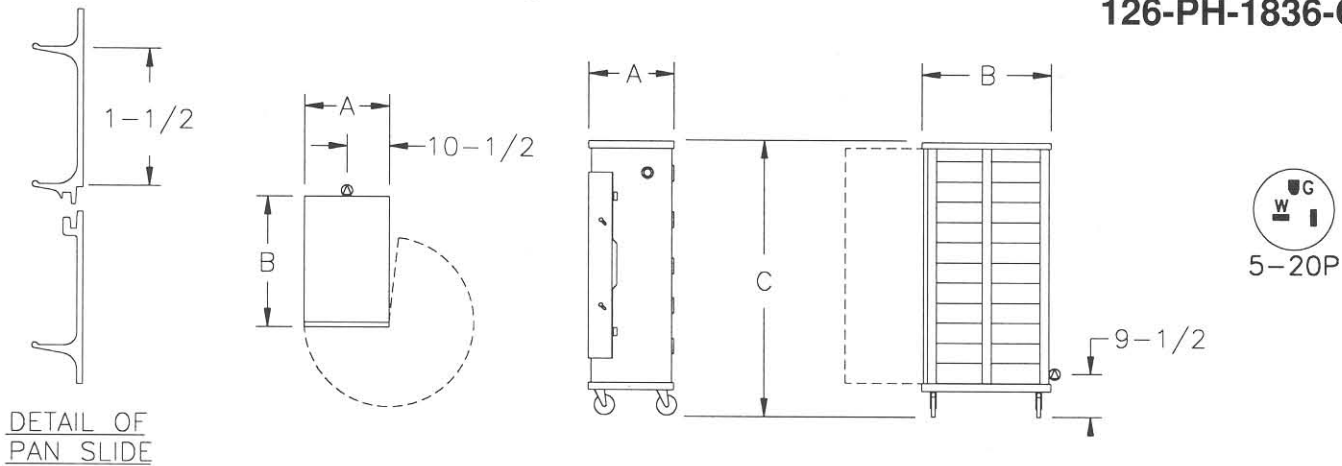

DETAIL OF PAN SLIDE

CRES-COR MODEL NO.	PAN			DIM "A"	DIM "B"	DIM "C"	INSIDE DIMENSIONS			WEIGHT ACT.	
	CAP	SIZE		WIDTH	DEPTH	HEIGHT	WIDTH	DEPTH	HEIGHT		
126-PH-1836-CM	34	18 x 26	IN	21	32-1/4	69-3/4	18-1/16	28-1/2	54-3/8	LBS	148
		45.7 x 66.0	CM	53.3	81.9	177.2	45.9	72.4	138.1	KG	67

NOTES: 1. Send sample pan or tray with order when using any that are not 18" x 26" pans with heavy beaded edges.
2. When ordering bumpers, add 2" to overall dimensions.

ALL CONSTRUCTION IS RIVETED, WELDED AND FINISHED.

CABINET:

- Top: One piece .100 aluminum.
- Posts: Extruded channels, 7/8 x 2-1/4 x .102, welded to top and base, form a solid frame.
- Sides: Interlocking extruded 6" panels, smooth outer sides reinforced with 1 x 2 x .125 extruded channel, riveted and welded in place.
- Back: .063 panel fitted into posts, riveted to top and reinforced.
- Tie bar: Welded in place.
- Air tunnel: .063 aluminum; mounted to hot unit.

BASE:

- One piece construction, .190 aluminum.
- Casters: 5" dia., swivel, neoprene tires, 1-1/4 wide, load cap. 200 lbs. each, temp. range -20°/+160°F. Bearings are sealed and permanently lubricated. Front casters equipped with brakes.

DOOR:

- Panel: .100 formed aluminum.
- Reinforcement: 3/8 x 1-1/2 extruded bars riveted horizontally to top, center and bottom.
- Latch: Gravity type, .125 aluminum with lock hasps (top and bottom).
- Swings 270° on 5 butt hinges, riveted to post and door panel.

PAN SLIDES:

- Extruded interlocking side walls act as pan slides on 1-1/2" centers.

PROOF/HOT UNIT COMPONENTS:

- Bottom mount proof/hot unit removable with tools.
- Body: Formed .063 aluminum.
- Thermostat (holding): Mechanical, room ambient to 180°F.
- Thermostat (humidity): Mechanical, room ambient to 95%.
- Pilot lights.
- Switch: Rocker type.
- Power cord: Permanent, 6 ft., 12/3 ga. with molded right angle plug.
- Heaters (2): (1) 1125 Watts and (1) 900 Watts for holding.
- Water pan: 3-1/2 quart; 18 ga. 304 stainless steel with 1000 Watt heater for humidity.

POWER REQUIREMENTS:

- 2025 Watts, 120 Volts, 60 Hz., single phase, 16.9 Amps., 20 Amp. service.



5925 Heisley Road • Mentor, OH 44060-1833
Phone: 877/CRESCOR • Fax: 440/350-7267
www.crescor.com

© Crescent Metal Products, Inc. 1998 All rights reserved.

In line with its policy to continually improve its products, CRES-COR reserves the right to change materials and specifications without notice.

Litho in U.S.A.