

## HEAVY-DUTY TRAY RETRIEVAL CART



DHOR12

### Item Numbers

- DHOR12UP
- DHOR20UP
- DHOR24UP

### Options

- DHOR12UCOVR
- DHOR12UCOVR2

### Application

From the kitchen to the patient, this Dinex® room service cart can meet your needs. It is light weight and is easy to maneuver. This cart can be enclosed with the optional cover. The cover is made of 16mil clear PVC with reinforced seams, tear resistant top, and heavy-duty zipper. The material is anti-bacterial, flame retardant and UV resistant.

### Construction

**Material:** Hi-tensile, corrosion resistant, rust proof type 5052 aluminum alloy.

**Frame:** The vertical uprights are 1" (3cm) x 1" (3cm) .070 wall 6061-T6 aluminum alloy tubes welded to form a rigid frame.

**Angle Slides:** The angle slides are 1.125" (3cm) x 1.5" (4cm) x .070 thick extruded aluminum angles welded to vertical uprights.

**Top:** The top is .063 type 5052 aluminum alloy.

**Caster:** Swivel casters (2 with brakes) are mounted to a welded bottom bolster.

### Warranty

One years parts and labor.

# DHOR HEAVY-DUTY CARTS

## OPEN RETRIEVAL CARTS WITH TWO TRAYS PER SLIDE

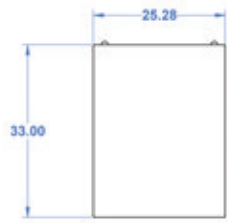

**DHOR12**



**DHOR20**

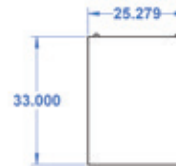

**DHOR24**

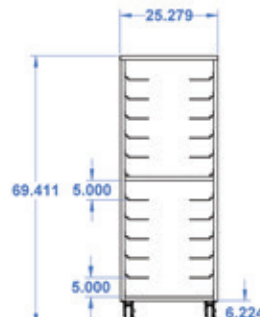
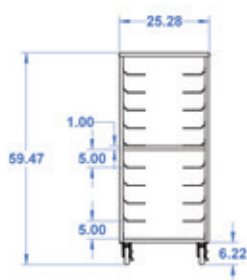

### Items and Dimensions

ITEM NUMBER	LENGTH	WIDTH	HEIGHT	TRAY CAPACITY	TRAY SIZE	FREIGHT CLASS	SHIP WEIGHT	SHIP CUBE
DXDHOR12UP	33" (83.82cm)	25.28" (64.21cm)	38.41" (97.56cm)	12	15 X 20	250	50.0	18.54
DXDHOR20UP	33" (83.82cm)	25.28" (64.21cm)	59.47" (151.05cm)	20	15 X 20	250	60.0	28.76
DXDHOR24UP	33" (83.82cm)	25.28" (64.21cm)	69.41" (176.30cm)	24	15 X 20	250	70.0	33.50

### Cart Accessories

ITEM NUMBER	DESCRIPTION
DXDHOR12UCOVR	CLEAR VINYL TRASPORT COVER FOR CART, ZIPPERED FRONT PANEL
DXDHOR12UCOVR2	CLEAR VINYL TRASPORT COVER FOR CART, ZIPPERED FRONT & REAR PANEL



Please confirm that you have the most current specification sheet by visiting [www.dinex.com](http://www.dinex.com).  
Dinex® reserves the right to change specifications and product design without notice.  
Such revisions do not entitle the buyer to corresponding changes, improvements, additions or replacements for previously purchased equipment.

4711 E Hefner Road  
Oklahoma City, OK 73131  
800.654.8210 • 405.475.5600  
[www.dinex.com](http://www.dinex.com)