



"Your Solutions Partner"

# Specifications

F.O.B Sedalia, Missouri 65301



**HB2BC**

*shown with optional overhead canopy*

### OPTIONS:

- Overhead canopy - clear acrylic canopy, bullet lamps (2), infrared, 250 watts each, stainless steel adjustable tubing posts - **HB2BC-CCL**
- Laminate finish other than standard eight (8) finishes - **HBMODA2**
- Kickplates - **HBMODH1** (stainless)/ **HBMODH2** (painted)/ **HBMODH3** (laminated to match body)
- Three phase wiring
- Stainless steel spillage pans
- Legs in lieu of casters

### AGENCY LISTING:



**DUKE MANUFACTURING CO.**

**2305 N. Broadway**

**St. Louis, MO 63102**

**800.735.3853 Toll Free**

**314.231.5074 Fax**

**www.dukmfg.com**

### Approval Stamp(s):

#### PRODUCT INFORMATION:

PROJECT: \_\_\_\_\_

ITEM: \_\_\_\_\_

QUANTITY: \_\_\_\_\_

MODEL:

#### Heritage Buffet - Hot/Cold Beef Cart

- HB2BC** 32" length unit

#### TOP:

- Heavy gauge, 300 Series stainless steel
- Stainless steel perforated platform with "V" edge - all four sides removable - 32"L x 27-3/4"W
- Removable au jus pan
- Carving board - 10" x 14" x 1-1/8" thick, removable
- Meat spike, stainless steel, removable

#### BODY:

- Heavy gauge paint grip steel
- Laminate patterns:
  - Beige Grafix - **HB-01**
  - Oxide - **HB-04**
  - Fallen Leaves - **HB-07**
  - Chestnut Burl - **HB-11**
- Stellar - **HB-03**
- Northern Oak - **HB-06**
- Azul Granite - **HB-13**
- Amber Maple - **HB-12**

- Stainless steel trim strips on corners
- Flanged and channeled edges for strength
- Welded together with reinforcements
- Mounted on NSF listed 5" diameter swivel casters, two with locks, all non-marking polyurethane tires

#### HOT FOOD SECTION:

- Exposed element in each compartment
  - 500 watt
  - 750 watt
- Voltage/Phase
  - 120 Volt/1 Ph
  - 208 Volt/1 Ph
  - 240 Volt/1 Ph
- (2) hot food wells under platform
- Stainless steel liners, 12" x 20", insulated with fiberglass
- Individual infinite controls
- 6' cord and plug
- Spillage pans included, aluminum

#### SHORT FORM SPECIFICATIONS:

**Duke Heritage Buffet - Beef Cart.** Top shall be heavy gauge 300 Series stainless steel with top flanged down 2" to fit flush with body on all four sides. Stainless steel perforated platform, constructed with "V" edge on all four sides, mounted on top of unit. Platform equipped with au jus pan, carving board (10" x 14" x 1-1/8" thick) and meat spike. Body of units shall be heavy gauge paint grip steel with option of eight (8) laminate patterns. Stainless steel trim strips on corners of body panels. Optional canopy to have clear acrylic, infrared bullet lamps and adjustable stainless steel tubing posts. NSF listed caster, 5" diameter, polyurethane, swivel-type, two with locks, all non-marking tires, shall be furnished.

# HERITAGE<sup>®</sup> FROM DUKE

## Heritage Buffet Beef Cart

□ HB2BC 32" length unit

### LEGEND

▲ - ELECTRICAL CONNECTION

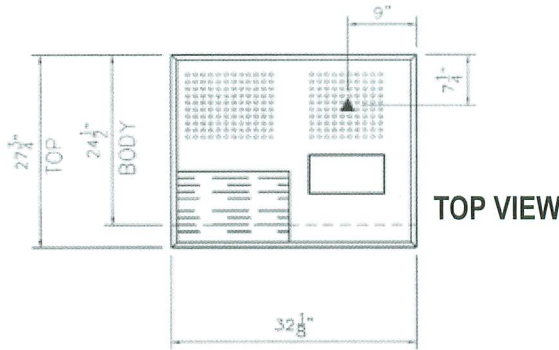

FRONT VIEW

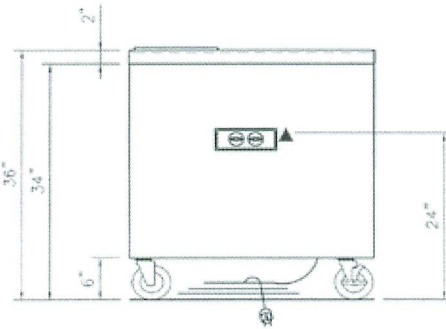

SIDE VIEW

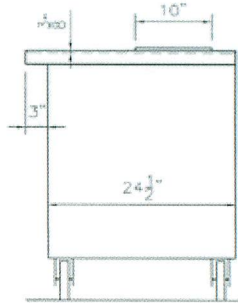

**DIMENSIONS:**

FREIGHT CLASS: 100

Model	Length		Weight		Height		# Wells	Cube ft. crated	Weight	
	in.	cm	in..	cm	in.	cm			lbs.	kg
HB2BC	32	81.3	24-1/2	62.2	36	91.4	2	26.3	300	136.4

Model	Carving Area			
	Length		Width	
	in.	cm	in..	cm
HB2BC	32	81.3	24-3/4	70.5

**ELECTRICAL SPECIFICATIONS:**

Model	120 volt - 500 watt elements			208 volt - 750 watt elements			240 volt - 750 watt elements		
	watts	amps	NEMA	watts	amps	NEMA	watts	amps	NEMA
HB2BC	1500	12.5	5-15	2000	9.6	L14-30	2000	8.3	L14-30

**DUKE MANUFACTURING CO.**  
2305 N. Broadway  
St. Louis, MO 63102



"Your Solutions Partner"

800.735.3853 Toll Free  
314.231.1130 St. Louis  
314.231.5074 Fax  
www.dukmfg.com

Specification subject to change

Printed in U.S.A  
© 2006, Duke Manufacturing Co.