

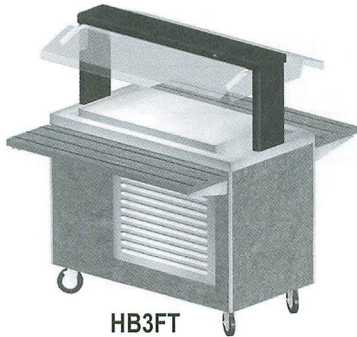

"Your Solutions Partner"

# Specifications

F.O.B Sedalia, Missouri 65301



**HB3FT**

(shown with optional trayslides and canopy)

### OPTIONS:

- 220V - 50 Hz compressor
- Internal locking device
- Condensate evaporator - **COND EVAP**
- 1-color laminate on body/second color laminate on tray slide-  
**HBMODA1**
- Laminate finish other than standard eight (8) finishes -  
**HBMODA2**
- Designer food shield - **TS Series**
- Glass display shelves - **98x Series**
- Buffet shelves - **83x, 93x Series**
- Serving shelves - **956-x, 956-460-x Series**
- Lights in canopy - **HB-50**
- Kickplates - **HBMODH1** (stainless)/ **HBMODH2** (painted)/  
**HBMODH3** (laminate to match body)
- Heritage laminated trayslides
- End shelf
- Solid trayslides
- 3-bar trayslides
- Bread and cheese board - **HBMODJ1**
- Legs in lieu of casters

### AGENCY LISTINGS:



**DUKE MANUFACTURING CO.**  
2305 N. Broadway  
St. Louis, MO 63102

800.735.3853 Toll Free  
314.231.1130 In Missouri  
314.231.5074 Fax  
www.dukemfg.com

Approval Stamp(s):

### PRODUCT INFORMATION:

PROJECT: \_\_\_\_\_  
ITEM: \_\_\_\_\_  
QUANTITY: \_\_\_\_\_

### MODEL:

#### Heritage Buffet - Frost Top

- HB3FT** 46" length unit /36-1/4" X 17-1/4" display
- HB4FT** 60" length unit /50-1/4" X 17-1/4" display
- HB5FT** 74" length unit /64-1/4" X 17-1/4" display

### TOP:

- 16 gauge, 300 Series stainless steel - rim and display
- Flanged down 2" on all four (4) sides
- Display raised 1" above body
- Drain gutter on all four sides
- 1" drain and plug
- Compressor of 1/4HP operates on 120v
- Refrigerated coils under top - R134A

### BODY:

- Heavy gauge paint grip steel
- Laminate patterns:
  - Beige Grafix - **HB-01**
  - Oxide - **HB-04**
  - Fallen Leaves - **HB-07**
  - Chestnut Burl - **HB-11**
  - Stellar - **HB-03**
  - Northern Oak - **HB-06**
  - Azul Granite - **HB-13**
  - Amber Maple - **HB-12**
- Stainless steel trim strips on corners
- Flanged and channeled edges for strength
- Welded together with reinforcements
- Stainless steel removable grille
- Mounted on NSF listed 5" diameter swivel casters, two with locks, all non-marking polyurethane tires
- 6' electric cord and plug

### SHORT FORM SPECIFICATIONS:

**Duke Heritage Buffet - Frost Top.** Units to have 16 gauge stainless steel top, raised 1" above unit with drain gutter on all four sides, with edges flanged down 2" on all four sides. Compressor (1/4 HP, 120V, 5-15 NEMA) furnished. Body of units shall be heavy gauge paint grip steel with option of eight (8) laminate patterns. Stainless steel trim strips on corners of body panels. Must choose finish for body, trayslides and sneeze guards at time of order. NSF listed casters, 5" diameter, polyurethane, swivel-type, two with locks, all non-marking tires, shall be furnished.

# HERITAGE<sup>®</sup>

FROM DUKE

## HERITAGE BUFFET FROST TOP

- HB3FT** 46" length unit/36-1/4 X 17-1/4" display
- HB4FT** 60" length unit/50-1/4" x 17-1/4" display
- HB4FT** 74" length unit/64-1/4" x 17-1/4" display

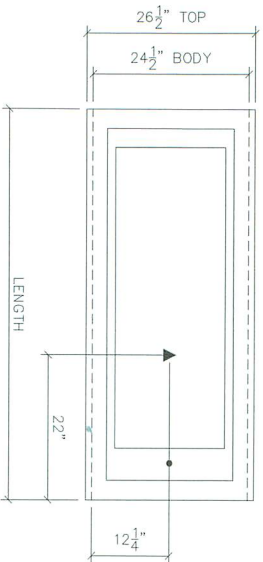

LEGEND	
▲	ELECTRICAL CONNECTION
●	DRAIN LOCATION

TOP VIEW

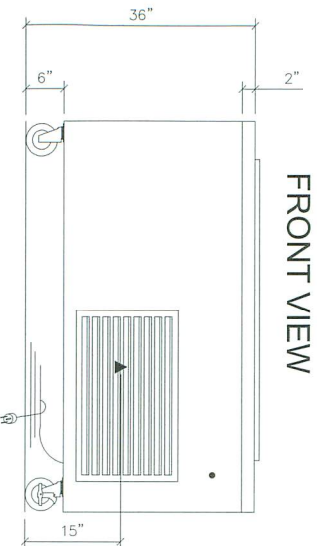

FRONT VIEW

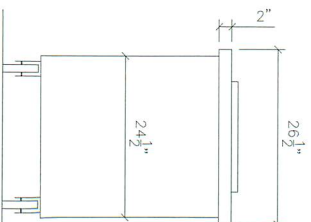

SIDE VIEW

**DIMENSIONS:**

	Length		Width		Height		Display Surface in.	Cube ft created	Weight	
	in.	cm	in.	cm	in.	cm			lbs.	kg
HB3FT	46	116.8	26-1/2	67.3	36	91.4	36-1/4 x 17-1/4	36.0	460	209.1
HB4FT	60	152.4	26-1/2	67.3	36	91.4	50-1/4 x 17-1/4	45.7	670	304.6
HB5FT	74	188.0	26-1/2	67.3	36	91.4	64-1/4 x 17-1/4	55.4	760	345.5

Freight Class: 100

**ELECTRICAL SPECIFICATIONS:**

Model	HP	Without Fluorescent Lights	
		amps	NEMA
HB3FT	1/4	6.0	5-15
HB4FT	1/4	6.0	5-15
HB5FT	1/4	6.0	5-15

**DUKE MANUFACTURING CO.**

2305 N. Broadway  
St. Louis, MO 63102



“Your Solutions Partner”

800.735.3853 Toll Free  
314.231.1130 In Missouri  
314.231.5074 Fax  
www.dukemfg.com

Specifications subject to change

01/07  
Printed in U.S.A.  
© 2007, Duke Manufacturing Co.