



Profit from the Eagle Advantage®

# Specification Sheet

## Short Form Specifications

Eagle Spec-Bar® Hand Sink, model \_\_\_\_\_. Heavy gauge type 304 stainless steel sink, body, legs, leg channels and cross rails. 1½" stainless steel I.P.S. threaded drain with nut and washer. Stainless steel adjustable bullet feet.

*HS models:* Furnished with deck mounted T&S faucet.

*HSD models:* Furnished with front door with paper towel dispenser, deck mounted soap dispenser, and splash mounted T&S faucet.



## Options / Accessories

- Removable plastic perforated strainer

|              |       |
|--------------|-------|
| Item No.:    | _____ |
| Project No.: | _____ |
| S.I.S. No.:  | _____ |

## Spec-Bar® Hand Sinks

### MODELS:

- HS12-19**
- HS12-24**
- HS18-19**
- HS18-24**
- HSD12-24**
- HSD18-19**
- HSD18-24**

### Design and Construction Features

- Body, legs and crossbracing constructed of type 304 stainless steel for strength and corrosion resistance.
- Backsplash, sides, bottom, front panel or door, and bowl are 20 gauge stainless steel.
- Leg channels, legs and crossbracing are 16 gauge stainless steel.
- Legs are 1½" (41mm) diameter type 304 stainless steel with stainless steel adjustable bullet feet.
- Sink bowl is 9¼" x 11½" x 6" (235 x 292 x 152mm) deep with hot and cold water gooseneck faucet.
- Faucets are deck mounted on 4" (102mm) centers with ½" (13mm) NPT inlet and hot and cold water connections required.
- Deluxe "HSD" models feature front access hinged door, soap dispenser and paper towel dispenser.
- 1½"(38mm) I.P.S. threaded drain with nut and washer.

**EAGLE GROUP**  
 100 Industrial Boulevard, Clayton, DE 19938-8903 USA  
 Phone: 302-653-3000 • Fax: 302-653-2065  
 www.eaglegrp.com

**Foodservice Division: Phone 800-441-8440**  
**MHC/Retail Display Divisions: Phone 800-637-5100**

For custom configuration or fabrication needs, contact our **SpecFAB® Division**.  
 Phone: 302-653-3000 • Fax: 302-653-3091 • e-mail: specfab@eaglegrp.com



EG40.34 Rev. 04/11

**Spec sheets available for viewing, printing or downloading from our online literature library at [www.eaglegrp.com](http://www.eaglegrp.com)**

*Eagle Foodservice Equipment, Eagle MHC, SpecFAB®, and Retail Display are divisions of Eagle Group. ©2011 by the Eagle Group*



Profit from the Eagle Advantage®

Item No.: \_\_\_\_\_  
 Project No.: \_\_\_\_\_  
 S.I.S. No.: \_\_\_\_\_

## Spec-Bar® Hand Sinks

### 19" (483mm)-wide Units

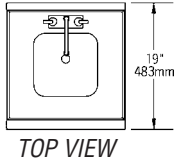

TOP VIEW

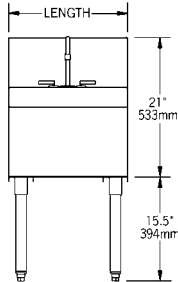

FRONT VIEW

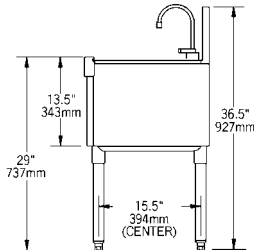

SIDE VIEW

| model # | width |     | length |     | weight |      |
|---------|-------|-----|--------|-----|--------|------|
|         | in.   | mm  | in.    | mm  | lbs.   | kg   |
| HS12-19 | 19"   | 483 | 12"    | 305 | 30     | 13.6 |
| HS18-19 | 19"   | 483 | 18"    | 457 | 35     | 15.9 |

### 24" (610mm)-wide Units

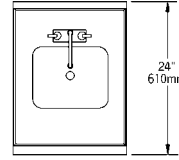

TOP VIEW

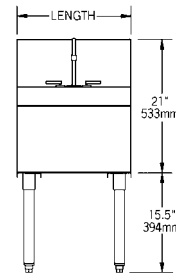

FRONT VIEW

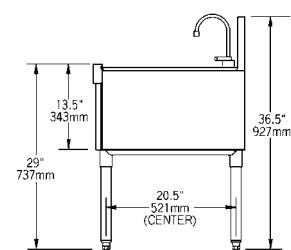

SIDE VIEW

| model # | width |     | length |     | weight |      |
|---------|-------|-----|--------|-----|--------|------|
|         | in.   | mm  | in.    | mm  | lbs.   | kg   |
| HS12-24 | 24"   | 610 | 12"    | 305 | 35     | 15.9 |
| HS18-24 | 24"   | 610 | 18"    | 457 | 40     | 18.1 |

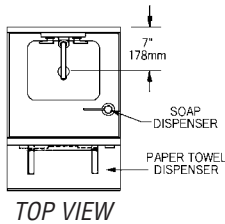

TOP VIEW

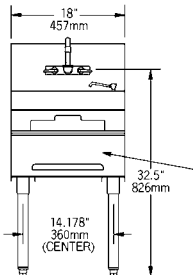

FRONT VIEW

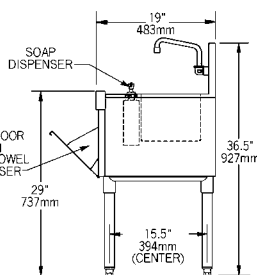

SIDE VIEW

| model #  | width |     | length |     | weight |      |
|----------|-------|-----|--------|-----|--------|------|
|          | in.   | mm  | in.    | mm  | lbs.   | kg   |
| HSD18-19 | 19"   | 483 | 18"    | 457 | 45     | 20.4 |

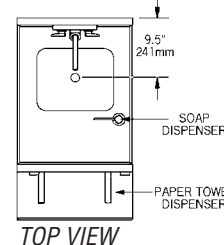

TOP VIEW

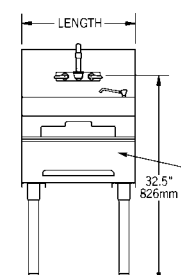

FRONT VIEW

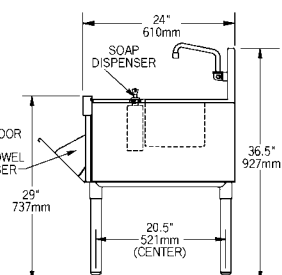

SIDE VIEW

| model #  | width |     | length |     | weight |      |
|----------|-------|-----|--------|-----|--------|------|
|          | in.   | mm  | in.    | mm  | lbs.   | kg   |
| HSD12-24 | 24"   | 610 | 12"    | 305 | 45     | 20.4 |
| HSD18-24 | 24"   | 610 | 18"    | 457 | 50     | 22.7 |

### EAGLE GROUP

100 Industrial Boulevard, Clayton, DE 19938-8903 USA

Phone: 302-653-3000 • Fax: 302-653-2065

www.eaglegrp.com

Foodservice Division: Phone 800-441-8440

MHC/Retail Display Divisions: Phone 800-637-5100

Printed in U.S.A.

©2011 by Eagle Group

Rev. 04/11

Spec sheets available for viewing, printing or downloading from our online literature library at [www.eaglegrp.com](http://www.eaglegrp.com)

Although every attempt has been made to ensure the accuracy of the information provided, we cannot be held responsible for typographical or printing errors. Information and specifications are subject to change without notice. Please confirm at time of order.