



Profit from the Eagle Advantage®

Specification Sheet

Short Form Specifications

Eagle Piggyback Wall Mounted Shelving System, 3-tier bracket kit model _____ (One, Two, Three Shelves) patented Quad-Truss®, open wire design chrome finished wire shelf with chrome plated wall brackets. Brackets can be secured directly to wall studs with no wall backing required.

Eagle Piggyback Wall Mounted Shelving System, 5-tier bracket kit model _____ (Three, Four, Five Shelves) patented Quad-Truss®, open wire design chrome finished wire shelves with chrome plated wall brackets. Brackets can be secured directly to wall studs with no wall backing required.

PATENTED!
(patent #8,025,163 B2)

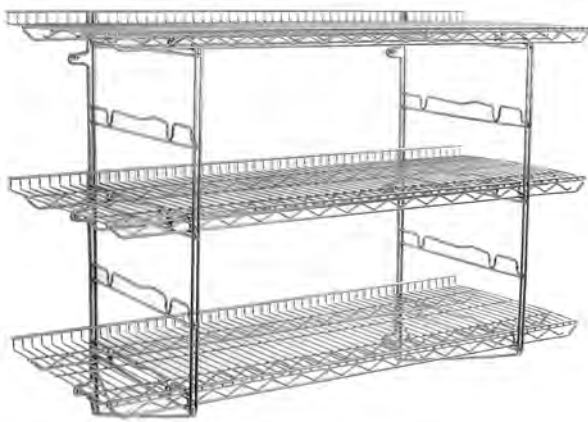

#S3-5B-SSW1848C
5-tier unit with 3 shelves

Options / Accessories

- Additional shelves
- Additional brackets

EAGLE GROUP
100 Industrial Boulevard, Clayton, DE 19938-8903 USA
Phone: 302-653-3000 • Fax: 302-653-2065
www.eaglegrp.com

Foodservice Division: Phone 800-441-8440
MHC/Retail Display Divisions: Phone 800-637-5100

For custom configuration or fabrication needs, contact our **SpecFAB® Division**.
Phone: 302-653-3000 • Fax: 302-653-3091 • e-mail: specfab@eaglegrp.com

Item No.: _____
Project No.: _____
S.I.S. No.: _____

Piggyback Wall Mounted Shelf Kits

MODELS:

- S1-3B-SSW18*C
- S2-3B-SSW18*C
- S3-3B-SSW18*C
- S3-5B-SSW18*C
- S4-5B-SSW18*C
- S5-5B-SSW18*C
- SSW18*C

* See charts for complete model numbers.

Design and Construction Features

- Allows for freedom to position the shelf anywhere on the brackets without the use of fasteners.
- Brackets can be mounted to studs – no wall backing required.
- Three or five tier kits available.
- Freedom to move the shelves left or right.
- Wire design allows for air circulation.
- Chrome finish.
- Available in 18" (457mm) width.
- Shelf lengths range from 24" to 60" (610 to 1524mm).
- No tools required to attach shelf to wall brackets.

Certifications / Approvals



AUTOQUOTES



EG02.13 Rev. 05/12

Spec sheets available for viewing, printing or downloading from our online literature library at www.eaglegrp.com

Eagle Foodservice Equipment, Eagle MHC, SpecFAB®, and Retail Display are divisions of Eagle Group. ©2012 by the Eagle Group



Profit from the Eagle Advantage®

Item No.: _____
 Project No.: _____
 S.I.S. No.: _____

Piggyback Wall Mounted Shelf Kits

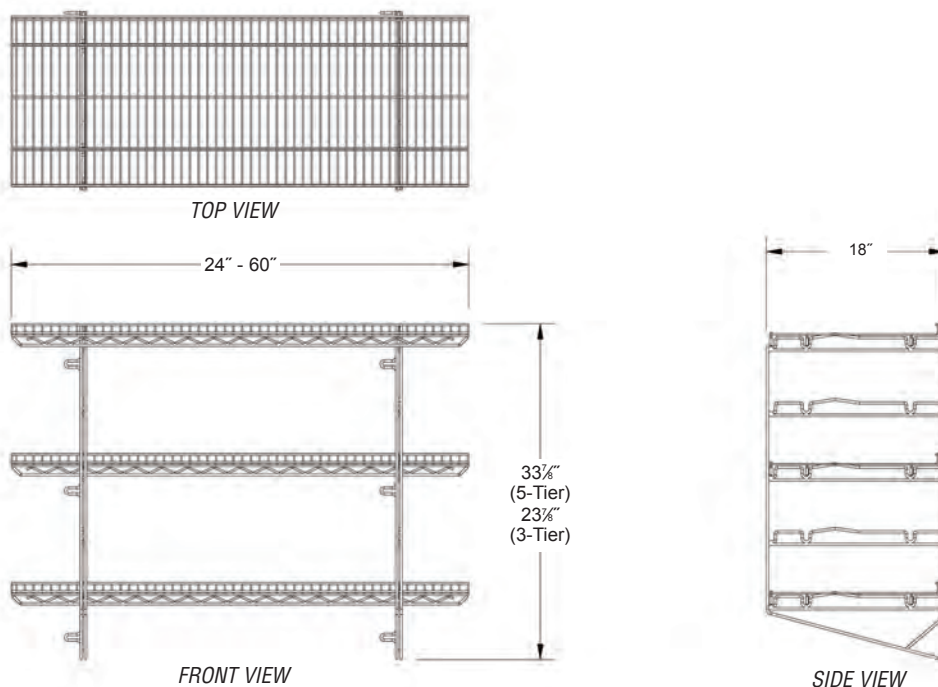

(5-tier bracket kit shown with 3 shelves - S3-5B-SSW1848C)

Three-Tier Bracket Kits – Includes one pair of 23 3/8" (606mm)-high brackets.

shelf length x width in. mm	Units with 1 Chrome Shelf		Units with 2 Chrome Shelves		Units with 3 Chrome Shelves		Add'l Shelves chrome	
	weight lbs. kg	model #	weight lbs. kg	model #	weight lbs. kg	model #	weight lbs. kg	model #
18" x 24" 457 x 610	12 5.4	S1-3B-SSW1824C	17 7.7	S2-3B-SSW1824C	22 10.0	S3-3B-SSW1824C	5 2.3	SSW1824C
18" x 30" 457 x 762	13 5.9	S1-3B-SSW1830C	19 8.6	S2-3B-SSW1830C	25 11.3	S3-3B-SSW1830C	6 2.7	SSW1830C
18" x 36" 457 x 914	14 6.4	S1-3B-SSW1836C	21 9.5	S2-3B-SSW1836C	28 12.7	S3-3B-SSW1836C	7 3.2	SSW1836C
18" x 42" 457 x 1067	16 7.3	S1-3B-SSW1842C	24 10.9	S2-3B-SSW1842C	33 15.0	S3-3B-SSW1842C	9 4.1	SSW1842C
18" x 48" 457 x 1219	17 7.7	S1-3B-SSW1848C	27 12.2	S2-3B-SSW1848C	37 16.8	S3-3B-SSW1848C	10 4.5	SSW1848C
18" x 60" 457 x 1524	22 10.0	S1-3B-SSW1860C	37 16.8	S2-3B-SSW1860C	51 23.1	S3-3B-SSW1860C	15 6.8	SSW1860C

Five-Tier Bracket Kits – Includes one pair of 33 3/8" (860mm)-high brackets.

shelf length x width in. mm	Units with 1 Chrome Shelf		Units with 2 Chrome Shelves		Units with 3 Chrome Shelves		Add'l Shelves chrome	
	weight lbs. kg	model #	weight lbs. kg	model #	weight lbs. kg	model #	weight lbs. kg	model #
18" x 24" 457 x 610	19 8.6	S3-5B-SSW1824C	22 10.0	S4-5B-SSW1824C	29 13.2	S5-5B-SSW1824C	5 2.3	SSW1824C
18" x 30" 457 x 762	22 10.0	S3-5B-SSW1830C	28 12.7	S4-5B-SSW1830C	34 15.4	S5-5B-SSW1830C	6 2.7	SSW1830C
18" x 36" 457 x 914	25 11.3	S3-5B-SSW1836C	32 14.5	S4-5B-SSW1836C	39 17.6	S5-5B-SSW1836C	7 3.2	SSW1836C
18" x 42" 457 x 1067	30 13.6	S3-5B-SSW1842C	38 17.2	S4-5B-SSW1842C	47 21.3	S5-5B-SSW1842C	9 4.1	SSW1842C
18" x 48" 457 x 1219	34 15.4	S3-5B-SSW1848C	44 20.0	S4-5B-SSW1848C	54 24.5	S5-5B-SSW1848C	10 4.5	SSW1848C
18" x 60" 457 x 1524	49 22.2	S3-5B-SSW1860C	64 29.0	S4-5B-SSW1860C	79 35.8	S5-5B-SSW1860C	15 6.8	SSW1860C

Additional Wall Brackets (pair) - Chrome

width x height in. mm	weight		model #
	lbs.	kg	
18" x 23 3/8" 457 x 606	7.3	3.3	SSW18B3-C
18" x 33 3/8" 457 x 860	10.8	4.9	SSW18B5-C

EAGLE GROUP

100 Industrial Boulevard, Clayton, DE 19938-8903 USA

Phone: 302-653-3000 • Fax: 302-653-2065 • www.eaglegrp.com

Foodservice Division: Phone 800-441-8440

MHC/Retail Display Divisions: Phone 800-637-5100

Printed in U.S.A.
 ©2012 by Eagle Group

Rev. 05/12

Spec sheets available for viewing, printing or downloading from our online literature library at www.eaglegrp.com

Although every attempt has been made to ensure the accuracy of the information provided, we cannot be held responsible for typographical or printing errors. Information and specifications are subject to change without notice. Please confirm at time of order.