



EM Series Static Gas Oven Base 36"

ITEM # _____

MODEL # _____

PROJECT NAME # _____

SIS # _____

AIA# _____

EM Series

Static Gas Oven Base 36"

169062 (AFG36)

STATIC GAS OVEN BASE 36"
(915 mm)

Short Form Specification

Item No. _____

Unit to be Electrolux 36" (915 mm) Static Gas Oven Base. Suitable for natural gas or propane gas. Special heavy duty chrome plated knobs for durability and easy cleaning. The configuration of bezels and knobs provides high level of protection against water infiltrations. Supplied with 6" (150 mm) height adjustable, removable legs. Unit may be installed on castors. 24" (610 mm) static oven 34,000 BTU/hr (10 kW) with unique baffle above the burner distributes heat to provide even cooking temperatures throughout the cavity. Vitreous enameled oven interior accommodates two standard Imperial full size 18" x 26" (457 mm x 660 mm) sheet pans. The interior is 19-1/2" w x 26-3/4" d x 15" h (497 mm w x 680 mm d x 380 mm h). 100% safety pilot. Manual oven shut-off valve. Heavy duty thermostat with temperature range from 158°F to 590°F (70°C to 310°C). Oven supplied with two stainless steel tray racks.



Approval: _____

Main Features

Oven Information:

- 24" (610 mm) static oven 34,000 BTU/hr (10 kW) with unique baffle above the burner distributes heat to provide even cooking temperatures throughout the cavity.
- Vitreous enameled oven interior accommodates two standard Imperial full size 18" x 26" (457 mm x 660 mm) sheet pans.
- The interior is 19-1/2" w x 26-3/4" d x 15" h (497 mm w x 680 mm d x 380 mm h).
- 100% safety pilot.
- Manual oven shut-off valve.
- Heavy duty thermostat with temperature range from 158°F to 590°F (70°C to 310°C).
- Oven supplied with two stainless steel tray racks.

General Information:

- Worktop in AISI 304 Stainless Steel.
- Front and side panels in Stainless Steel with Scotch Brite finish.
- Special heavy duty chrome plated knobs for durability and easy cleaning.
- The configuration of bezels and knobs provides high level of protection against water infiltrations.
- Supplied with 6" (150 mm) height adjustable, removable legs.
- Unit may be installed on castors.
- Included Accessories: propane converter kit, pressure regulator and main shut off valve.

Electrolux Professional Inc.

www.electroluxusa.com/professional

www.electrolux.com/foodservice

foodservice@electrolux.com



EM Series
Static Gas Oven Base 36"

Front

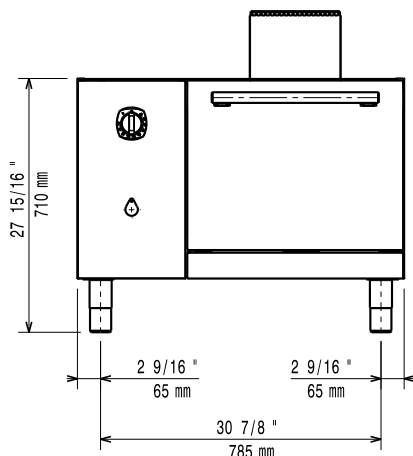

Top

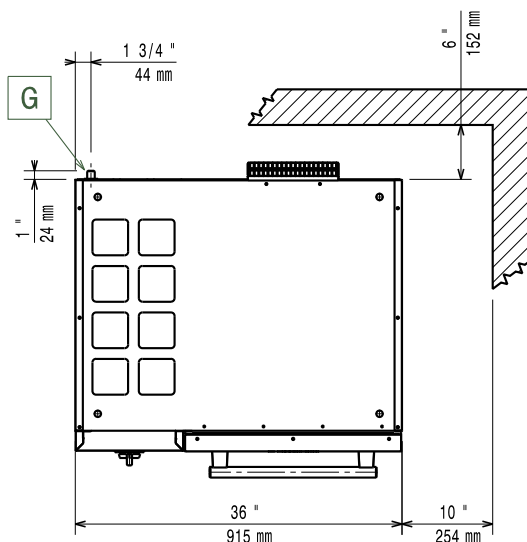

G = Gas connection

Side

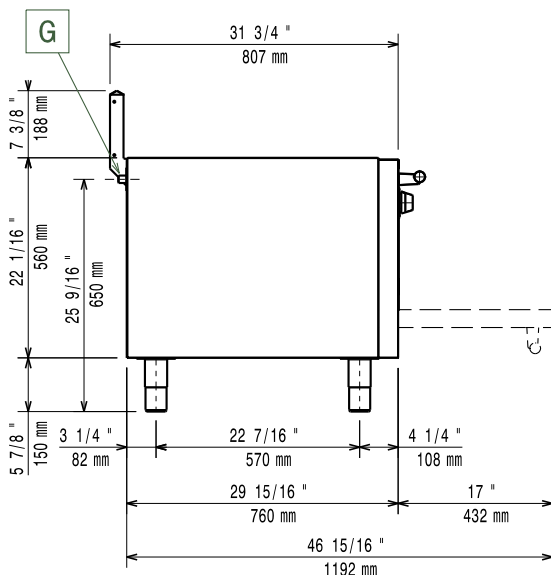

Gas

Gas Power:

169062(AFG36) 34090 Btu/hr (10 kW)

Gas Inlet: 3/4" NPT

Natural Gas Pressure: 3" w.c. (7 mbar)

Propane Gas Pressure: 7" w.c. (18 mbar)

Key Information

Oven working Temperature: 158 °F (70 °C) MIN - 590 °F (310 °C) MAX

Oven Cavity Dimensions (width): 19 9/16" (497 mm)

Oven Cavity Dimensions (depth): 26 3/4" (680 mm)

Oven Cavity Dimensions (height): 14 15/16" (380 mm)

External dimensions, Width: 36 1/32" (915 mm)

External dimensions, Depth: 31 3/4" (807 mm)

External dimensions, Height: 35 3/8" (898 mm)

Net weight: 220 lbs (100 kg)

Shipping width: 38 3/8" (975 mm)

Shipping depth: 37 5/8" (956 mm)

Shipping height: 43 7/16" (1104 mm)

Shipping weight: 254 lbs (115 kg)

Shipping volume: 36.34 ft³ (1.03 m³)

* The rear and side clearances shown on the diagram indicate the minimum distances recommended from the appliance to combustible surfaces.