

Item No.: _____ Qty.: _____
Model No.: _____
Project No.: _____



Economy Series Hand Sink

Economy 14" Hand Sink, Wall Mounted

☐ EHS-14X

Features

- 18 Gauge, 300 series stainless steel
- 6" Backsplash with 2" return
- Goose neck faucet
- 1-1/2" Drain opening
- Strainer included
- Z-clip mounting bracket
- Easy to clean and sanitize

Options

- ☐ Side Splashes
- ☐ Faucet Upgrade
- ☐ Apron Skirt
- ☐ P-Trap
- ☐ Overflow

Materials

- Sink & Bowl: 18 gauge, 300 series stainless steel
- Top: Backsplash is 18 gauge, 300 series stainless steel

Mechanical

- 1-1/8" (29mm) faucet holes on 4" (102mm) centers
- 1-1/2" (38mm) waste drain opening

Flyer Product

In keeping with our policy of continuing product improvement, Elkay SSP reserves the right to change product specifications without notice.



AUTOQUOTES



This specification describes an Elkay SSP product with design, quality and functional benefits to the user. When making a comparison of other producers' offerings, be certain these features are not overlooked.

Elkay SSP
421 N. Freya St.
Spokane, WA 99205
Phone: 800-726-0553 Fax: 509-535-1493

Website: www.sspinc.net
Email: sspsales@elkay.com
©2011 Elkay

SNK-EHS14X10OCT2011

Page 1 of 2



Item No.: _____ Qty.: _____

Model No.: _____

Project No.: _____

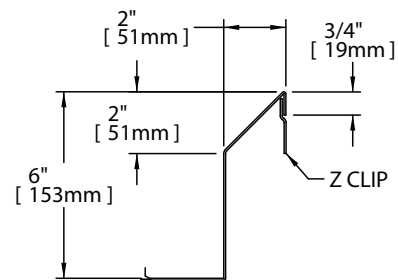
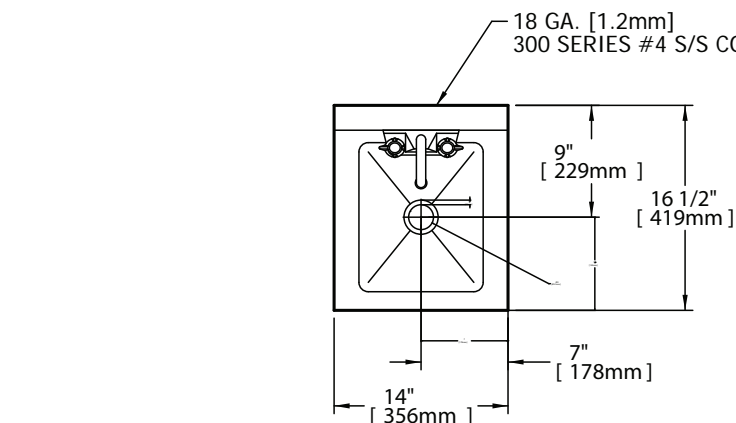

BACKSPLASH DETAIL

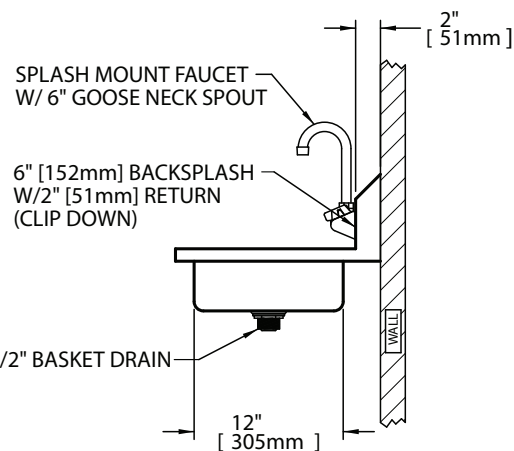
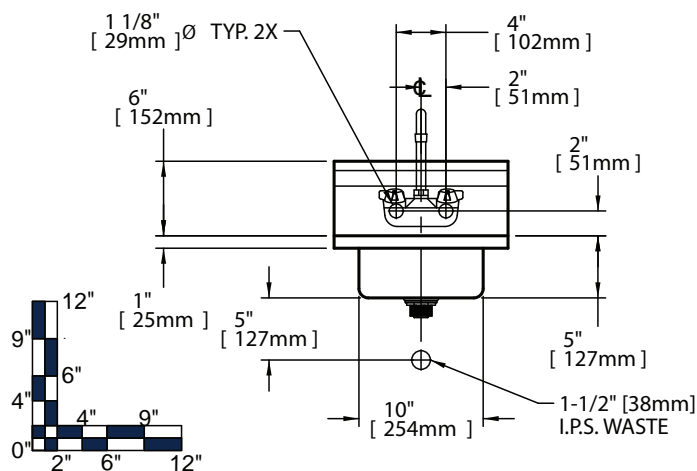

Economy Hand Sinks																
	Bowl Dimensions						Overall Size						Drain		Weight	
	Width		Front-to-Back		Depth		Width		Front-to-Back		Height		Location			
	A		B		D		L		W		H		DL			
	in.	mm	in.	mm	in.	mm	in.	mm	in.	mm	in.	mm	in.	mm	lbs.	kg
EHS - 14 - X	10	254	14	356	5	127	14	356	18	457	11	279	10.0	254	12	5

* Custom sizes also available

