

Item No.:	_____	Qty.:	_____
Model No.:	_____		
Project No.:	_____		

## Standard Series Wall Mounted Shelf

*Standard Wall Mounted Shelf with Pot Rack*



- SLW-S-48X
- SLW-S-60X
- SLW-S-72X

### Features

- 18 Gauge, 300 series stainless steel
- Turned down on front & sides, turned up 1-1/2" at rear
- Includes stainless steel wall brackets and 1 stainless steel pot hot per foot
- Welded construction for consistent metal gauge thickness throughout
- Does not include mounting hardware
- Shipped knocked down for reduced shipping costs

### Materials

- **Shelf:** 18 Gauge, 300 series stainless steel
- **Brackets:** Stainless steel
- **Hooks:** Stainless steel

### Options

- Bracket Upgrades / Modifications
- Edge Modifications
- Shelf Modifications
- Undershelves
- Additional Pot Hooks
- Pot Hook Upgrades

### Flyer Product



**AUTOQUOTES**



*In keeping with our policy of continuing product improvement, Elkay SSP reserves the right to change product specifications without notice.*

*This specification describes an Elkay SSP product with design, quality and functional benefits to the user. When making a comparison of other producers' offerings, be certain these features are not overlooked.*



Item No.: \_\_\_\_\_ Qty.: \_\_\_\_\_  
 Model No.: \_\_\_\_\_  
 Project No.: \_\_\_\_\_

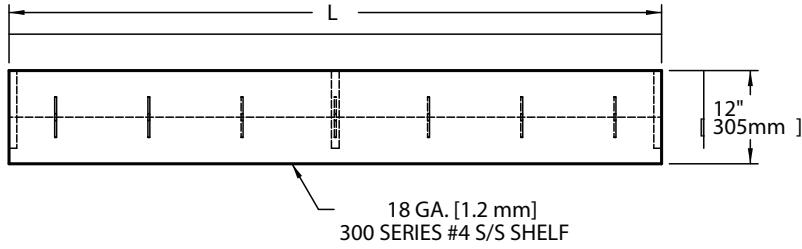

RACKS 84" AND LONGER HAVE CENTER BRACKET

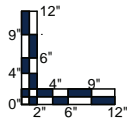
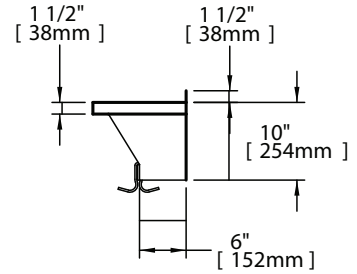
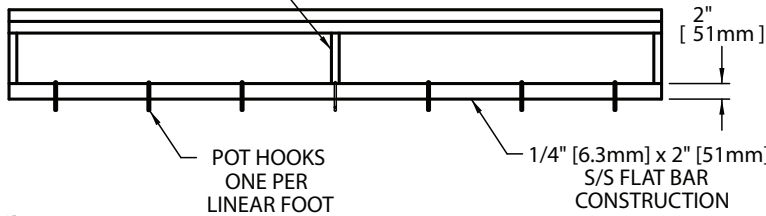

12" Shelf with Single Line Pot Rack							
Model Number	Overall Length		Overall Width		Pot Hooks	Weight	
	L		W			lbs.	kg
	in.	mm	in.	mm			
SLW - S - 48 X	48	1219	12	305	4	59	27
SLW - S - 60 X	60	1524	12	305	5	75	34
SLW - S - 72 X	72	1829	12	305	6	86	39

\* Custom sizes also available

