



- Body and tank in stainless steel construction 18/10 AISI 304,
- Electronic controls that allow a complete control of the entire washing process,
- Tunnel composition:
 - 1 Pre-wash - wash arms : 3 upper + 1 lower
 - 1 Wash - wash arms : 3 upper + 2 lower
 - 1 Rinse - rinse arms : 1 upper + 1 lower
- Completely automatic,
- Pre-washing,
- Upper and lower fixed washing,
- Upper and lower fixed rinsing,
- Completely automatic,
- Washing and rinsing arms in stainless steel constructions, easy disassembly and interchangeable,
- Double skin with thermic and acoustic insulation
- Drawn washing tank with rounded edges,
- Stainless steel autodraining washing pump,
- The drain valve allows to automatically empty the tank simply by pressing a button,
- Counterbalanced door,
- Tank and pump filters,
- Insulated boiler,

M150ED



OPTIONS

- Steam condenser
- Heat recoverer
- Drying tunnel
- Heat pump
- Automati start
- Accessories and baskets/dishes handling system

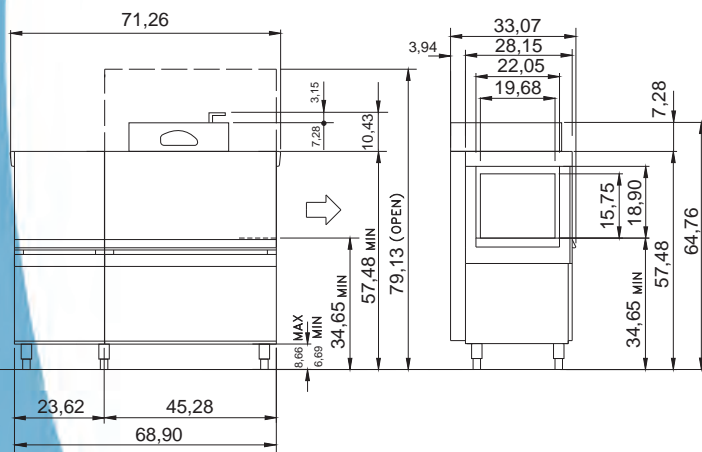
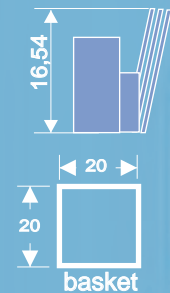

Specifications	M150ED		
VOLTAGE	208/3ph - 60 Hz		V
PRODUCTION (baskets/H)	vit.1=145	vit.2=210	N
(dishes/H)	vit.1=2320	vit.2=3360	N
PRE-WASHING			
TANK CAPACITY	29		Lt
PUMP POWER	736		W
WASHING			
TANK CAPACITY	61		Lt
PUMP POWER	1500		W
TANK HEATING	6000		W
RINSING			
WATER CONSUMPTION	210		Lt/H
BOILER HEATING	33000		W
GEARED MOTOR	0.13		KW
TOTAL RATING	41366		W
WATER CONNECTION	131		°F
WATER PRESSURE	20±5		psi
WATER HARDNESS	5 ÷ 10		Th(°f)
RINSING WATER TEMPERATURE	180 ÷ 195		°F
WATER INLET	3/4"		"G
WATER OUTLET	1"½		"G
NET WEIGHT	180		Kg
GROSS WEIGHT	68,90x33,07xH64,76		inch
NOISE LEVEL	<70		dB(A)

The manufacturer reserves the right to make modifications of materials and models without warning.