



UPRIGHT REACH-IN DUAL TEMPS

Top Mounted Condensing Unit

ES – Series

• ESRFH2 • ESRF2 • ESWRF2 • ESWQ3 • ESRF3

Cabinet Construction

Heavy duty stainless steel interior and exterior, and galvanized steel finished top, bottom and back wall of exterior. ABS evaporator drain cover. 2.5" thick high density foamed-in-place polyurethane insulation. Four 4" diameter casters (front casters with brakes). Door heater installation around inside cabinet frame to prevent moisture build-up.

Refrigeration System

- Self-contained condensing unit located at top of cabinet for high performance
- Oversized condenser and evaporator coil cools to set and maintain temperature in minimum time period
- Forced-air cooling with dual evaporator fan motors providing balanced airflow throughout cabinet to ensure faster temperature drop
- Environmentally friendly CFC free R-134A and R-404A refrigerant
- Adjustable, time initiated defrost cycle of 3 to 12 hours with 350 watt heater, both time and temperature terminated for fail-safe backup
- Automatic evaporator fan motor delay on defrost cycle
- Copper tube and aluminum fin evaporator with anti-corrosive coating
- Energy efficient condensate drain pan located at bottom of cabinet constructed of anodized aluminum
- Two pressure relief ports located at exterior back wall and top of cabinet for rapid re-entry
- Pre-wired and ready to plug, 115V/60Hz/1Ph, NEMA 5-15P

Doors

- Heavy duty stainless steel interior and exterior
- 2.5" thick high density foamed-in-place polyurethane insulation
- Rounded corners for a sleek and modern appearance
- Heavy duty adjustable torsion spring self-closing door system
- One piece snap-in magnetic door gasket for easy replacement
- Heavy duty recessed door handles for a flat surface
- Door locks
- Field reversible doors (*available from 2013 models*)

Lighting

- Safety shielded incandescent interior lighting

Shelving

- Three epoxy coated wire shelves per section
- Stainless steel pilasters and shelf clips

Temperature Control

- Factory preset temperature, 35°F for refrigerators and -4°F for freezers
- Temperature setting range from 33°F to 54°F for refrigerators and -10° F to 54° F for freezers
- Easy to read digital temperature display
- Easy to program push button temperature control
- Microchip digital monitoring system with a variety of functions to monitor and maintain optimum temperature



ESRFH2



ESRF2



ESWRF2



ESWQ3



ESRF3

<ul style="list-style-type: none"> • Project / Customer _____ • Item No. _____ • Model No. _____ 	<p>Warranty</p> <p>5 Year — Compressor Warranty 3 Year — Parts & Labor Warranty Applicable to units purchased after July 1, 2014</p>	<p>Please visit our website for updated Energy Efficiency information</p> <p>201 W. Artesia Blvd, Compton, CA 90220 T. (310) 323-6586, (800) 444-6285 F. (310) 323-7524 www.EVERESTref.com</p>
---	---	--

UPRIGHT REACH-IN DUAL TEMPS

Top Mounted Condensing Unit



REFRIGERATION
EVEREST

ES – Series

• ESRFH2 • ESRF2 • ESWRF2 • ESWQ3 • ESRF3

Dimensions

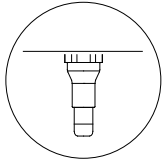

Two additional front adjustable stainless steel clad ABS legs for model ESRFH2 to prevent movement of unit when opening and closing doors

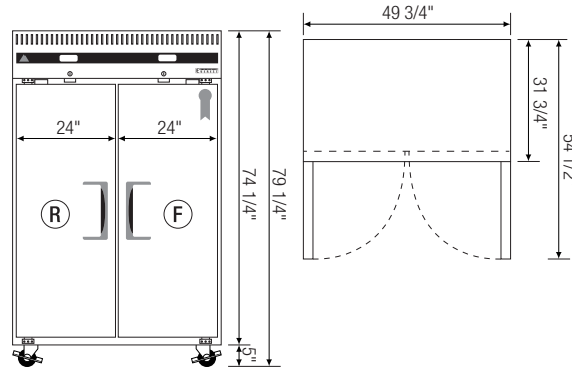

▲ ESRF2

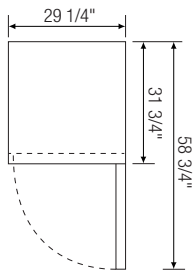

▲ ESRFH2

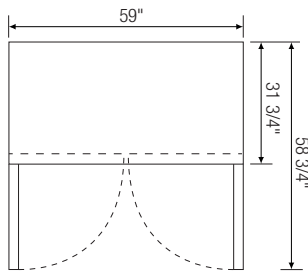

▲ ESWRF2

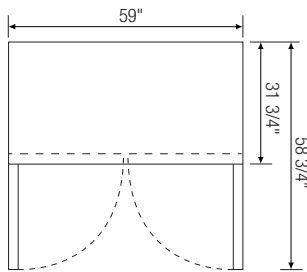

▲ ESWQ3

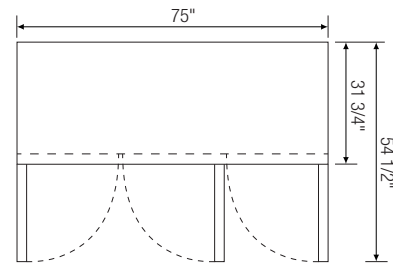

▲ ESRF3

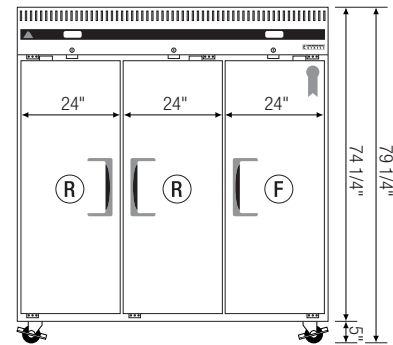
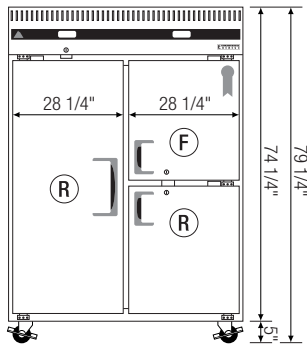
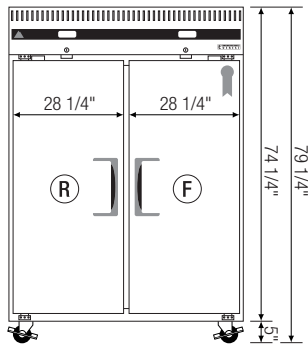
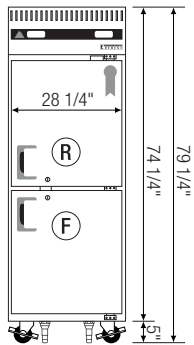

Model	Ref/ Fzr/ Dual	# of Doors	Capacity (Cu.Ft.)	HP	Refrigerant	# of Shelves	Power (V-Hz-Ph)	Amps	Crated Weight (LBS)	Exterior Dimensions (Inches)			* Height does not include 5" for caster. Ref = Refrigerator Fzr = Freezer Dual = Ref & Fzr Combo H = Half Door
										L	D	H*	
ESRFH2	Dual	2(H)	11(Ref) 11(Fzr)	1/2	R-404A	2	115-60-1	7.70	315	29 1/4	31 3/4	74 1/4	
ESRF2	Dual	2	22(Ref) 22(Fzr)	1/3(Ref) 1/2(Fzr)	R-134A(Ref) R-404A(Fzr)	6	115-60-1	12.25	481	49 3/4	31 3/4	74 1/4	
ESWRF2	Dual	2	26(Ref) 26(Fzr)	1/3(Ref) 1/2(Fzr)	R-134A(Ref) R-404A(Fzr)	6	115-60-1	12.25	509	59	31 3/4	74 1/4	
ESWQ3	Dual	2(H) 1(F)	39(Ref) 13(Fzr)	1/3(Ref) 1/3(Fzr)	R-134A(Ref) R-134A(Fzr)	5	115-60-1	12.08	496	59	31 3/4	74 1/4	
ESRF3	Dual	3	46(Ref) 22(Fzr)	1/3(Ref) 1/2(Fzr)	R-134A(Ref) R-404A(Fzr)	9	115-60-1	12.36	586	75	31 3/4	74 1/4	

Disclaimer: Product dimensions are for general purposes and not absolute value. Slight variations may exist. If dimensions are critical, please contact Everest.

Specifications subject to change without notice.

www.EVERESTref.com

201 W. Artesia Blvd, Compton, CA 90220
T. (310) 323-6586, (800) 444-6285 F. (310) 323-7524