

# Back Bar Dual Temp

## FBB-DT Series

- FBB-59-DT
- FBB-59G-DT
- FBB-59S-DT
- FBB-59SG-DT



Item # \_\_\_\_\_

### Standard Features

- Our Back Bar units is designed with durability and strength along with feature rich standards uncommon in the industry today.
- Individually controlled dual temperature systems. Options available: White wines / Red wines, Beer / White wines, Beer / Red wines.
- Refrigeration system is a free flowing air system throughout the box to ensure "COLD" products at all times with a side mount evaporator system.
- Heavy duty 18 gauges stainless steel top, durable stainless steel covered corner floor and reinforced bottom door frame to protect your long term investment.
- Unit comes standard 2 flat shelves per door.
- Field interchangeable doors from Solid to Glass or Glass to Solid to adapt to ever changing needs.
- Units come with compressor mounted on the left side with service friendly slide out rail system.
- Incandescent interior light per door underneath the mullion to protect itself from normal operations and brightly shine and keep the light on your bottles.
- NSF approved for bottle and pre packed goods.



FBB-59-DT



FBB-59S-DT

### Options & Accessories

- 3" castors with reinforced rail
- 6" Adjustable stainless steel legs.
- Additional flat shelves
- Stainless steel wine rack shelves
- Wire wine rack shelves
- 220 volts / 50 cycles / 1 phase



\* Conforms to UL & NSF-7 standards

ISO-9001

Dual Temp	Model	Doors	Wine	Shelves	Amps	HP	Voltage	NEMA Plug	Cabinet Dimensions			Shipping	
									L	D*	H	(Wt. Cubes)	
	FBB-59(S)-DT	2	42	4	6.9	1/3	115	5-15P	59" (1498.6 mm)	28" (710 mm)	37" (939.8 mm)	343 (156 kg)	51 (1.44 m³)
	FBB-59(S)(G)-DT	2	42	4	6.9	1/3	115	5-15P	59" (1498.6 mm)	28" (710 mm)	37" (939.8 mm)	343 (156 kg)	51 (1.44 m³)

\*Depth does not include 1" bumper

# Specifications Dual Temp Back Bar

## Construction

Heavy duty stainless steel top, 18 gauge. Black vinyl front, sides and back. (S) Models have stainless steel front and sides. Galvanized back panel. Interior constructed of heavy duty galvanized steel walls with coved corner NSF approved stainless steel floor.

Door is comprised of heavy duty black vinyl steel. (S) Models are stainless steel. (G) Models are a dual pane glass with black frame, (SG) models are a dual pane glass with aluminum frame. Provided with locks per door, magnetic door gaskets, removable without tools. Door openings have a plastic breaker strips to retard condensate formation. Unit comes complete with a 1-1/2" CFC-Free polyurethane insulation, foamed in place.

## Refrigeration System

Self-contained capillary tube system using environmentally friendly (CFC Free) R-134a refrigerant. Front breathing compressor on left side for built-in applications. Evaporator coil is mounted to interior left side above the compressor. Large fan motor and fan blades for greater air flow. Automatic condensate evaporator, no drain connection required. Evaporator condensate has been plumbed to a condensate pan located in the compressor housing.

Access for the condensing unit behind the front grill, slides out for easy cleaning and maintenance.

Cabinets are designed to have the colder compartment on the left and warmer on the right. Temperatures range from 33° F to 60° F depending on the setting.

## Lights

Interior fluorescent light underneath the mullion.

## Shelving

Two adjustable epoxy coated shelves provided per door standard.

## Others

Unit is supplied standard with an 8' cord and plug (Nema 5-15p).

## Warranty

(24) month labor and parts warranty. 5 year compressor warranty (Continental U.S.A. & Canada only).

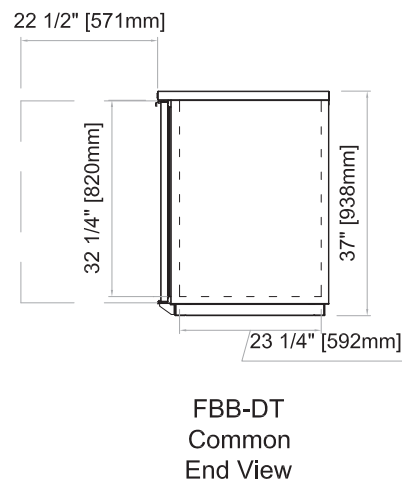
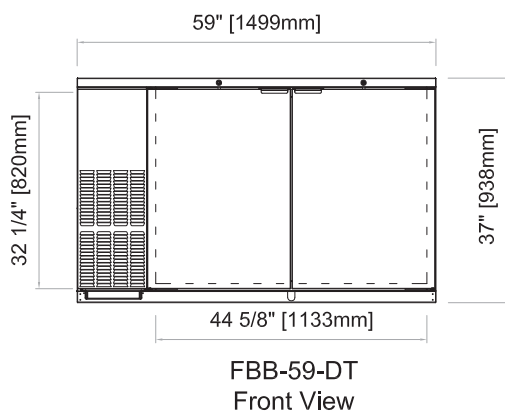
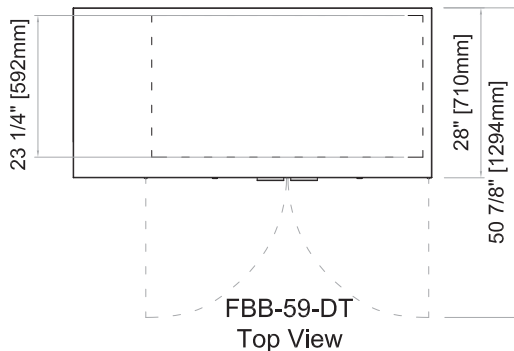

The manufacturer reserves the rights to modify materials and specifications without notice.

Printed in the USA • 09/12