



a Standex company

ITEM: _____ PROJECT NAME: _____ DATE: _____

SQ MARKET DELI REFRIGERATED CORNER CASES SERVICE AND SELF-SERVE

- MODEL** **SQROC90** **SQROC45R**
 SQROC90SS **SQROC45SSR**
 SQRIC90 **SQRIC45**
 SQRIC90SS **SQRIC45SS**



Market Deli. The low-profile merchandiser that provides solutions to your fresh food merchandising needs. Corner Cases are available in 45° and 90°, inside and outside, service and self-serve. Designed for continuous case line-ups without middle end glass.

STANDARD FEATURES

- Lift-up pneumatic, cylinder-assisted curved front glass.
- Four-point leveling system.
- Rear work counter.
- Octron case lighting.
- Pedestal or panel base design.
- Tempered front and end glass.
- Stainless steel interior and exterior finish.
- Solid-state controls.
- Condensate evaporator provided on self-contained systems. Remote refrigeration available.
- Average case temperature of 36° to 38° F is maintained.
- Oversized coil and low-velocity fan system maintains product freshness and high humidity.
- Coated evaporator coil.
- UL & UL Sanitation Listed.
- Designed for continuous line-ups.

SQ MARKET DELI™ REFRIGERATED CORNER CASES

OPTIONAL ACCESSORIES:

- Special Case Height (50" or 52")
- Front Bumper Rail
- (Black, White, Green, Gray)
- Reflective End Glass (Service Case Only)
- Remote Refrigeration
- Scale Stand
- Top Service Shelf (Service Case Only)
- Humidity Control (Service Case Only)
- Accent Base Light
- Slicer Stand
- Promolux Lighting
- Non Glare Glass
- Mezzanine Shelf, Lighted (For Non-Refrigerated Product – Service Case Only)
- Cord & Plug (NEMA 5-15P SQROC Models & SQRIC45, NEMA 5-20P SQRIC90 Models)

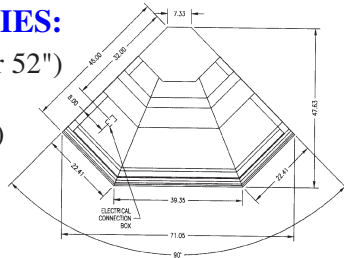

TOP VIEW
SQROC90

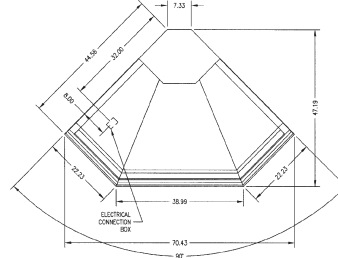

TOP VIEW
SQROC90SS

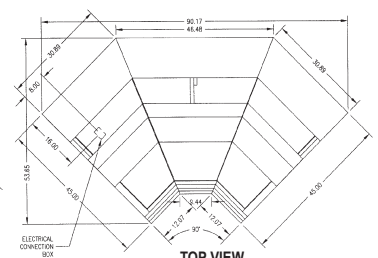

TOP VIEW
SQRIC90

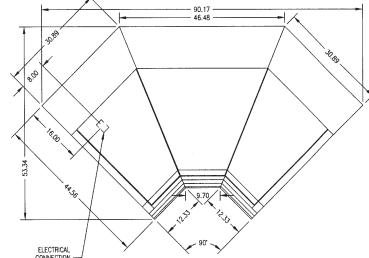

TOP VIEW
SQRIC90SS

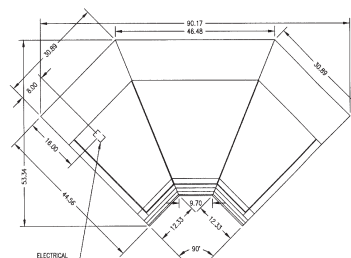

TOP VIEW
SQROC90

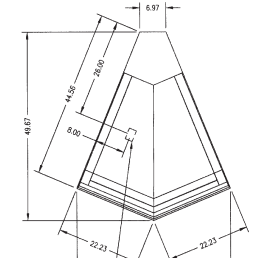

TOP VIEW
SQROC45R

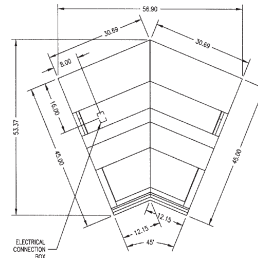

TOP VIEW
SQRIC45R

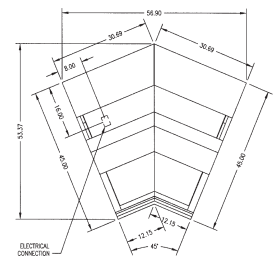

TOP VIEW
SQRIC45SSR

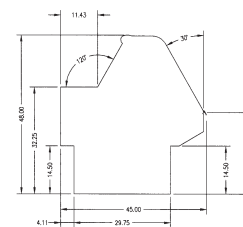

SIDE VIEW
Service Case

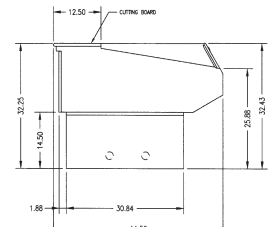

SIDE VIEW
Self-Serve Case

SPECIFICATIONS:

| Model | *Dimensions | | | Self-Contained 120/60/1 | Remote 120/60/1 |
|------------|-------------|-----------|-----------|----------------------------|--------------------|
| | L | W | H | | |
| SQROC90 | 47 3/4" | x 71 1/2" | x 48" | 1/2 HP - 11.5 AMPS | 6 AMPS |
| SQROC90SS | 47 3/4" | x 71 1/2" | x 32 1/4" | 1/2 HP - 11.5 AMPS | 6 AMPS |
| SQRIC90 | 53 3/4" | x 90 1/4" | x 48" | 1/2 HP - 13.8 AMPS | 7 AMPS |
| SQRIC90SS | 53 1/2" | x 90 1/4" | x 32 1/4" | 1/2 HP - 13.8 AMPS | 7 AMPS |
| SQROC45R | 50 1/4" | x 41 1/2" | x 48" | - | 6 AMPS |
| SQROC45SSR | 50 1/4" | x 41 1/2" | x 32 1/4" | - | 6 AMPS |
| SQRIC45 | 53 1/2" | x 57" | x 48" | 1/2 HP - 11.5 AMPS | 6 AMPS |
| SQRIC45SS | 53" | x 57" | x 32 1/4" | 1/2 HP - 11.5 AMPS | 6 AMPS |

*Without decorative end panel.

- Outside 45° corners available as remote models only
- **When ordering, specify case line-up and pedestal or panel design.**
- If a GFCI circuit is required, a GFCI Breaker Must be used instead of GFCI receptacle.
- Cases are designed to operate in a maximum environment of 75° ambient and 55% relative humidity.
- Due to continuing engineering improvements, specifications are subject to change without notice.



Look to Federal for Innovative Merchandising



The Signature of Quality

FEDERAL INDUSTRIES
A Standex Company

215 FEDERAL AVENUE, BELLEVILLE, WISCONSIN 53508-9201

PHONE: 800-356-4206

EMAIL: geninfo@federalind.com

FAX: 608-424-3234

WEBSITE: www.federalind.com

