

APPLICATION:

PRODUCT NAME:

STAINLESS STEEL DIPPERWELL FAUCET  
& SINK ASSEMBLY

JOB NAME:

☐ SPECIAL CONFIGURATION  
CHECK BASE MODEL AND OPTIONS

QUANTITY:

ITEM NO.

MODEL:

☐ 13838

OPTIONS OR MODIFICATIONS:

☐ OTHER \_\_\_\_\_

FEATURES:

DIPPERWELL FAUCET

\* STAINLESS STEEL SEAT

DIPPERWELL SINK

\* STAINLESS STEEL PAN

\* REMOVABLE INNER SHELL

SYSTEM LIMITS

\* TEMP: 40°F MIN. TO 140°F MAX.

\* PRESSURE 200 PSI MAX. STATIC

SHIPPING WEIGHT

\* 3.5 LBS

\* NSF 61-9 APPROVED &amp; LISTED

www.truesdail.com

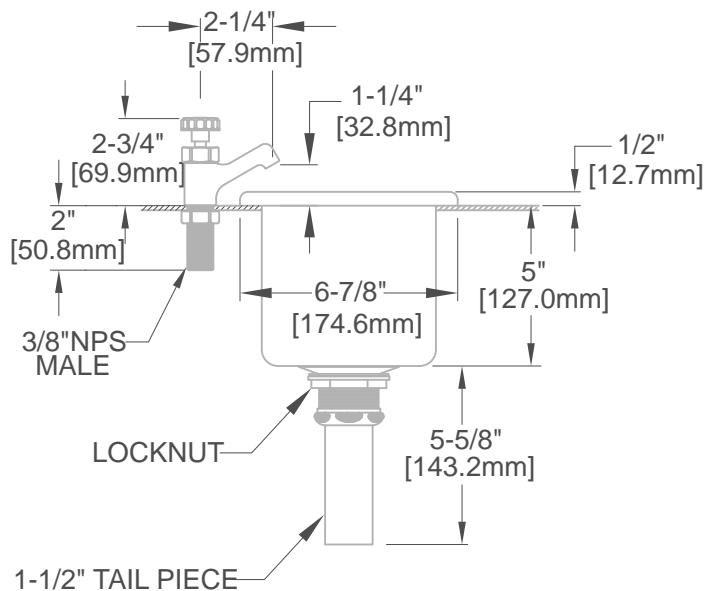

ROUGH-IN:

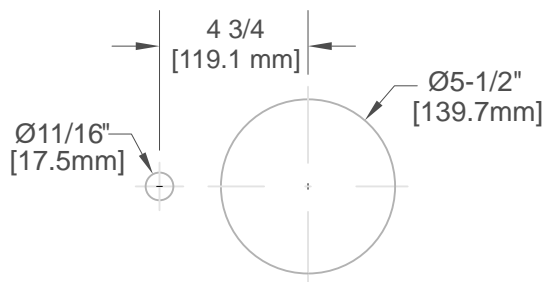

ANSI/A112.18.1M

**FISHER**

FISHER MANUFACTURING COMPANY

TOLL FREE: 800-421-6162 - FAX: 800-832-8238

information@fisher-mfg.com - www.fisher-mfg.com