

**APPLICATION:**

**JOB NAME:**

**QUANTITY:**                      **ITEM NO.**

**PRODUCT NAME:**  
 PRE-RINSE, SWIVEL STYLE,  
 SINGLE DECK MOUNT

\_\_\_\_\_ **SPECIAL CONFIGURATION**  
 CHECK BASE MODEL AND OPTIONS

**MODEL:**

2011            **ULTRA SPRAY VALVE NO WALL BRACKET**

2011-WB      **ULTRA SPRAY VALVE W/ WALL BRACKET**

**OPTIONS OR MODIFICATIONS:**

SUPPLY LINES (24" OR 36") CIRCLE LENGTH

ADD-ON FAUCET (6", 8", 10", 12", 14", 16") CIRCLE

IN-LINE DUAL CHECK VALVE

PIPE HOOK

BRUSH

HANDLES (CROSS OR WRIST) CIRCLE STYLE

VANDAL RESISTANT KIT

OTHER \_\_\_\_\_

**FEATURES**

**CONTROL VALVE**

- \* SINGLE DECK MOUNT
- \* TEMPERATURE CONTROL VALVE WITH INTERNAL SPRING LOADED CHECK VALVES
- \* STEM - LEFT HAND
- \* HOT AND COLD INDEX BUTTONS
- \* SWIVELLING SEAT DISK
- \* STAINLESS STEEL SEAT
- \* STAINLESS STEEL SEAT SCREW
- \* STAINLESS STEEL HANDLE SCREW

**HOSE**

- \* 15-1/2" LENGTH
- \* STAINLESS STEEL END FITTINGS
- \* STAINLESS STEEL EXTERNAL JACKET
- \* 3-PLY FIBER REINFORCED INTERNAL RUBBER HOSE
- \* REPAIRABLE IN-FIELD WITH SIMPLE TOOLS

**ULTRA SPRAY VALVE**

- \* LOWEST ENERGY USER - 1.15 GPM @ 60 PSI
- \* CLEANS FASTER - TEST PROVEN
- \* ENGINEERED TO LAST - NO 'O' RINGS TO LEAK
- \* INTERCHANGEABLE - FITS ALL BRANDS

**SYSTEM LIMITS**

- \* TEMP: 40°F MIN. TO 140°F MAX.
- \* PRESSURE: 200 PSI MAX. STATIC

**SHIPPING WEIGHT**

- \* 12.0 LBS

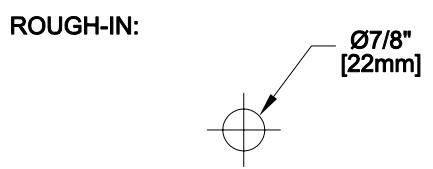
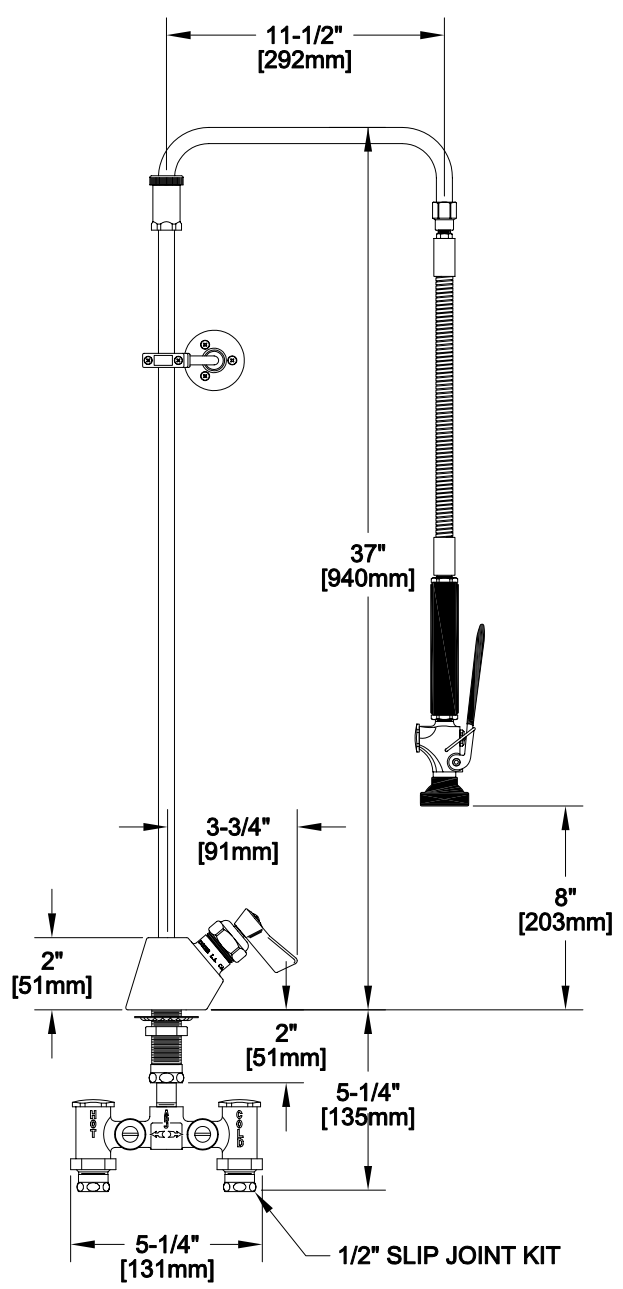

**FISHER**  
 FISHER MANUFACTURING COMPANY  
 TOLL FREE: 800-421-6162 - FAX: 800-832-8238  
 information@fisher-mfg.com - www.fisher-mfg.com