

PRODUCT NAME:

SINGLE DECK POT FILLER W/SHUT-OFF

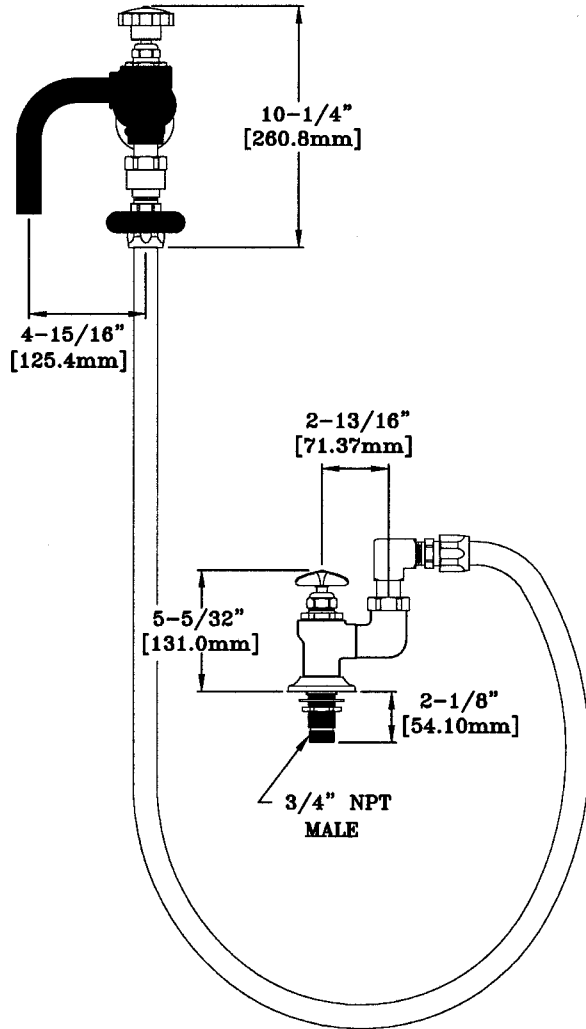

_____ SPECIAL CONFIGURATION
(CHECK BASE MODEL AND OPTIONS)

MODEL:

2291

OPTIONS OR MODIFICATIONS:

- VANDAL RESISTANT KIT
 HANDLES (LEVER OR WRIST) CIRCLE STYLE
 OTHER _____

FEATURES:

- * SINGLE DECK
- * STEM - LEFT HAND
- * HOT & COLD INDEX BUTTONS
- * SWIVELLING SEAT DISKS
- * STAINLESS STEEL SEATS
- * STAINLESS STEEL SEAT SCREWS
- * STAINLESS STEEL HANDLE SCREWS

HOSE

- * 72" LG. HEAT MASTER FDA NITRILE/ARAMID
- * NSF-51 (100 PSI W.P. @ 300°F) CONSTANT
- * RENEWABLE END FITTINGS & BUMPER
- * 360° SWIVEL POT FILLER SPOUT
- * NONMARRING POT FILLER SPOUT
- * SHUT-OFF SPOUT
- * 360° SWIVEL ELBOW

RECOMMENDED SETTINGS

- * 110°F AT 80 PSI

SYSTEM LIMITS

- * TEMP: 40°F MIN. TO 140°F MAX.
- * PRESSURE 200 PSI MAX. STATIC
- * 29 GPM @ 80 PSI

SHIPPING WEIGHT

- * 15.0 LBS

ROUGH-IN:

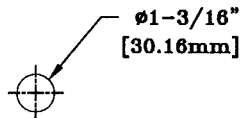

ANSI/A112.18.1M

FISHER MANUFACTURING COMPANY