

APPLICATION:

PRODUCT NAME:

CHINESE RANGE FAUCET

JOB NAME:

☐ _____ SPECIAL CONFIGURATION
(CHECK BASE MODEL AND OPTIONS)

QUANTITY:

ITEM NO.:

MODEL:

☐ 4750

OPTIONS OR MODIFICATIONS:

- ☐ SUPPLY LINES (24" OR 36") CIRCLE LENGTH
☐ DJ SUB-ASSY (7-1/4" OR 13") CIRCLE LENGTH
☐ ELBOWS
☐ VANDAL RESISTANT KIT
☐ HANDLES (CROSS OR WRIST) CIRCLE STYLE
☐ OTHER _____

FEATURES:

- * SINGLE WALL BACKSPLASH MOUNT
- * SWIVELING SEAT DISKS
- * STEM - RIGHT HAND
- * STAINLESS STEEL SEAT
- * STAINLESS STEEL SEAT SCREW
- * STAINLESS STEEL HANDLE SCREW
- * HOT & COLD INDEX BUTTONS
- * 1/2" SLIP JOINT KIT

SYSTEM LIMITS

- * TEMP: 40°F MIN. TO 140°F MAX.
- * PRESSURE 200 PSI MAX. STATIC
- * 2.20 GPM AT 80 PSI

SHIPPING WEIGHT

- * 3.0 LBS

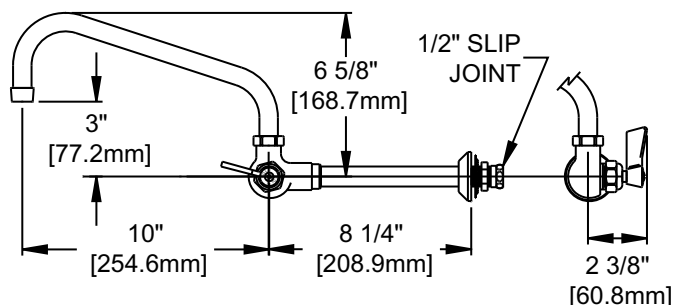

ROUGH-IN:

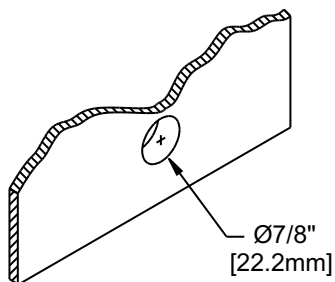

ANSI/A112.18.1M, ANSI/NSF 61.9

FISHER

FISHER MANUFACTURING COMPANY
 TOLL FREE: 800-421-6162 - FAX: 800-832-8238
 information@fisher-mfg.com - www.fisher-mfg.com