

HORIZON

Superior technology

Delivering value and reliability





Flexibility



Technology and Reliability

RIDE® technology

The only solution where the ice machine can be installed up to 75 ft (23 m) away from the dispenser.

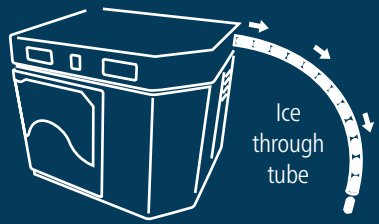

Horizon™ ice machine

UP TO
75FT
AWAY

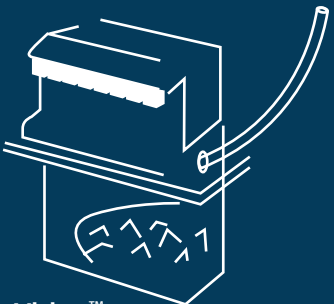

Vision™ ice and beverage dispensers



Countertop ice and beverage dispensers

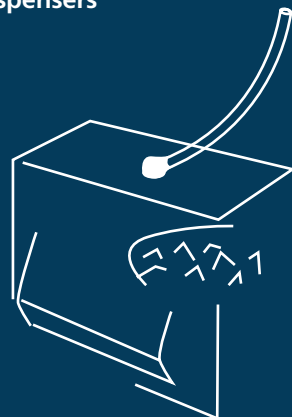

Follett ice storage and transport equipment

Horizon ice machine family

- Attractive, contemporary design complements all applications
- Four capacities, 700, 1000, 1400 & 1650 lb per 24 hr of Chewblet® ice
- RIDE technology – up to 75 ft (23 m) away
- Horizon evaporator provides maximum ice production capacity with minimum operating loads, longer life, lower energy consumption

Aluminum bronze evaporator

- Twice as conductive as stainless steel; requires less refrigerated surface area than competitors' comparable capacity machines
- Contains inherent anti-microbial properties to reduce the risk of contamination
- Corrosion resistant – stands up to the most aggressive water
- No refrigerant tubing, solder or air gaps
 - 40% less distance for heat transfer for greater efficiency
 - eliminates progressive capacity loss due to trapped moisture between the evaporator and refrigerant tubing

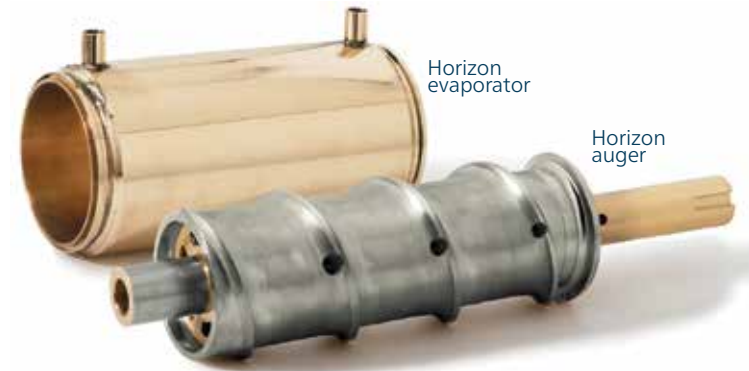

Horizon evaporator

Horizon auger

Auger design

- Patented flite design cleanly cuts ice film off the inner wall of the evaporator with minimal thrust loading
- Advanced design reduces icemaking loads by over 80%
- Water enters the hollow core of the auger and flows through irrigation holes to the inner surface of the evaporator, ensuring that water contacts all of the refrigerated area of the evaporator, maximizing capacity

PC board

Designed with color coded lights and specific signals for instant status update. Advanced on-board system controls monitor operation to prevent serious component failure.



Automatic self-flushing feature

- Removes mineral-laden water and impurities for better tasting ice, less maintenance and increased reliability
- Built-in drain pan is accessible from front of ice machine for cleaning
- Drain sensor shuts down flush cycle (to prevent overflow) if drain is clogged



Gearbox and motor assembly

- Compact, quiet, energy efficient design
- One-piece gearbox design ensures perfect gear alignment for long life
- Grease-filled, sealed for life; no preventive maintenance required
- No bearings to inspect or replace

Water reservoir

- High and low water sensors control evaporator water level for consistent ice capacity and quality
- Sealed water system; no exposed water for entry of airborne bacteria
- Inhibits the formation of molds and slime in the ice machine



Note: Cut away to show detail



Technology and Reliability

Horizon ice machine family

- Attractive, contemporary design complements all applications
- Four capacities, 700, 1000, 1400 & 1650 lb per 24 hr of Chewblet® ice
- RIDE technology – up to 75 ft (23 m) away
- Horizon evaporator provides maximum ice production capacity with minimum operating loads, longer life, lower energy consumption

Aluminum bronze evaporator

- Twice as conductive as stainless steel; requires less refrigerated surface area than competitors' comparable capacity machines
- Contains inherent anti-microbial properties to reduce the risk of contamination
- Corrosion resistant – stands up to the most aggressive water
- No refrigerant tubing, solder or air gaps
 - 40% less distance for heat transfer for greater efficiency
 - eliminates progressive capacity loss due to trapped moisture between the evaporator and refrigerant tubing

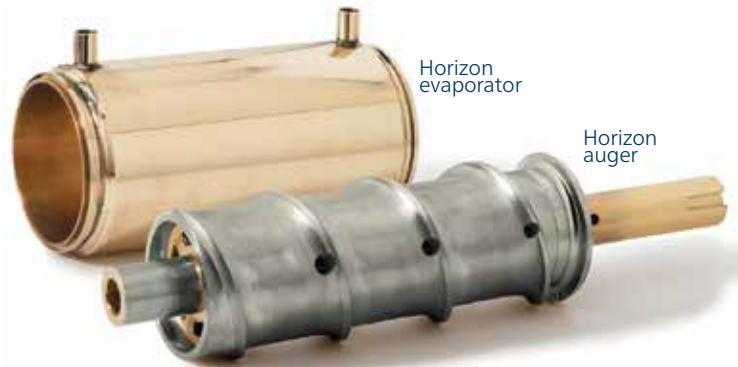

Horizon evaporator

Horizon auger

Auger design

- Patented flite design cleanly cuts ice film off the inner wall of the evaporator with minimal thrust loading
- Advanced design reduces icemaking loads by over 80%
- Water enters the hollow core of the auger and flows through irrigation holes to the inner surface of the evaporator, ensuring that water contacts all of the refrigerated area of the evaporator, maximizing capacity



PC board

Designed with color coded lights and specific signals for instant status update. Advanced on-board system controls monitor operation to prevent serious component failure.



Automatic self-flushing feature

- Removes mineral-laden water and impurities for better tasting ice, less maintenance and increased reliability
- Built-in drain pan is accessible from front of ice machine for cleaning
- Drain sensor shuts down flush cycle (to prevent overflow) if drain is clogged

Gearbox and motor assembly

- Compact, quiet, energy efficient design
- One-piece gearbox design ensures perfect gear alignment for long life
- Grease-filled, sealed for life; no preventive maintenance required
- No bearings to inspect or replace

Water reservoir

- High and low water sensors control evaporator water level for consistent ice capacity and quality
- Sealed water system; no exposed water for entry of airborne bacteria
- Inhibits the formation of molds and slime in the ice machine



Note: Cut away to show detail



Cleaning made simple

Semi-automatic cleaning and sanitizing

Streamlines cleaning process; easy for in-store personnel to perform, just three easy steps.

Ice machine cleaning

1. Remove the front cover of the machine.
2. Press the clean button. Wait for LO WATER light to come on.

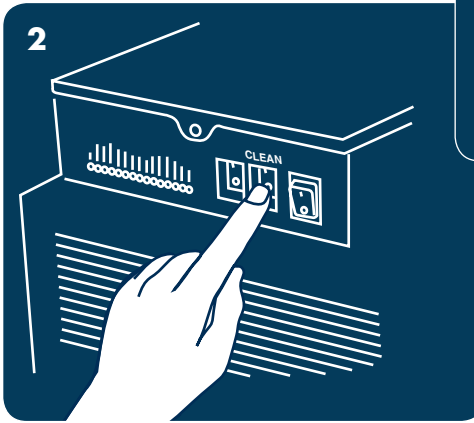
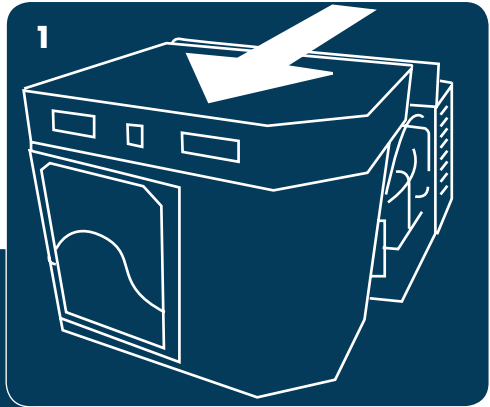

3. Fill cleaning cup with ice machine cleaner until HI WATER light comes on. **The ice machine does the rest!**

The auger rotates in the evaporator for 5 minutes to circulate the cleaning solution. After automatically draining the solution, the evaporator refills with fresh water. The water is circulated for 2 minutes and then drained. The "rinse" cycle is repeated two more times to ensure that all the ice machine cleaner is flushed out.

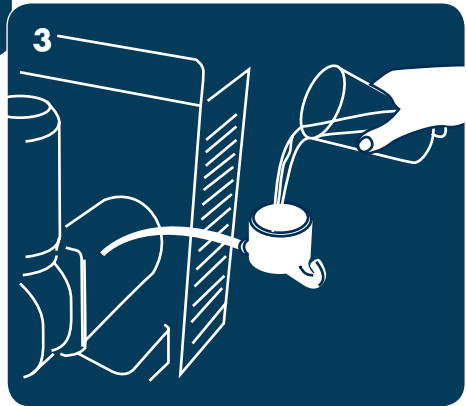

Ice machine sanitizing

Repeat above procedure with ice machine sanitizer.

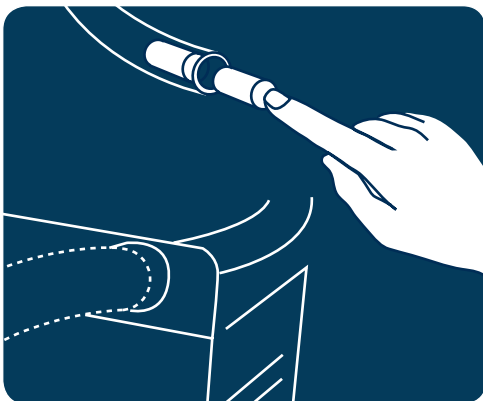

Transport tube sanitizing

The ice transport tube is easy to sanitize, too, using Follett SaniSponges™. Disconnect the tube coupling and insert a dry sponge into the ice transport tube, followed by a sponge soaked in ice machine sanitizer. Reconnect the coupling and turn on the machine. As ice is harvested, it will push the sponges through the ice transport tube to sanitize it.

Catch the sponges and a small amount of ice – sanitizing is complete!

Green technology

Follett Chewblet ice machines consume less water and electricity than comparable size cube-type machines. The Horizon series employs advanced technology and design features to provide superior utility performance. Horizon machines consume up to 30% less water than comparable size cube ice machines and meet the California Energy Commission (CEC) guidelines for energy efficiency. Most Horizon ice machines are ENERGY STAR® certified. Visit our website for an updated list of qualified models.

- Continuous harvesting of a thin layer of ice optimizes energy use – no disruption of refrigeration cycle
- Cycle is never reversed and additional energy to remove ice is never required
- All water is consumed to make ice except a few gallons a day for flushing the evaporator

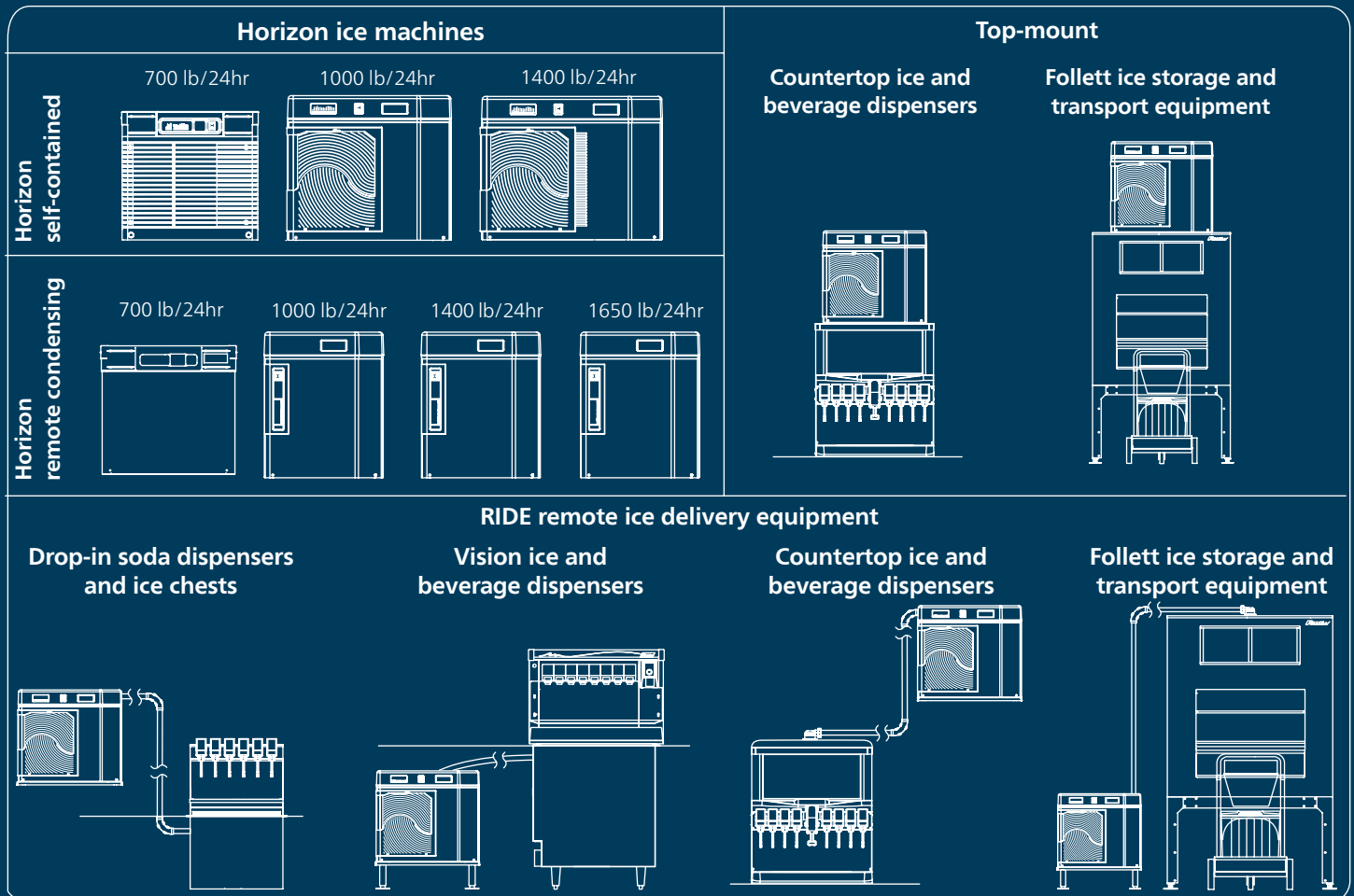
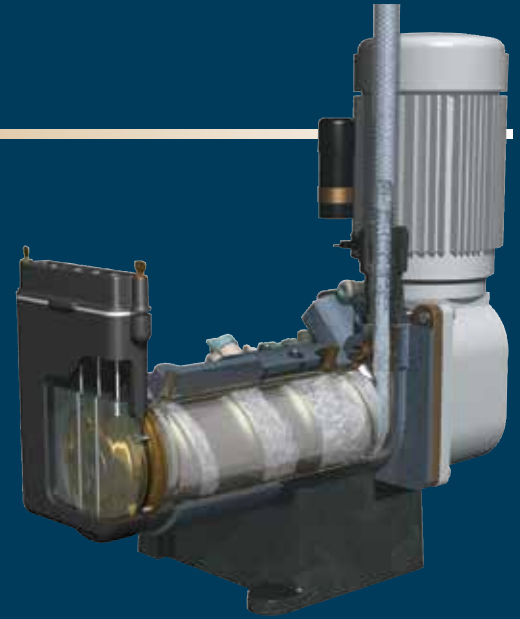

Warranty – 3 years parts and labor on all components, 5 years parts on compressor

ENERGY STAR and the ENERGY STAR mark are registered US marks.
 Horizon, SaniSponge and Vision are trademarks of Follett Corporation.
 Chewblet, Follett and RIDE are registered trademarks of Follett Corporation, registered in the US.