

# TOMATO SQUEEZERS



2121



Big45



Big75



8502N

## MODEL 2121 / BIG 45 / BIG 75 / 8502N

These models enable the extraction of large quantities of tomato puree, separating it from seeds and skin. With their high power motors, the Big 45 and Big 75 are ideal for those who require performance. The hopper, collector, and base are stainless steel, the worm and body are cast iron with double hot tinning. The 2121 is the perfect model for any home or light production application. The 8502N is available for those not requiring a motorized unit.

Model	Description	HP	Worm RPM	Electrical	Weight	Dimensions (LWH)	Item #
2121	Electric	0.25	110	110V/60/1	22 lbs.	19.75" x 6" x 13"	11001
Big 45	Electric	0.45	150	110V/60/1	37 lbs.	25.5" x 10.75" x 17.75"	11040
Big 75	Electric	0.60	82	110V/60/1	44 lbs.	24.5" x 11.75" x 18.75"	11041
8502N	Manual	-----	-----	-----	14 lbs.	10.75" x 14.13" x 19.5"	21105

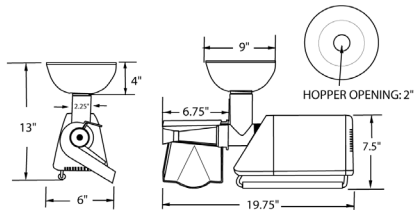

Model 2121

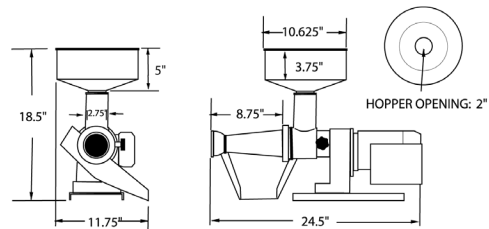

Model Big 75

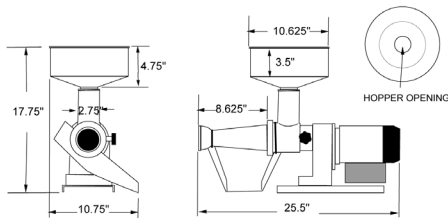

Model Big 45

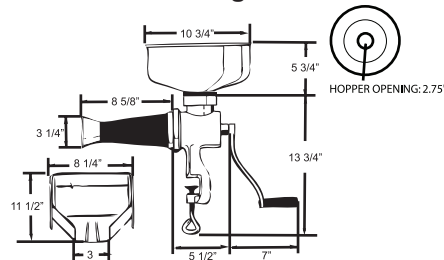

Model 8502N



**OMCAN INC.**  
**Food Machinery of America Inc.**

Email: [sales@omcan.com](mailto:sales@omcan.com) ♦ Phone: 1.800.465.0234 or 905.828.0234 ♦ Fax: 905.607.0234