



## HYDRAULIC SAUSAGE STUFFERS

### Model H15P / H26P / H52P

The machines come with extra power, automatic piston decompression, independent oil reservoir, spare lid seal, oil, piston extracting wrench, and three stainless steel spouts (12mm, 20mm, and 30mm). The piston provides a perfect seal, and is removable for cleaning.



High pressure hydraulic group. Independent oil reservoir



Equipped with wheels, pressure gauges, and waterproof electric switchboards.

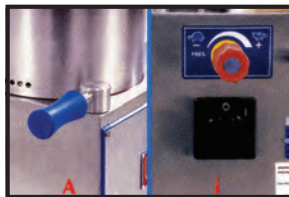

Turn on/off motor automatically by knee lever or manual switch



Removable sealed piston. Ergonomically designed for comfort.



Optional: Manual portioning device. Curved nozzle/horn with cutting valve to fill cans.



Mississauga, Ontario, Canada

Niagara Falls, New York, USA

Tel: (905) 828-0234 Toll-Free: 1-800-465-0234 Fax: (905) 607-0234 Email: sales@omcan.com

www.omcan.com



## HYDRAULIC SAUSAGE STUFFERS

Model	HP	Capacity	Electrical	Weight	Packaging Weight	Item #	Packaging Dimensions
H15PA	0.75 HP	33 lbs.	220V/60/3	± 223 lbs	254 lbs.	13743	21" x 23" x 47"
H15PAM	1.75 HP	33 lbs.	220V/60/1	± 223 lbs	254 lbs.	13744	21" x 23" x 47"
H20PA	0.75 HP	44 lbs.	208V/60/3	± 231.5 lbs	260 lbs.	13745	26" x 23" x 56"
H20PAM	1.75HP	44 lbs.	220V/60/1	± 231.5 lbs	260 lbs.	13746	26" x 23" x 56"
H26PA	1.5 HP	57 lbs.	208V/60/3	± 289 lbs	313 lbs.	13750	22" x 24" x 56"
H26PAS	1.5 HP	57 lbs.	208V/60/3	± 289 lbs	313 lbs.	13752	22" x 24" x 56"
H26PAM	2.25 HP	57 lbs.	220V/60/1	± 289 lbs	313 lbs.	13751	22" x 24" x 56"
H26PASM	2.25 HP	57 lbs.	220V/60/1	± 289 lbs	313 lbs.	13753	22" x 24" x 56"
H31PAS	2 HP	68 lbs.	220V/60/3	± 315.25 lbs	350 lbs.	13755	22" x 24" x 56"
H31PASM	2.25 HP	68 lbs.	220V/60/1	± 315.25 lbs	350 lbs.	13756	22" x 24" x 56"
H42PAS	2.5 HP	92 lbs.	220V/60/3	± 527 lbs	594 lbs.	13757	25" x 30" x 56"
H42PASM	2.5 HP	92 lbs.	220V/60/1	± 527 lbs	594 lbs.	13758	25" x 30" x 56"
H52PAS	2.5 HP	114 lbs.	220V/60/3	± 610.7 lbs	662 lbs.	13759	26" x 29" x 59"
H52PASM	2.5 HP	114 lbs.	220V/60/1	± 610.7 lbs	662 lbs.	17146	26" x 29" x 59"

<b>P = economy</b>	Fixed and stronger rectified barrel (cylinder) with solid construction. Motor start and stop by contactor
<b>A = professional</b>	Less wear, noise and power consumption; lower temperature; longer life of oil; pump and hydraulic group; water proof, low voltage switchboard, 3 phase motor.
<b>M = HD</b>	Single Phase Motor-Heavy Duty
<b>S=Steel</b>	Stainless Steel Lid and Piston (opt. On H26-PA/S)

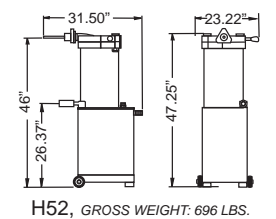
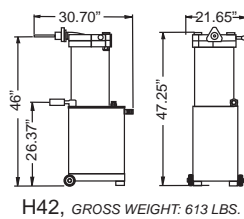
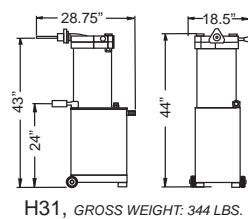
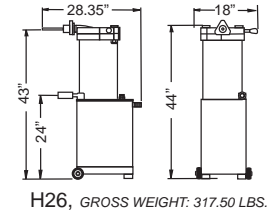
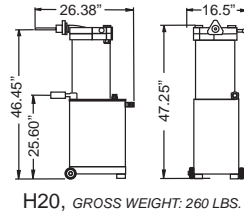
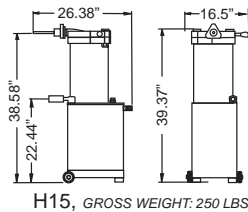

Mississauga, Ontario, Canada

Niagara Falls, New York, USA

Tel: (905) 828-0234 Toll-Free: 1-800-465-0234 Fax: (905) 607-0234 Email: sales@omcan.com

www.omcan.com