



CHAR-ROCK BROILER



MODEL TSEB-15C/ TSEB-24C Char-Rock Broiler

Stainless Steel: Front, sides and removable grease

Control Knobs: Durable, cool to the touch

Dip Tray: Full width dip pan removes for cleaning.

Cabinet Base: Stainless steel cabinet base with 6" chrome plated legs and adjustable feet.

BROILER

Burners: 38,000 BTU/hr. cast iron "H" type burners uniquely located.

One standing pilot burner for instant ignition. Stainless steel burner covers and pilot shield for maximum heat distribution.

TOP

Cooking Grates: 5" x 21" sections lift-off, heavy-duty

Grease Through: Removable grease can for easy cleaning

Crumb Tray: Full width crumb tray located under burners

Char Rock: Self-cleaning pumice rock. Lighter and longer lasting than other types of char-rock.

Lower Grates: Heavy-cast iron 8" x 15" waffle style grates support char-rock and promote proper air-flow and combustion.

Cleaning: No tools are needed to remove top and bottom grates, burners, char-rocks and interior liner.

Model	TSEB-15C	TSEB-24C
Total B.T.U.	38,000	76,000
Burners	1	2
Dimensions (DWH)	26" x 15" x 14.50"	26" x 24" x 14.50"
Packaging Weight	135 lbs.	142 lbs.
Item #	23408	23409

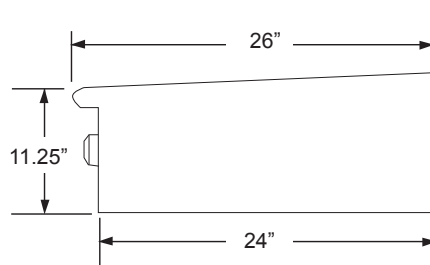
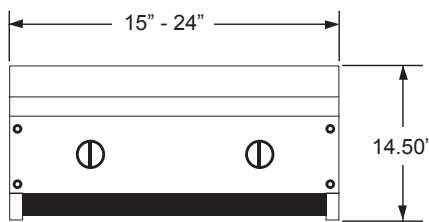

Mississauga, Ontario, Canada

Niagara Falls, New York, USA

Tel: (905) 828-0234 Toll-Free: 1-800-465-0234 Fax: (905) 607-0234 Email: sales@omcan.com

www.omcan.com