

F-801M_H

MODULAR FLAKER ICE MACHINE

SLIM-LINE SERIES

Item # _____

Project: _____

Qty: _____
 *AutoCad available on KCL

F-801M_H
 I/13
 Item # 13037

FLAKER DIMENSIONS

W x D x H

F-801M_H
 22 x 27^{3/8} x 25^{15/16}



B-300

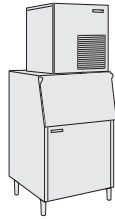

B-500

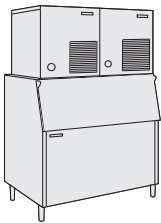

B-700

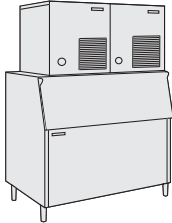

B-800

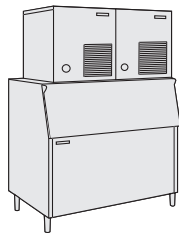

B-900

Also available on Large Bins:
 B-1150SS
 B-1300SS
 B-1500SS
 B-1650SS

FLAKED ICE DIMENSIONS



F-801MAH

Air-Cooled
 Shown on an optional
 B-500

F-801MWH

Water-Cooled

- Up to 795 lbs. of ice production per 24 hours
- Durable stainless steel exterior
- CleanCycle I2® Design 
- 15 minute flush cycle every 12 hours
- Removes sediment
- Cleaner ice
- Longer life and easy maintenance
- Removable air filters (Air-cooled model only)
- R-404A refrigerant

* The F-801MAH is ENERGY STAR qualified.

Warranty

Valid in United States, Canada, Puerto Rico, & U.S. Territories. Contact factory for warranty in other countries.

Three Year - Parts & Labor on entire machine. (Serial numbers Vxxxxxj and after.)

Five Year - Parts on Compressor; air-cooled condenser coil.



ISO9001-15014E01



Hoshizaki

F-801M_H FLAKER ICE MACHINE SLIM-LINE SERIES

DIMENSIONS
W x D x H
F-801M_H
22 x 27^{3/8} x 25^{15/16}

- Air-cooled
- Water-cooled

AIR-COOLED

Water Temp° F.	50°	70°	90°
Air Temp° F. 70°	795	756	725
Air Temp° F. 80°	696	667	640
Air Temp° F. 90°	614	594	565

WATER-COOLED

Water Temp° F.	50°	70°	90°
Air Temp° F. 70°	663	638	624
Air Temp° F. 80°	610	596	582
Air Temp° F. 90°	569	560	543

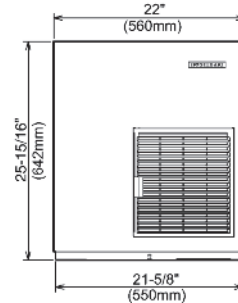

FRONT VIEW

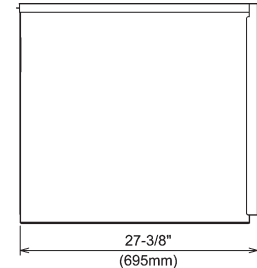

SIDE VIEW

UTILITY CONSUMPTION

Model Number	Approx. Elec. Watts		KWH per 100 LBS.		Potable Water Gal. per 100 lbs.	Cond. Water Gal. per 100 lbs.	
	90/70	70/50	90/70	70/50		90/70	70/50
F-801MAH	1028	958	4.21	2.90	12.0	N/A	N/A
F-801MWH	941	945	3.97	3.42	12.0	61	34

SPECIFICATIONS

Model Number	Condenser	Amperage	Min. Circuit Ampacity	Shipping Weight
F-801MAH	Air-Cooled	11.4	20	205 lbs.
F-801MWH	Water-Cooled	10.5	20	205 lbs.

STORAGE BINS

Model Number	Application Capacity	ARI-Rated Capacity
B-300	300 lbs.	260 lbs.
B-500	500 lbs.	360 lbs.
B-700	700 lbs.	550 lbs.
B-800	800 lbs.	600 lbs.
B-900	900 lbs.	660 lbs.
B-1150	1150 lbs.	N/A
B-1300	1275 lbs.	N/A
B-1500	1490 lbs.	N/A
B-1650	1605 lbs.	N/A

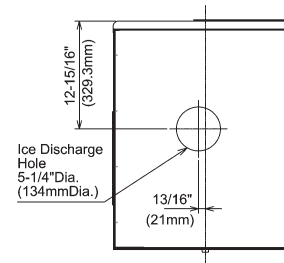

ICE DROP ZONE

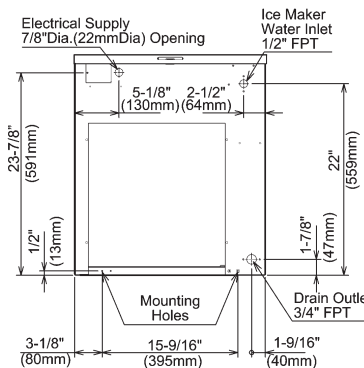

AIR-COOLED UNIT

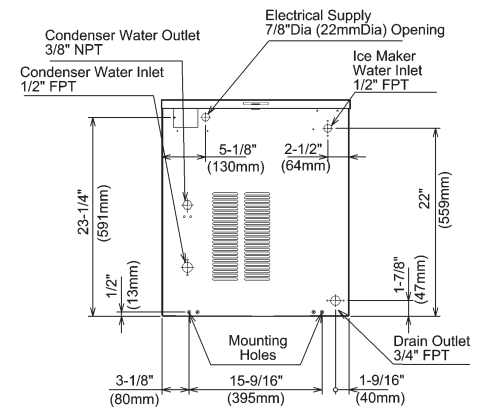

WATER-COOLED UNIT

ELECTRICAL & PLUMBING/F-801M_H

- 115-120V/60/1
- 20 amp Max Fuse/HACR Breaker Size
- 3/8" OD copper or equivalent independent water supply
- 3/4" FPT independent drain connection



NSF c UL US LISTED

ISO 9001 | ISO 14001

© HOSHIZAKI AMERICA, INC.

618 Hwy. 74 S., Peachtree City, GA 30269

OPERATING LIMITS

- Ambient Temp Range 45 - 100°F
- Water Temp Range 45 - 90°F
- Water Pressure 10 - 113psig
- Voltage Range 104 - 127V

SERVICE

- Panels easily removed and all components accessible for service.
- Removable/cleanable air filter (Air-Cooled model only)

TEL 1-800-438-6087

FAX 1-800-345-1325

www.hoshizaki.com

Printed in U.S.A.

