

# KM-1601S\_H(3)

## STACKABLE CRESCENT CUBER

Item # \_\_\_\_\_

Project: \_\_\_\_\_

Qty: \_\_\_\_\_  
 \*AutoCad available on KCL

KM-1601S\_H(3)  
 1/13  
 Item # 13204

### CUBER DIMENSIONS

W x D x H

**KM-1601S\_H(3)**  
 48 x 27<sup>3/8</sup> x 27<sup>3/8</sup>

### CONDENSING UNIT DIMENSIONS

W x D x H

**Installation Dimensions**  
**URC-22F**  
 48<sup>7/16</sup> x 18<sup>1/8</sup> x 40<sup>7/8</sup>\*  
 \*with legs

**Actual Dimensions**  
**URC-22F**  
 46<sup>3/8</sup> x 15<sup>11/16</sup> x 25<sup>15/16</sup>

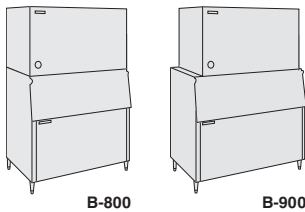

B-800 B-900

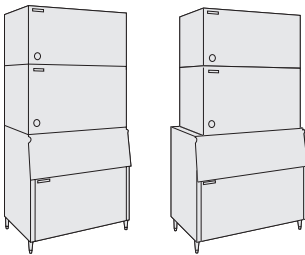

B-800 B-900

Also available on Large Bins:  
 B-1150SS  
 B-1300SS  
 B-1500SS  
 B-1650SS

### KM CUBE DIMENSIONS

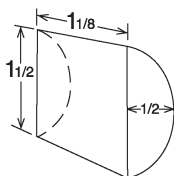

**KM-1601SAH**  
 Air-Cooled 1 Phase



**KM-1601SAH3**  
 Air-Cooled 3 Phase

**KM-1601SWH**  
 Water-Cooled 1 Phase

**KM-1601SWH3**  
 Water-Cooled 3 Phase

**KM-1601SRH**  
 Remote Air-Cooled 1 Phase

**KM-1601SRH3**  
 Remote Air-Cooled 3 Phase  
 Shown on an optional  
 B-900

- Up to 1555 lbs. of ice production per 24 hours
- Durable stainless steel exterior
- Individual crescent cube
- Protected by H-GUARD Plus Antimicrobial Agent 
- CycleSaver® Design 
- EverCheck® alert system 
- Stainless steel evaporator
- Stackable for 3170 lbs. of ice production in the same floor space
- R-404A Refrigerant

### Warranty

Valid in United States, Canada, Puerto Rico, & U.S. Territories. Contact factory for warranty in other countries.

**Three Year** - Parts & Labor on entire machine.

**Five Year** - Parts & Labor on: Evaporator.

**Five Year** - Parts on: Compressor, air-cooled condenser coil.



# KM-160IS\_H(3) STACKABLE CRESCENT CUBER

**DIMENSIONS**  
W x D x H  
**KM-160IS\_H(3)**  
48 x 27<sup>3/8</sup> x 27<sup>3/8</sup>

**Installation Dimension**  
**URC-22F**  
48<sup>7/16</sup> x 18<sup>1/8</sup> x 40<sup>7/8</sup>  
\*with legs

**Actual Dimension**  
**URC-22F**  
46<sup>3/8</sup> x 15<sup>11/16</sup> x 25<sup>15/16</sup>

### AIR-COOLED | PHASE / 3 PHASE

| Water Temp ° F. | 50°         | 70°                | 90°         |
|-----------------|-------------|--------------------|-------------|
| Air Temp ° F.   |             |                    |             |
| 70°             | 1462 / 1456 | 1427 / 1423        | 1307 / 1313 |
| 80°             | 1435 / 1431 | 1381 / 1381        | 1221 / 1234 |
| 90°             | 1427 / 1423 | <b>1343 / 1345</b> | 1198 / 1211 |

### WATER-COOLED | PHASE / 3 PHASE

| Water Temp ° F. | 50°         | 70°                | 90°         |
|-----------------|-------------|--------------------|-------------|
| Air Temp ° F.   |             |                    |             |
| 70°             | 1492 / 1555 | 1501 / 1558        | 1419 / 1466 |
| 80°             | 1499 / 1557 | 1513 / 1562        | 1378 / 1417 |
| 90°             | 1501 / 1558 | <b>1523 / 1565</b> | 1408 / 1440 |

### REMOTE AIR-COOLED | PHASE / 3 PHASE

| Water Temp ° F. | 50°         | 70°                | 90°         |
|-----------------|-------------|--------------------|-------------|
| Air Temp ° F.   |             |                    |             |
| 70°             | 1531 / 1530 | 1519 / 1521        | 1426 / 1414 |
| 80°             | 1522 / 1523 | 1503 / 1508        | 1368 / 1349 |
| 90°             | 1519 / 1521 | <b>1490 / 1498</b> | 1371 / 1359 |

### UTILITY CONSUMPTION

| Model Number             | Ice Production Per Cycle |       | KWH per 100 LBS. 90/70 | Potable Water Gal. per 100 lbs. | Condenser Water Gal. per 100 lbs. |
|--------------------------|--------------------------|-------|------------------------|---------------------------------|-----------------------------------|
|                          | Lbs.                     | Cubes |                        |                                 |                                   |
| KM-1601SAH               | 31.4                     | 1440  | 4.70                   | 17.0                            | N/A                               |
| KM-1601SAH3              | 32.5                     | 1440  | 4.65                   | 18.5                            | N/A                               |
| KM-1601SWH               | 30.2                     | 1440  | 3.8                    | 24.5                            | 98                                |
| KM-1601SWH3              | 30.2                     | 1440  | 3.66                   | 23.8                            | 100                               |
| KM-1601SRH with URC-22F  | 31.6                     | 1440  | 4.36                   | 23.6                            | N/A                               |
| KM-1601SRH3 with URC-22F | 32.1                     | 1440  | 4.46                   | 23.2                            | N/A                               |

### SPECIFICATIONS

| Model Number | Condenser         | Amperage | Min. Circuit Ampacity | Shipping Weight |
|--------------|-------------------|----------|-----------------------|-----------------|
| KM-1601SAH   | Air-Cooled        | 15.0     | 20                    | 315 lbs.        |
| KM-1601SAH3  | Air-Cooled        | 12.0     | 20                    | 315 lbs.        |
| KM-1601SWH   | Water-Cooled      | 13.4     | 20                    | 360 lbs.        |
| KM-1601SWH3  | Water-Cooled      | 9.0      | 20                    | 360 lbs.        |
| KM-1601SRH   | Remote Air-Cooled | 12.8     | 20                    | 350 lbs.        |
| KM-1601SRH3  | Remote Air-Cooled | 7.9      | 20                    | 350 lbs.        |

### STORAGE BINS

| Model Number | Application Capacity | ARI-Rated Capacity |
|--------------|----------------------|--------------------|
| B-800        | 800 lbs.             | 600 lbs.           |
| B-900        | 900 lbs.             | 660 lbs.           |
| B-1150       | 1150 lbs.            | N/A                |
| B-1300       | 1275 lbs.            | N/A                |
| B-1500       | 1500 lbs.            | N/A                |
| B-1650       | 1605 lbs.            | N/A                |

### ELECTRICAL & PLUMBING/KM-160IS\_H(3)

- 208-230V/60/1(3 wire with dedicated neutral for 115V) / (208-230/60/3)
- 20 amp Max Fuse/HACR Breaker Size
- 1/2" OD copper or equivalent independent potable water supply
- 3/4" FPT independent drain connection



© HOSHIZAKI AMERICA, INC.

618 Hwy. 74 S., Peachtree City, GA 30269

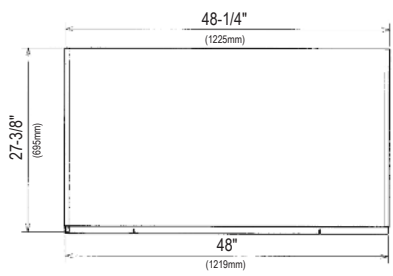

FRONT VIEW

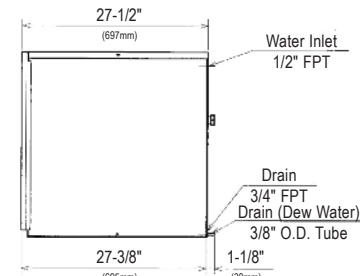

SIDE VIEW

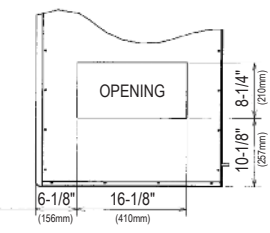

ICE DROP ZONE

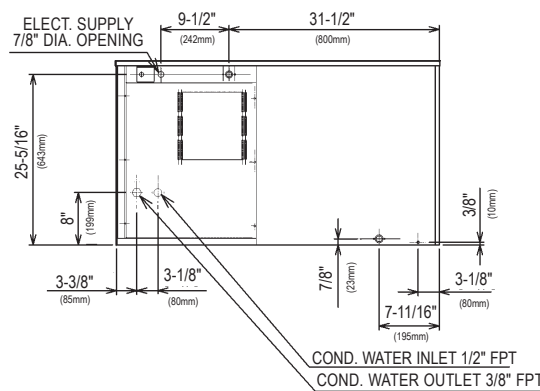

WATER-COOLED UNIT

URC-22F Remote Condensing Unit (Sold Separately)  
For Use with KM-1601SRH(3)

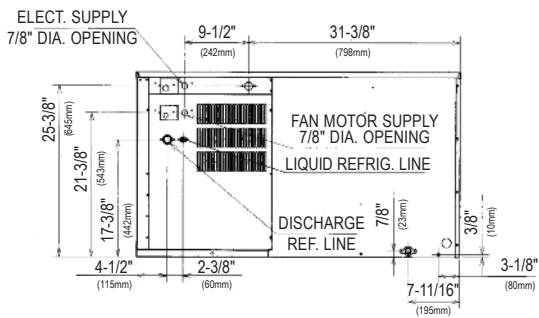

REMOTE AIR-COOLED UNIT

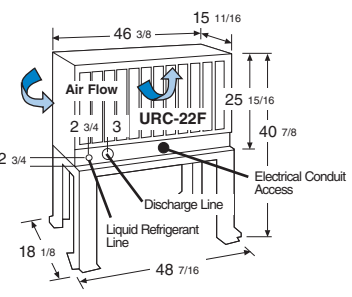

Pre-Charged Tubing Kit  
(Sold Separately)  
20' R404-20610  
35' R404-35610  
55' R404-55610

Voltage supply for the URC Remote Condenser is supplied from the Ice Maker. No additional circuit is required.

### OPERATING LIMITS

- Ambient Temp Range 45 - 100°F
- Water Temp Range 45 - 90°F
- Water Pressure 10 - 113psig
- Voltage Range 187 - 253V

### CONDENSING UNIT

- Voltage Range 104 - 127V
- Ambient Temp Range -20 - 122°F

### SERVICE

- Panels easily removed and all components accessible for service.

TEL 1-800-438-6087

FAX 1-800-345-1325

www.hoshizaki.com

Printed in U.S.A.

