



"170-1" Stainless Steel Enclosed Work Tables

w/ Stainless Steel Base, Panels and Undershelf
 w/ Open Front
 w/ 3/4" High Density Polythylene Top



AUTOQUOTES



3/4" High Density Polythylene	
30"WIDE	Qty
170-06	
170-07	
170-08	
170-08A	
170-09	
170-09A	
170-10	

FEATURES:

- * 3/4" thick **High Density Polythylene Top**, sectioned per NSF regulation
- * Top is **Sound Deadened**
- * Reinforced with 1"x2" channel running entire length of table
- * 1 1/2" **Stallion Edge** on front and rear with side edges 90 degree bend down for table line-up
- * Stainless Steel Cabinet and Undershelf
Type 300 stainless steel with # 4 polish, satin finish
- * Undershelf is secured in a fixed position, 14 7/8" above floor
- * Adjustable bullet feet
- * Shipped Standard Welded Set-Up
- * Optional drawers, casters, pot racks, etc. available
- * All models are approved by the National Sanitation Foundation and the U.S. Department of Agriculture.

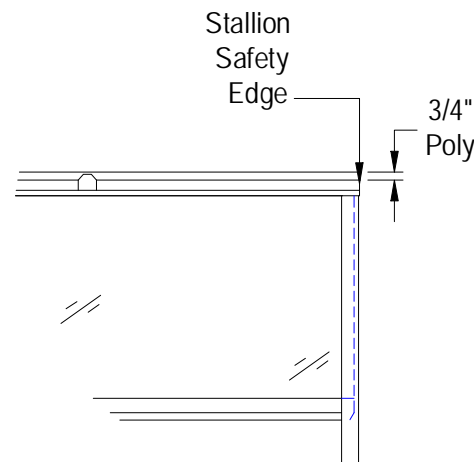

CONSTRUCTION:

Top: Stainless Steel Tops are TIG welded, Exposed welds are polished to match adjacent surface.

MATERIAL:

Poly: 3/4" High Density Polythylene
 Top: 16 gauge type 300 stainless steel # 4 polish, satin finish
 Shelf: 18 gauge type 300 stainless steel # 4 polish, satin finish
 Legs: 1 1/2" Square O.D., 16 gauge type 300 tubular stainless steel # 4 polish, satin finish
 Panels: 22 gauge stainless steel
 Type 300 stainless steel with # 4 polish, satin finish
 Feet: 1" adjustable stainless steel feet

OPTIONAL ACCESSORIES

	MODEL #	Qty
CASTERS		
INTERMEDIATE SHELF		
S/S BUN PAN RACK		

John Boos & Co

3601 S. Banker Street - Effingham, IL 62401
 Phone: 217-347-7701 - Fax: 217-347-7705
 Email: sales@johnboos.com - Web-site: www.johnboos.com

DETAILED SPECIFICATIONS

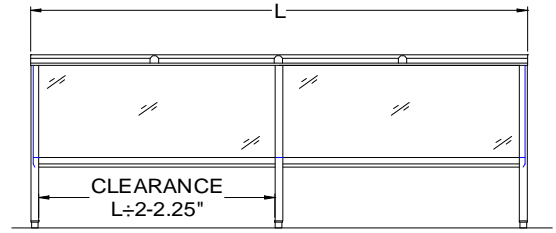
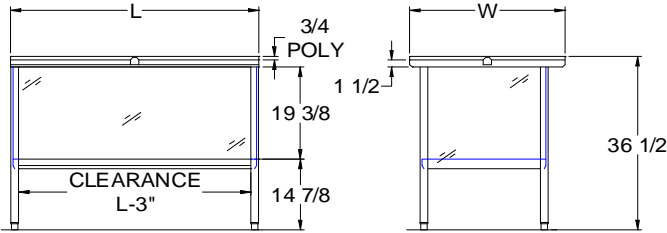
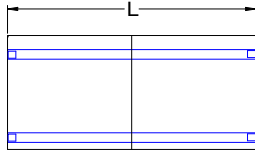

Shipped Welded Set-Up
 Units 7 ft. and larger are furnished with six legs.
 All dimensions are typical.
 Tolerance +/- .500".

Finished size of undershelf.
 Shelf length = length minus 4.875"
 Shelf width = width minus 4.25"

3/4" High Density Polythylene		
L	30" WIDE	WT.
48	170-06	201
60	170-07	236
72	170-08	262
84	170-08A	303
96	170-09	343
108	170-09A	379
120	170-10	414

John Boos & Co

3601 S. Banker Str. - Effingham, IL 62401 Phone: 217-347-7701 - Fax: 217-347-7705
 Email: sales@johnboos.com - Web-site: www.johnboos.com



July 2013

John Boos is constantly engaged in a program of improving products and therefore reserves the right to change specification without prior notice