

## SELF-CONTAINED NARROW DOOR BACK BAR COOLERS

MODEL: \_\_\_\_\_ PROJECT: \_\_\_\_\_ ITEM #: \_\_\_\_\_ QTY: \_\_\_\_\_

### PRODUCT IMAGE



NS72L-KSS-LRR SHOWN with  
OPTIONAL 1" TOP and KICK PLATES

**AVAILABLE IN 52" & 72" SIZES**

### OPTIONAL ACCESSORIES

- **BS-100** Four 6" Stainless Steel Legs
- **BS-101** Six 6" Stainless Steel Legs
- **BS-102** Four 4" Stainless Steel Legs
- **BS-103** Six 4" Stainless Steel Legs
- **BS-106** Left Side Stainless Steel Kick Plate
- **BS-107** Right Side Stainless Steel Kick Plate
- **BS-108** Four 3" Casters with brakes
- **BS-109** Six 3" Casters with brakes
- **BS-152** 52" Stainless Steel Front Kick Plate
- **BS-172** 72" Stainless Steel Front Kick Plate
- **BS-735** Replacement LED Light for NS52
- **BS-736** Replacement LED Light for NS72

### STANDARD FEATURES

- **Electrical**  
115 V, 1 Phase, 60 Hz. Furnished with 8'-0" plug-in cord, which exits left rear of cooler. NEMA 5-15P Plug Configuration.  
Dedicated 15 Amp circuit recommended  
2 Door Model: 6.0 Full Load Amps, 1/4 HP  
3 Door Model: 6.0 Full Load Amps, 1/4 HP
- **Refrigeration**  
Self-contained 1/4 HP 134A Refrigerant. 30°F-40°F operating range  
Digital Thermostat on front grille
- **Case Capacity**

	<b>52"</b>	<b>72"</b>
Long Neck Bottles:	12	19
Wine Bottles (750mL):	126	204
- **Interior**  
20 gauge stainless steel with coved corners. Two adjustable epoxy coated wire shelves with floor rack per door.
- **Exterior**  
Sides: 20 gauge stainless steel or black vinyl  
Front: 20 gauge stainless steel, black vinyl or glass  
Back: 20 gauge galvanized steel  
Top: 20 gauge galvanized steel with option of stainless steel
- **Insulation**  
2" thick foamed-in-place polyurethane
- **Plumbing**  
No drain connection required.  
Condensate evaporator pan included
- **IMPORTANT NOTE:**  
**DO NOT PLUG INTO GFI OUTLET**

*\* This equipment is intended for the storage and display of non-potentially-hazardous bottle or canned products only \**



**APPROVED BY:**

**CERTIFICATIONS:**

Due to our commitment to continued product improvement, specifications are subject to change without notice.

Printed in the USA

**Krowne Metal Corporation**

100 Haul Rd. Wayne, NJ 07470 • Toll Free: (800) 631-0442 • Fax: (973) 872-1129  
sales@krowne.com • www.krowne.com • www.facebook.com/KrowneMetal • www.twitter.com/KrowneMetal

Rev. 11/2012  
No. 1.5

## SELF-CONTAINED NARROW DOOR BACK BAR COOLERS

MODEL: \_\_\_\_\_ PROJECT: \_\_\_\_\_ ITEM #: \_\_\_\_\_ QTY: \_\_\_\_\_

### TWO DOOR (52")

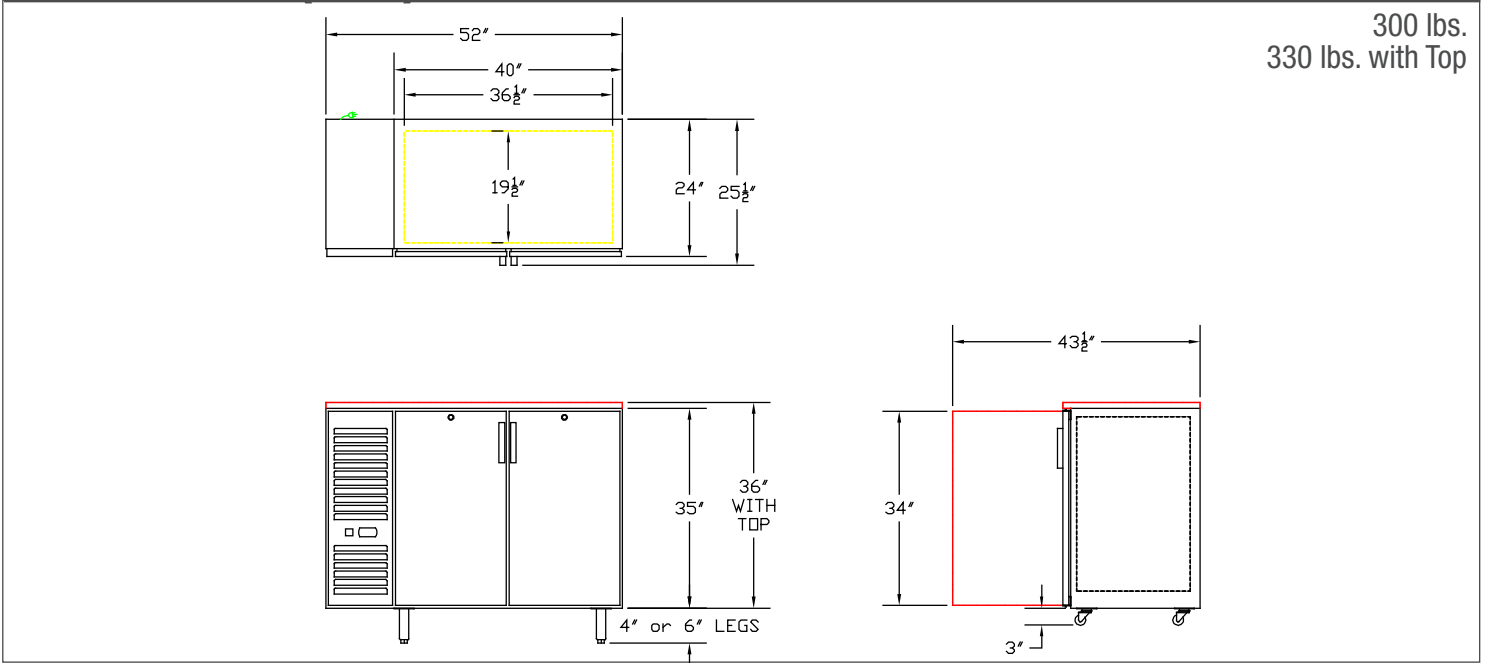

### THREE DOOR (72")

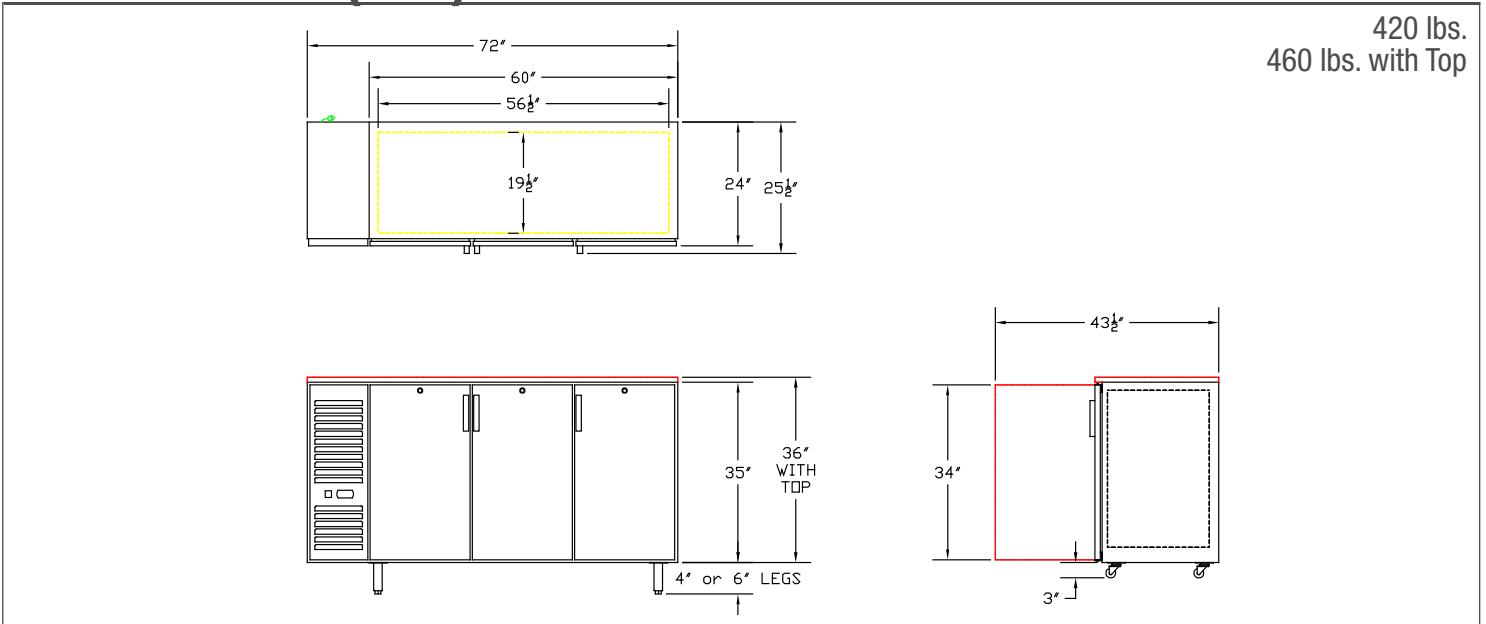

**APPROVED BY:**

**CERTIFICATIONS:**

Due to our commitment to continued product improvement, specifications are subject to change without notice.