

**Model No.:**  
**S48-24CTC**

**With 7-Circuit Cold Plate**  
**S48-24CTC+7**

- 304 Stainless Steel, Welded and Polished Top Assembly, Front Apron and Ends
- Insulated Ice Bin With Factory-Installed Stainless Steel Drain With 1 1/2" Standard Male Pipe Thread (When Provided With Cold Plate, Drain is 1/2" Standard Female Pipe Thread)
- Available in Different Lengths and/or With 36" Ice Chest
- Legs: Steel Tube and Welded Cross-Brace Construction, With Corrosion-Resistant Hammertone Paint and High-Impact Plastic Adjustable Feet
- Includes Four Removable, High-Impact ABS Bottle Storage Wells
- Available with Optional 304 Stainless Steel Cover or Clear Plexiglass Ice Dome
- Constructed to Meet NSF Specifications

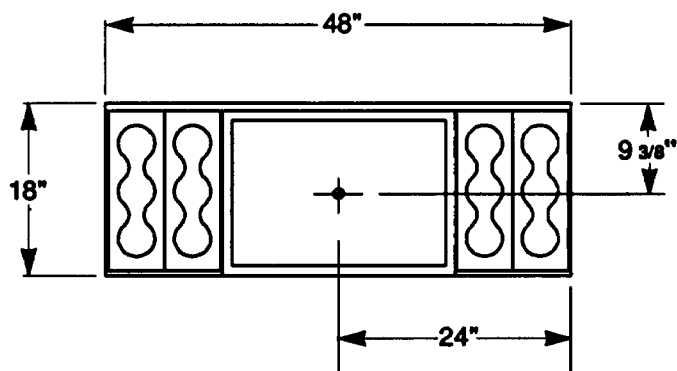

**Model Nos.:**  
**S48-24CTC**  
**S48-24CTC+7**

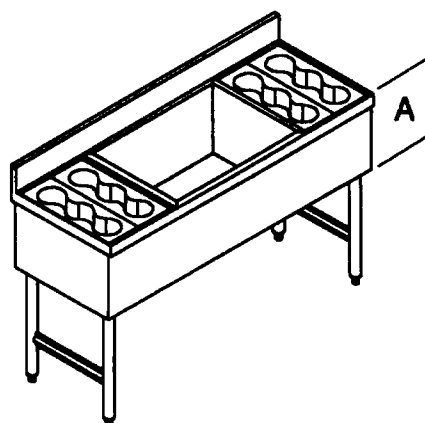
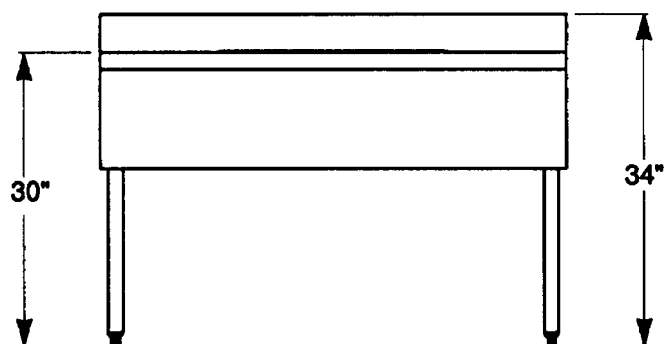

Description	Dimension A
w/o Cold Plate	12"
with Cold Plate	15"

**Contact factory or local representative for further information.**

Since La Crosse has a policy of continuous product improvement, it reserves the right to change design and specifications without notice.