

Modular Equipment 41000 Series

Ice Cream Cabinet - Stainless Steel Top

Remote



L-41142 shown with options

SPECIFICATIONS:

TOP: Die-formed construction of one-piece 16 GA stainless steel type 304-#4 finish with 2 5/8" nosing, Backsplash to be 3/8" coved, 6" high x 2 1/8" wide, Sheared ends fitted with recessed 12 GA steel bars for adjoining units, producing a hairline seam

OPENINGS: Die-formed raised, with high impact thermal breaker frames, Covers hinged in middle, insulated and removable, Openings will accommodate 3-gallon containers stacked 2 high

EXTERIOR: Back, bottom, and sides of 20 GA steel with painted enamel finish, Body supported by 14 GA galvanized steel box channels for legs

INTERIOR: Compartment of 22 GA stainless steel type 304-#2B finish, Liner has cold wall type construction and maintains a temperature of -5 to 0 degrees F

INSULATION: Rigid Polyurethane Foam

FRONT: Exterior removable panels of one-piece die-stamped 22 GA stainless steel type 304-#4 finish

LEGS: 6" high legs, 1 5/8" tubing welded to steel plate and fastened to body support channels, Bullet-foot has 1 1/8" of adjustment, All legs are stainless steel

REFRIGERATION: Remote unit has an expansion valve system with temperature control, Expansion valve located behind one of the front panels, System comes assembled with junction box ready for final connection, Base tested to operate between -5 and 0 degrees F

ITEM # _____

PROJECT _____

DATE _____

MODEL	LENGTH
L-41118	18"
L-41132	32"
L-41142	42"
L-41154	54"

DEPTH
28" OR 32"

FEATURES

- 16 GA reinforced top
- Remote unit
- All Stainless Steel Interior lining with cold wall construction
- Refrigeration system has expansion valve & control for rapid recovery
- Uniform integration in design, quality and parts
- 3-gallon containers stack two high

OPTIONS

- S/S Ends

Modular Equipment L-41000 Series - Ice Cream Cabinets

DIMENSIONAL DATA

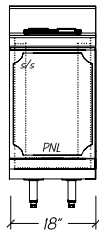
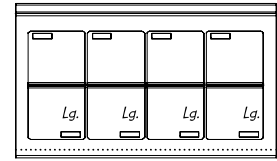
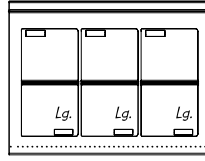
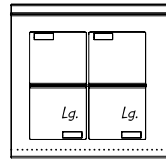
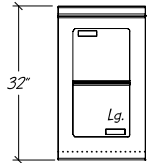
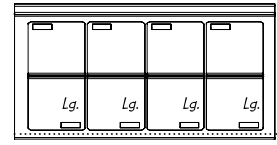
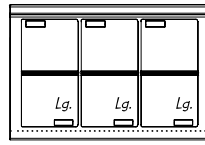
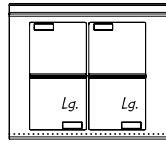
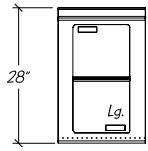

L-41118

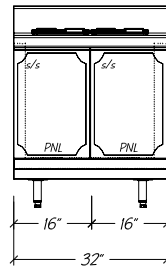

L-41132

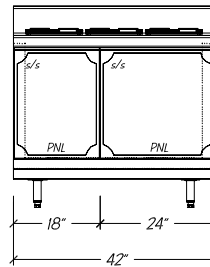

L-41142

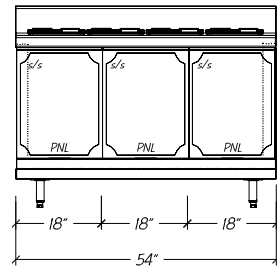

L-41154

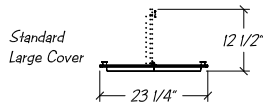

STATISTICAL DATA

MODEL	LGTH	# OF LIDS	GALLON CAPACITY		VOLTS/ CYCLE/ PHASE	REC HP COMP 404A ⁱ	SHIP WT.
			# OF 3 GAL. CONTAINERS	TOTAL GAL.			
L-41118	18"	1 lg	4	12	115v/60/1	1/4	225#
L-41132	32"	2 lg	8	24	115v/60/1	1/4	290#
L-41142	42"	3 lg	12	36	115v/60/1	1/4	325#
L-41154	54"	4 lg	16	48	115v/60/1	1/3	370#

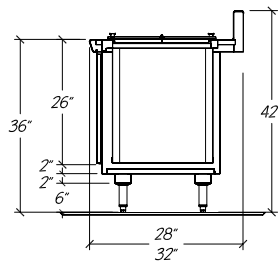

Notes: i. Recommended HP with up to 25 ft of refrigeration lines (at installers discretion)

Modular Equipment 41000 Series MECHANICAL DATA

- RL Refrigeration Lines, 1/4" inlet and 3/8" suction 8" AFF
- ∇ Expansion Valve 28" AFF
- C Centered over freezer compartment

