



L-72102 shown with options

SPECIFICATIONS:

INTERIOR: Ends of pan type construction, 22 GA stainless steel type 304-#4 finish 1 1/2" thick, Sheared ends fitted with recessed 12 GA steel bars for adjoining units, producing a hairline seam

EXTERIOR: Ends are unfinished painted side of stainless steel interior end

BACK: Panel of 18 GA stainless steel type 304-#4 finish reinforced with 20 GA galvanized steel box channels, Bottom of panel starts 12" above floor

LEGS: 10" high x 1 5/8" tubing welded to bottom of stainless steel ends, Bullet-foot has 1 1/8" of adjustment, All legs are stainless steel

ITEM # _____

PROJECT _____

DATE _____

MODEL	LENGTH
L-72136	36"
L-72142	42"
L-72148	48"
L-72154	54"
L-72160	60"
L-72172	72"
L-72184	84"
L-72196	96"
L-72108	108"
L-72120	120"

DEPTH
26 1/2" OR 30 1/2"

FEATURES

- All stainless steel interior
- 12" clearance in rear to floor for utility supply lines
- 10" high adjustable legs
- 1" and fractional sizes available
- Uniform integration in design, quality and parts

OPTIONS

- Custom Sizes available
- Cut-outs for outlets, additional add-on options
- Richlite board

Modular Equipment L-72000 Series - Equipment Stands, Double Enclosure

DIMENSIONAL DATA

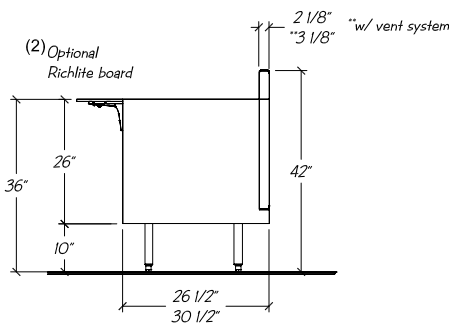
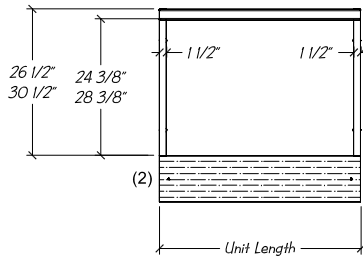
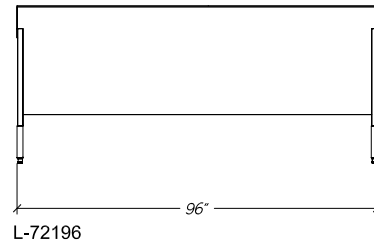
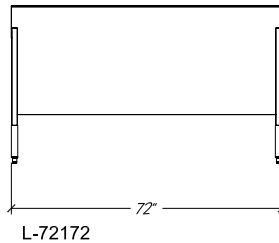
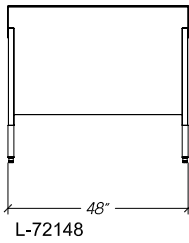
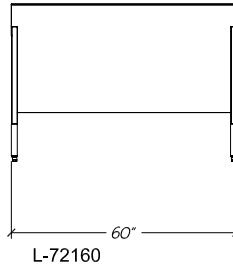
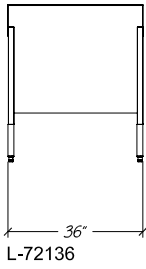

STATISTICAL DATA

MODEL	LGTH i.	SHIP WT.
L-72136	36"	165#
L-72142	42"	180#
L-72148	48"	195#
L-72154	54"	210#
L-72160	60"	225#
L-72172	72"	250#
L-72184	84"	285#
L-72196	96"	320#
L-72108	108"	350#
L-72120	120"	375#

- Notes:**
- i. Allow 4" for equipment clearance and side thickness
 - ii. 12" clearance between bottom of wainscote and floor