



MBSMP60-24



MBSMP SERIES

Mega Top Sandwich/Salad Prep Units

MODELS

- MBSMP27-12 MBSMP36-15 MBSMP48-18
- MBSMP60-24 MBSMP72-30

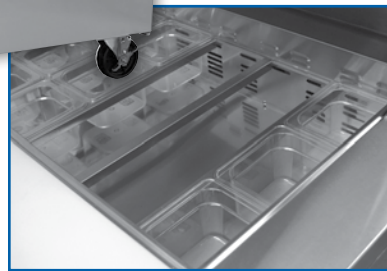

Drop-in section:

- Fans force cold air into this enclosed area keeping stored food items consistently cold
- A stainless steel divider prevents food spillage into the storage area beneath
- Accommodates 6" deep pans (4" standard)

FEATURES

CONSTRUCTION

- Curved corner design creates a stylish appearance and reduces chances of injury in slip-and-fall accidents
- Stainless steel interior and exterior
- Foamed-in-place with low ODP polyurethane insulation
- Standard 9 1/2" deep reversible cutting board
- Insulated top lid
- Wall thickness: 1.77"
- 6" diameter casters
- Adjustable heavy-duty vinyl-coated shelves
- 1/6 size pans included (three 1/9 size pans and nine 1/6 pans included in MBSMP27-12)

- 1-door models hinged right
- 2-door models.....left hinged left, right hinged right
- 3-door models.....left hinged left, middle hinged left, right hinged right

- Door width:
 - MBSMP27-12..... 27 1/4"
 - MBSMP36-15 18"
 - MBSMP48-18 23 7/8"
 - MBSMP60-24..... 30"
 - MBSMP72-30 23 7/8"

REFRIGERATION

- Self-contained refrigeration system
- Forced air system
- Coated evaporator coil
- Refrigerant: R-134a
- Temperature range: 32° to 40°F (0° to 4°C)

WARRANTY

- **Standard limited three year parts and labor**
- **Additional two year coverage on compressor part**

DOORS

- Self-closing
- Standard door swing configuration:

OPTIONS

- Single or double overshef



- Refrigerated drawers (excluding MBSMP36-15)



BID SPECIFICATIONS

Item no. MBSMP_____. Provide _____ Mega Top Sandwich/Salad Prep Unit(s), Master-Bilt model no. MBSMP_____.
 Prep unit will feature rounded corner construction with stainless steel interior

and exterior.
 The refrigeration system will be bottom mounted and self-contained. Refrigerant will be R-134a. The temperature range will be 32° to 40°F (0° to 4° C).

Prep unit to have standard limited three year parts and labor with additional two year coverage on compressor part.
 Prep unit to be UL, C-UL and ETL Sanitation listed.

TECHNICAL SPECIFICATIONS

MODEL	DIMENSIONS (in.)			DIMENSIONS (mm)			VOLTS	AMPS	UNIT H.P.	NO. OF DOORS	NO. OF SHELVES	NO. OF PANS	CAP. CU. FT.	SHIP CU. FT.	SHIP WT. LB/KG
	L	D*	H**	L	D*	H**									
MBSMP27-12	27 ¹ / ₂	35 ¹ / ₄	44 ¹ / ₈	699	895	1121	115	3.2	1/5	1	1	(9) 1/6, (3) 1/9	6.8	27.1	223/101
MBSMP36-15	36 ³ / ₈	35 ¹ / ₄	44 ¹ / ₈	924	895	1121	115	3.6	1/5	2	2	(15) 1/6	9.4	33.6	284/129
MBSMP48-18	48 ¹ / ₄	35 ¹ / ₄	44 ¹ / ₈	1226	895	1121	115	7.9	3/8	2	2	(18) 1/6	12.7	46.1	318/145
MBSMP60-24	60 ³ / ₈	35 ¹ / ₄	44 ¹ / ₈	1534	895	1121	115	7.9	3/8	2	2	(24) 1/6	16.0	56.8	362/165
MBSMP72-30	72 ³ / ₈	35 ¹ / ₄	44 ¹ / ₈	1838	895	1121	115	9.9	3/8	3	3	(30) 1/6	19.6	67.0	399/181

*Depth includes cutting board. **Height includes casters.

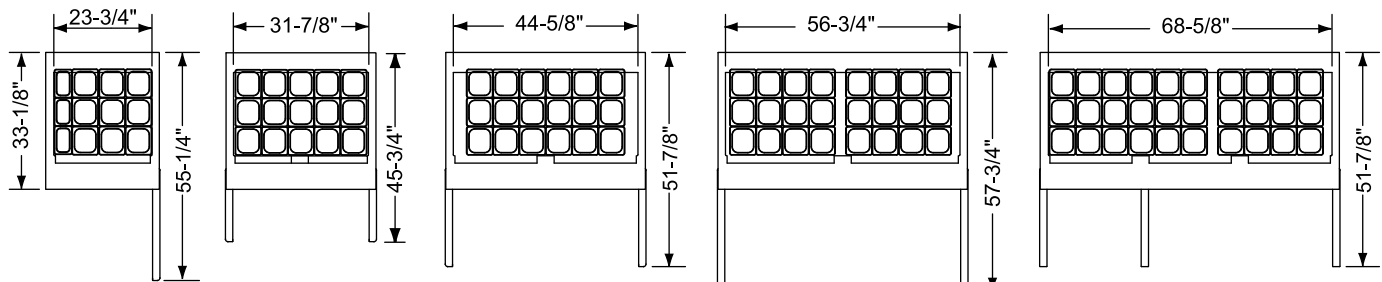

MBSMP27-12
PLAN VIEW

MBSMP36-15
PLAN VIEW

MBSMP48-18
PLAN VIEW

MBSMP60-24
PLAN VIEW

MBSMP72-30
PLAN VIEW

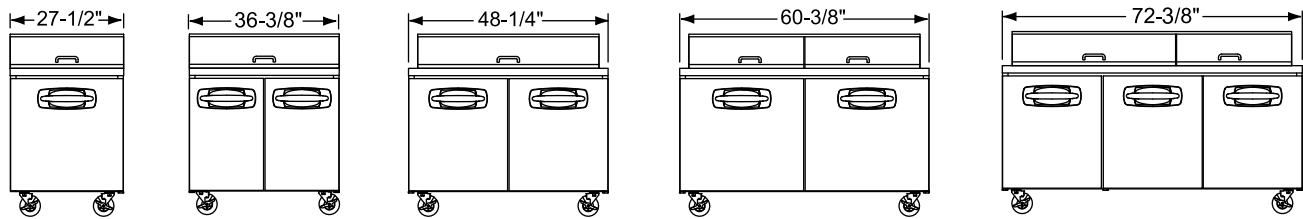

MBSMP27-12
ELEVATION
VIEW

MBSMP36-15
ELEVATION
VIEW

MBSMP48-18
ELEVATION
VIEW

MBSMP60-24
ELEVATION
VIEW

MBSMP72-30
ELEVATION
VIEW

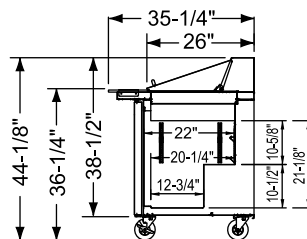

ALL MODELS
SIDE VIEW

LISTINGS



HOOKUP

All models via plug in, 9 foot long flexible three wire 14/3 cord with molded plug.

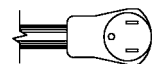

NEMA 5-15P

OPTIONAL REFRIGERATED DRAWER CONFIGURATIONS (Not available on MBSMP36-15 model)

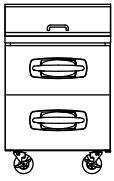

MBSMP27-12-001

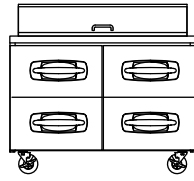

MBSMP48-18-001

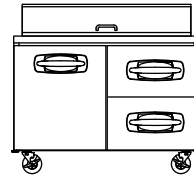

MBSMP48-18-002



MBSMP48-18-003

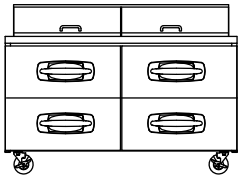

MBSMP60-24-001

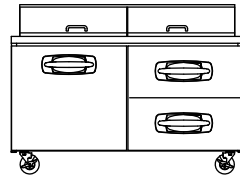

MBSMP60-24-002

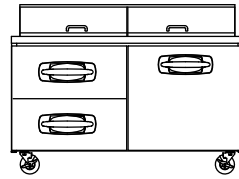

MBSMP60-24-003

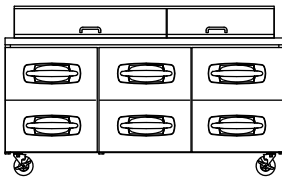

MBSMP72-30-001

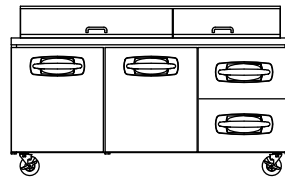

MBSMP72-30-002

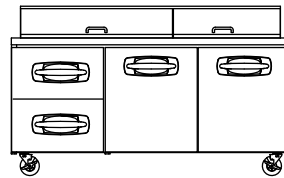

MBSMP72-30-003

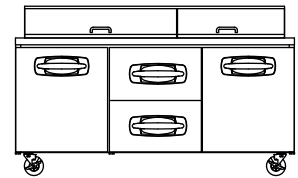

MBSMP72-30-004

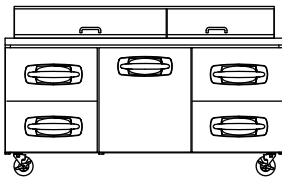

MBSMP72-30-005

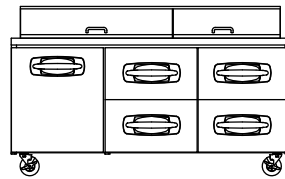

MBSMP72-30-006

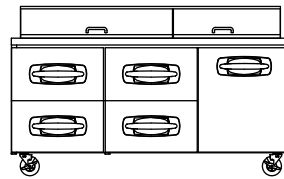

MBSMP72-30-007

PAN CONFIGURATIONS FOR REFRIGERATED DRAWERS (Not available on MBSMP36-15 model)

MBSP27, MBSMP27 & MBUR27

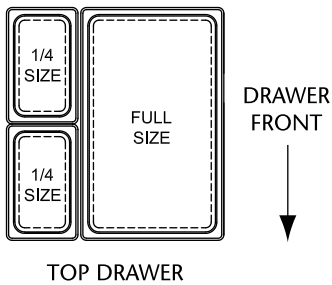

MBSP48, MBSMP48, MBUR48
& MBSP72, MBSMP72, MBUR72

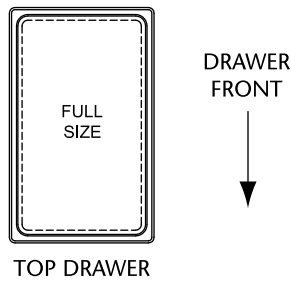

MBSP60, MBSMP60 & MBUR60

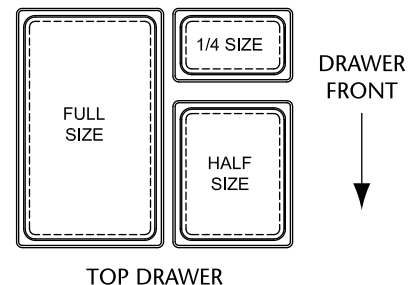

*U.S. size pans, pans provided by others. Drawers accept up to 6-inch deep pans.

OPTIONAL OVERSHELF SPECIFICATIONS

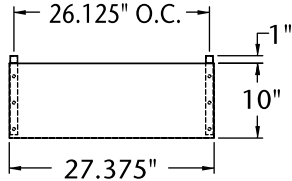

PLAN VIEW
MBSP27, MBSMP27,
MBUR/MBUF27

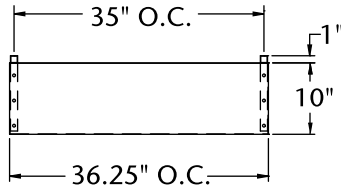

PLAN VIEW
MBSP36, MBSMP36,
MBUR36

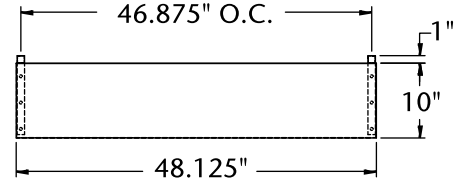

PLAN VIEW
MBSP48, MBSMP48,
MBUR/MBUF48

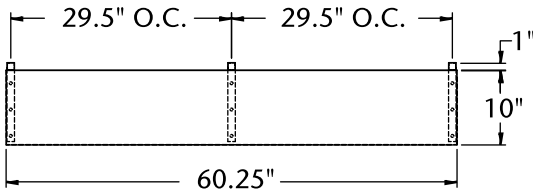

PLAN VIEW
MBSP60, MBSMP60, MBUR/MBUF60

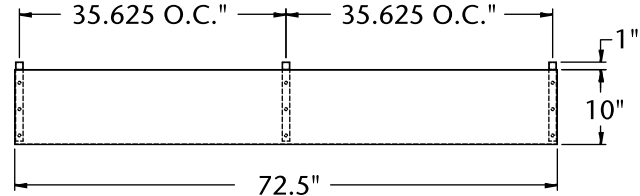

PLAN VIEW
MBSP72, MBSMP72, MBUR72

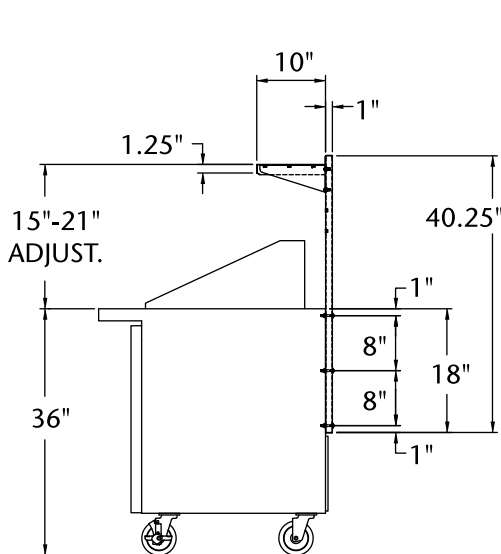

SINGLE SHELF SIDE VIEW

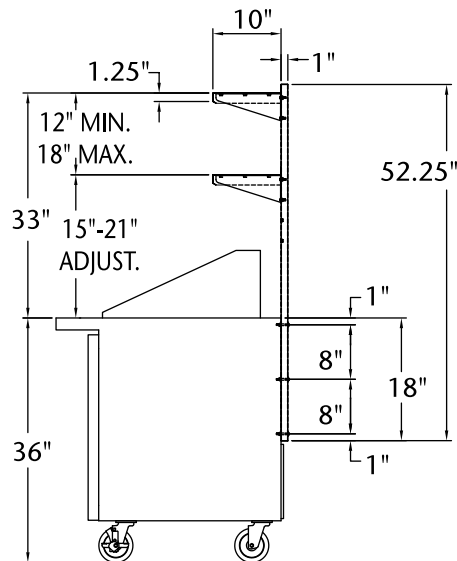

DOUBLE SHELF SIDE VIEW

NOTE: Cabinet designed for optimum performance in air-conditioned area at 75°F ambient and 55% relative humidity. All specifications subject to change without notice.