



MBU-A SERIES

Undercounter/Worktable Refrigerators & Freezers

MBUF/MBUR60A



ENERGY STAR® qualification applies to undercounter refrigerator models only.

REFRIGERATORS

- MBUR27A
- MBUR36A
- MBUR48A
- MBUR60A
- MBUR72A

FREEZERS

- MBUF27A
- MBUF48A
- MBUF60A

FEATURES

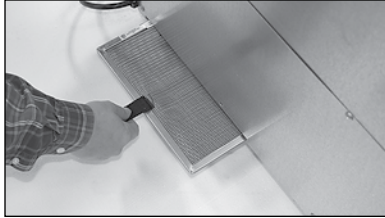

Standard condenser filter screen, removable without tools, for easy condenser coil cleaning resulting in peak efficiency and extended equipment life.

CONSTRUCTION

- Stainless steel interior and exterior
- Foamed-in-place with low ODP polyurethane insulation
- Wall thickness: 2"
- 6" overall height casters
- Adjustable heavy-duty vinyl-coated shelves, one per door
- Front-breathing design allows for zero-clearance installation on sides, back and top

DOORS

- Self-closing with heavy-duty recessed pocket handle
- Standard door swing configuration:
 - 1-door models hinged right
 - 2-door models. left hinged left, right hinged right
 - 3-door model .. left hinged left, middle door hinged left, right door hinged right
- Door width:
 - MBUR/MBUF27A 27½"
 - MBUR36A..... 17½"
 - MBUR/MBUF48A 23½"
 - MBUR/MBUF60A 29½"
 - MBUR72A..... 23½"

REFRIGERATION

- Self-contained forced air capillary tube refrigeration system
- Refrigerant:
 - MBUR models R-134a
 - MBUF models..... R-404A
- Temperature range:
 - MBUR-A.. 34° to 38°F (1° to 3°C)
 - MBUF-A ... -5° to 0°F (-20° to -17°C)

WARRANTY

- **Standard limited three year parts and labor**
- **Additional two year coverage on compressor part**

OPTIONS

- Low profile casters for ADA compliance
- 6" legs in lieu of casters
- Additional shelves
- Stainless steel backsplash
- Single or double overshelf
- Refrigerated drawers for MBUR-A models (excluding MBUR36A)

TECHNICAL SPECIFICATIONS

MODEL	DIMENSIONS (in.)			DIMENSIONS (mm)			VOLTS	AMPS	UNIT H.P.	NO. OF DOORS	NO. OF SHELVES	CAP. CU. FT.	SHIP CU. FT.	SHIP WT. (LB/KG)
	L	D	H*	L	D	H*								
REFRIGERATORS														
MBUR27A	27 ^{1/2}	30	36	699	762	917	115	3.6	1/5	1	1	7.2	24.8	190/86
MBUR36A	36	30	36	914	762	917	115	3.6	1/5	2	2	9.9	31.2	220/100
MBUR48A	48	30	36	1219	762	917	115	3.7	1/5	2	2	13.4	40.4	255/116
MBUR60A	60	30	36	1524	762	917	115	5.7	3/8	2	2	16.2	49.4	305/138
MBUR72A	72	30	36	1829	762	917	115	5.7	3/8	3	3	20.5	58.5	365/166
FREEZERS														
MBUF27A	27 ^{1/2}	30	36	699	762	917	115	5.2	1/3	1	1	7.2	24.8	195/89
MBUF48A	48	30	36	1219	762	917	115	7.5	1/2	2	2	13.4	40.4	265/120
MBUF60A	60	30	36	1524	762	917	115	7.5	1/2	2	2	16.2	49.4	320/145

*Height includes casters.

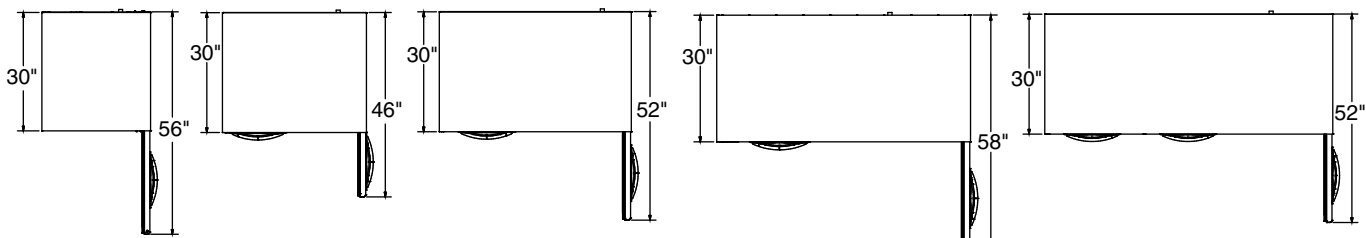

MBUR/MBUF27A
PLAN VIEW

MBUR36A
PLAN VIEW

MBUR/MBUF48A
PLAN VIEW

MBUR/MBUF60A
PLAN VIEW

MBUR72A
PLAN VIEW

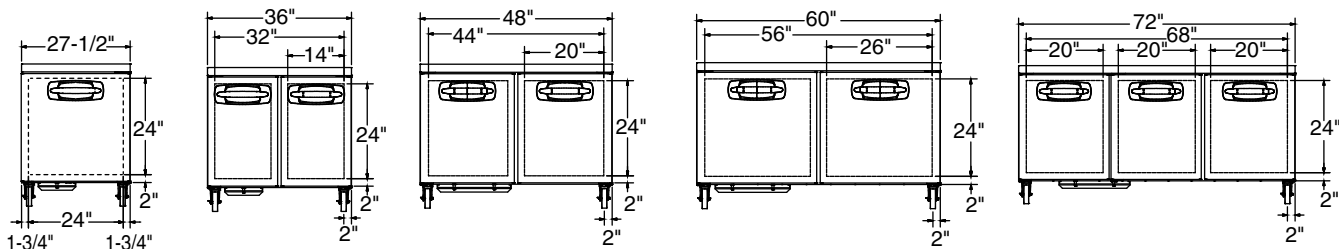

MBUR/MBUF27A
ELEVATION VIEW

MBUR36A
ELEVATION VIEW

MBUR/MBUF48A
ELEVATION VIEW

MBUR/MBUF60A
ELEVATION VIEW

MBUR72A
ELEVATION VIEW

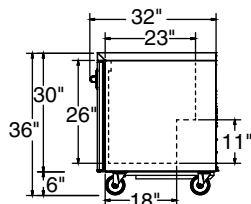

ALL MODELS
SIDE VIEW

LISTINGS



ANSI/NSF 7



ENERGY STAR® qualification applies only to undercounter refrigerator models.

HOOKUP

All models via plug in, 9 foot long flexible three wire 18/3 cord with molded plug.



NEMA 5-15P

OPTIONAL REFRIGERATED DRAWER CONFIGURATIONS

MBUR-A models only, not available on MBUR36A.

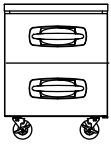

MBUR27A-001

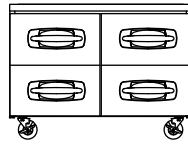

MBUR48A-001

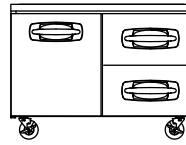

MBUR48A-002

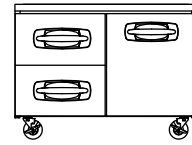

MBUR48A-003

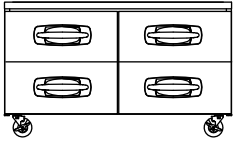

MBUR60A-001

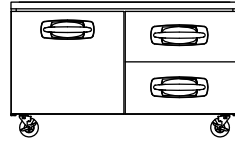

MBUR60A-002

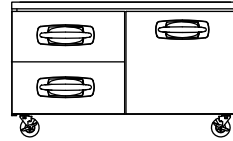

MBUR60A-003

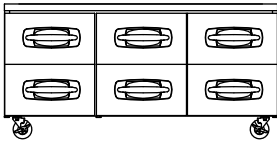

MBUR72A-001

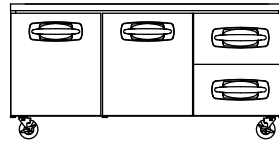

MBUR72A-002

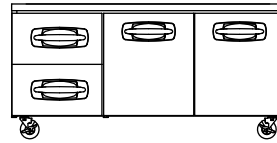

MBUR72A-003

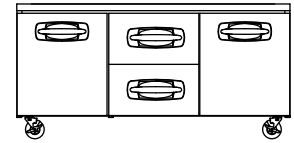

MBUR72A-004

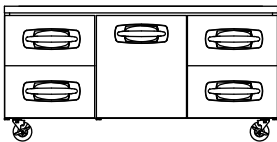

MBUR72A-005

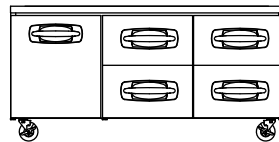

MBUR72A-006

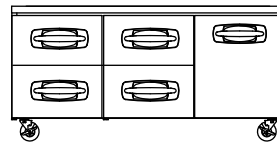

MBUR72A-007

PAN CONFIGURATIONS FOR REFRIGERATED DRAWERS

MBUR models only, not available on MBUR36A.

MBUR27A

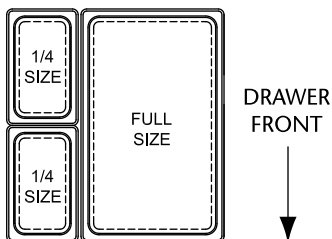

TOP DRAWER

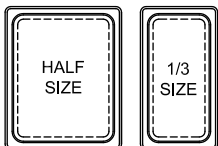

BOTTOM DRAWER

MBUR48A & MBUR72A

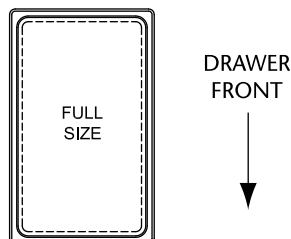

TOP DRAWER

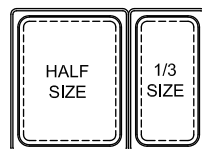

BOTTOM DRAWER

MBUR60A

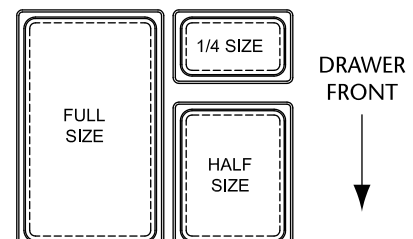

TOP DRAWER

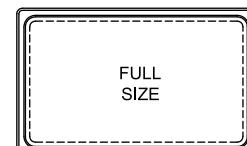

BOTTOM DRAWER

*U.S. size pans, pans provided by others. Drawers accept up to 6-inch deep pans.

OPTIONAL OVERSHELF SPECIFICATIONS

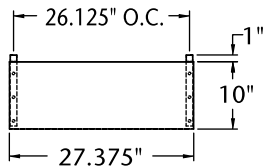

PLAN VIEW
MBUR/MBUF27A

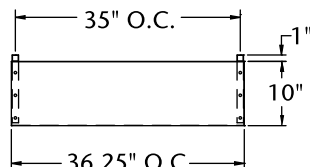

PLAN VIEW
MBUR36A

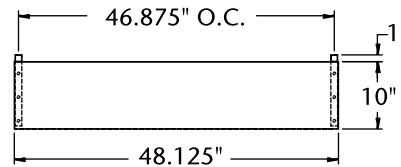

PLAN VIEW
MBUR/MBUF48A

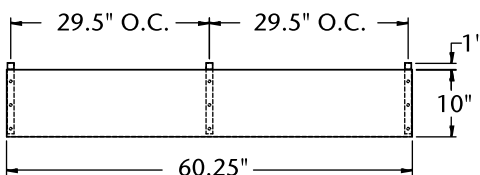

PLAN VIEW
MBUR/MBUF60A

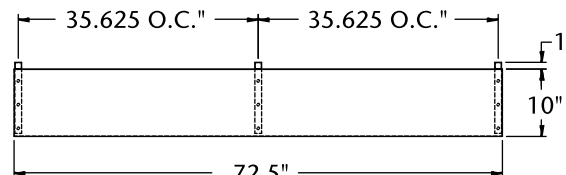

PLAN VIEW
MBUR72A

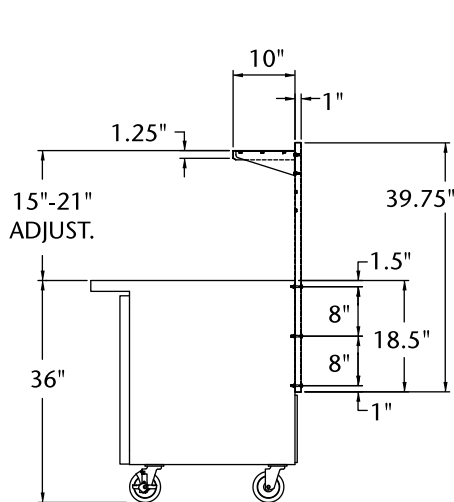

SINGLE SHELF SIDE VIEW

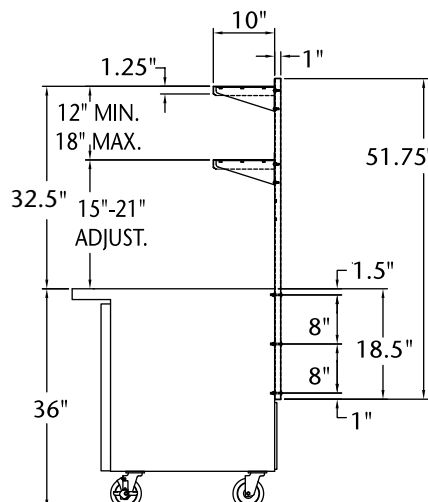

DOUBLE SHELF SIDE VIEW

BID SPECIFICATIONS

Item no. MBU____A. Provide _____ Undercounter/worktable refrigerator/freezer(s), Master-Bilt model no. MBU____A.

Undercounter will feature condenser coil filter screen, removable without tools, for simple preventative maintenance cleaning.

The refrigeration system will be bottom

mounted and self-contained. System will be front-breathing allowing for zero-clearance installation on sides, back and top. Freezers will use R-404A refrigerant. Refrigerators will use R-134a. The temperature range will be 34° to 38°F (1° to 3° C) for refrigerators and -5° to 0°F (-20° to -17°C) for freezers.

Undercounter to have standard limited three year parts and labor with additional two year coverage on compressor part.

Undercounter to be UL & C-UL listed and UL EPH classified with ENERGY STAR qualification on undercounter refrigerator models.

NOTE: Cabinet designed for optimum performance in air-conditioned area at 75°F ambient and 55% relative humidity. All specifications subject to change without notice.