



TEL-4-30SC (shown with ends installed)



TEM/TEL-30 SC SERIES SELF-CONTAINED

Endless Glass Door Merchandisers
With Top Mounted Refrigeration &
30-Inch Wide Doors

MEDIUM TEMP MODELS

- TEM-2-30SC TEM-4-30SC
 TEM-3-30SC TEM-5-30SC

LOW TEMP MODELS

- TEL-2-30SC TEL-4-30SC
 TEL-3-30SC TEL-5-30SC



Optional curb front available.

FEATURES

CONSTRUCTION

- Standard electronic controller with these features:
 - Ability to monitor defrost functions from the front panel interface
 - Audible and visual alarm
 - Eliminates room thermostat, defrost termination/fan delay control, defrost timer and digital thermometer or other temperature indicator
- Standard LED lighting
- Baked-on polyester textured steel finish on exterior and interior
- Field installed 24 gauge steel shroud with finish matching cabinet exterior
- Condensing unit covered with fiberglass mat sound insulation
- Factory pre-wired for easy field connection. Only field wiring required is main power connection between condensing unit and merchandiser.
- A large heavy duty rub rail and kick plate to protect from abuse
- 5 cantilever epoxy-coated welded wire shelves with price tag molding per door
- Shelves rated to support 135 lbs. each
- 2" foamed-in-place "zero ODP" urethane insulation
- Product stop feature to prevent product from falling behind shelves
- Ends must be ordered separately

DOORS

- 30" wide reversible glass doors
- Self-closing door hinge with adjustable torsion control
- Standard black door and frame (optional colors available)

REFRIGERATION

- Refrigerant: R-404A
- Factory tested refrigeration system
- Pre-charged with quick connect fittings and lines
- Heavy-duty copper tube evaporator coil
- Condensate evaporator and condensate pump provided
- Electric defrost on low temp models
- Pre-mounted expansion valve
- Temperature ranges:
 - TEM models: 34° to 41°F (1° to 5°C)
 - TEL models: 0° to -15°F (18° to -26°C)
- R-factor (insulation efficiency rating): 18.75

WARRANTY

- Standard limited two year parts and labor
- Additional three year coverage on compressor part

When ordering multi-cabinet line-ups, please note:

- Pre-wired cabinet-to-cabinet electrical terminal block connectors are furnished
- A 2" thick partition is required between each endless module if:
 - Each utilizes its own condensing unit and
 - One module is a freezer and one is a cooler
- A 1/16" thick partition is required between each module of like temperatures
- Joining kits for linking together modules are standard
- Please allow an additional 1" clearance for case and assembly dimensional tolerance stack-up

OPTIONS

- Right or left hand end kits
 Custom colors
 Drip pans for interior
 Additional 30" cantilever shelves
 Partitions
 Motion sensors for LED lighting
 Kickplate
 Baskets



TEM/TEL-30 SC SERIES – SELF-CONTAINED

ENDLESS GLASS DOOR MERCHANDISERS WITH TOP MOUNTED REFRIGERATION SYSTEM & 30-INCH WIDE DOORS

TECHNICAL SPECIFICATIONS

MODEL	DIMENSIONS (in.)			DIMENSIONS (mm)			NO. OF DOORS	NO. OF SHELVES	SHELVING AREA SQ. FT.	USABLE CU. FT.	PRODUCT FACING SQ. FT.	NO. OF INTERIOR LIGHTS
	L*	D	H**	L*	D	H**						
TEM/TEL-2-30SC	61 ¹⁵ / ₁₆	38 ¹ / ₄	102	1573	972	2591	2	10	49.5	57.8	27.2	3
TEM/TEL-3-30SC	92 ³ / ₈	38 ¹ / ₄	102	2346	972	2591	3	15	73.8	86.2	40.6	4
TEM/TEL-4-30SC	122 ¹³ / ₁₆	38 ¹ / ₄	102	3119	972	2591	4	20	98.1	114.6	53.9	5
TEM/TEL-5-30SC	153 ¹ / ₄	38 ¹ / ₄	102	3893	972	2591	5	25	122.4	143.0	67.3	6

*Add 2" (51mm) to length for each end or insulated partition. Also allow an additional 1" clearance for case and assembly dimensional tolerance stack-up. **Height includes shroud.

ELECTRICAL

	TEM-2-30SC	TEM-3-30SC	TEM-4-30SC	TEM-5-30SC	TEL-2-30SC	TEL-3-30SC	TEL-4-30SC	TEL-5-30SC
115/208-230V/60/1 CIRCUIT AMPS (REQUIRES 4-WIRE 208-230 SERVICE)								
Condensing Unit Model Number*	MHHZ007FB	MHHZ007FB	MHHZ007FB	MHHZ007FB	MHLZ007FB	MHLZ007FB	MHLZ008FB	MHLZ009FB
Capacity BTU with 10° @ 90°F Ambient	6100	6100	6100	6100	6670	6670	7540	9640
Condensing Unit	5.7	5.7	5.7	5.7	8.2	8.2	8.4	11.4
Defrost Heater	N/A	N/A	N/A	N/A	5.6	6.7	9.5	12.5
Drain Line Heater	N/A	N/A	N/A	N/A	6.5	6.5	6.5	6.5
Horsepower	0.5	0.5	0.5	0.5	1.5	1.5	2	2.5
Evaporator Fan Motor	1.0	1.0	1.0	1.0	0.5	0.5	0.5	0.5
Anti-Sweat Amps/Mullion/Frame	0.97	1.43	1.93	2.35	2.62	4.77	6.31	7.76
LED Lights	0.25	0.37	0.5	0.62	0.25	0.37	0.5	0.62
Condensate Pump	1.5	1.5	1.5	1.5	1.5	1.5	1.5	1.5
Condensate Pan	3.3	3.3	3.3	3.3	3.3	3.3	3.3	3.3
Minimum Circuit (MCA)	12	12	12	12	22.1	22.1	23.7	28.5
Maximum Over-current Protector (MOP)	15	15	15	15	25	25	30	40

* Condensing units listed are for individual modules only. For multi-module line-ups, please contact factory for system recommendations.

SHIP WEIGHTS

MODEL	CABINET WT. WITH ENDS LB/KG	CONDENSING UNIT WT. LB/KG	TOTAL WT. LB/KG
TEM-2-30SC	755/343	97/44	852/387
TEM-3-30SC	1375/625	97/44	1472/669
TEM-4-30SC	1670/759	97/44	1767/803
TEM-5-30SC	2000/909	97/44	2097/953

MODEL	CABINET WT. WITH ENDS LB/KG	CONDENSING UNIT WT. LB/KG	TOTAL WT. LB/KG
TEL-2-30SC	1085/493	100/45	1185/539
TEL-3-30SC	1325/602	100/45	1425/648
TEL-4-30SC	1785/811	156/71	1941/882
TEL-5-30SC	1955/889	158/72	2113/960

TECHNICAL DRAWINGS

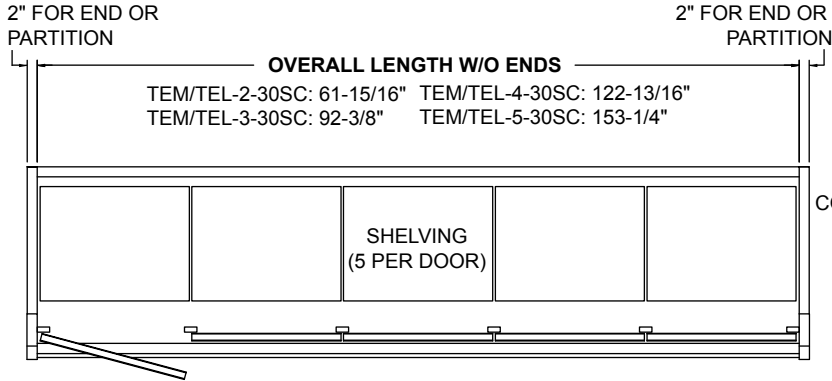

PLAN VIEW

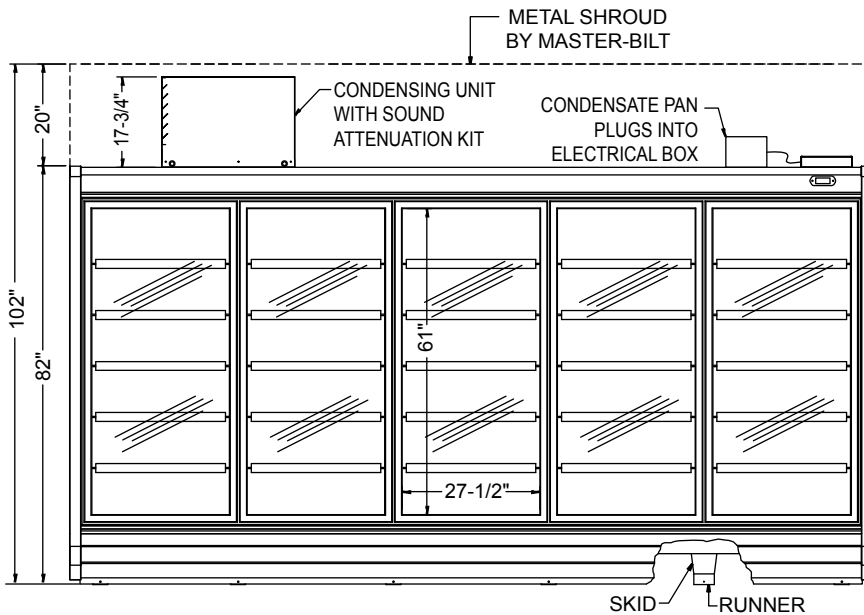

ELEVATION VIEW

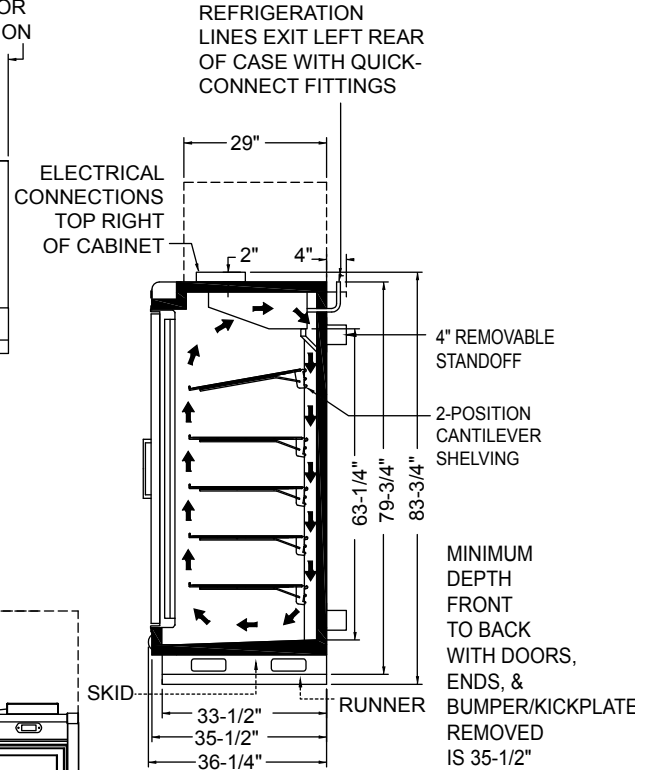

RUNNER SHIPS SEPARATELY TO FACILITATE ENTRANCE THROUGH STANDARD 80" TALL OPENING

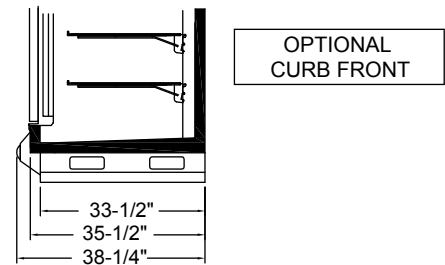

SIDE VIEW

LISTINGS



HOOKUP

Hardwire.



TEM/TEL-30 SC SERIES – SELF-CONTAINED

ENDLESS GLASS DOOR MERCHANDISERS WITH TOP MOUNTED REFRIGERATION SYSTEM & 30-INCH WIDE DOORS

MODULES REQUIRED FOR 30" WIDE DOOR LINEUPS & BTU PERFORMANCE DATA

NO. OF DOORS	MODULES REQUIRED				TOTAL OVER-ALL LENGTH WITH ONE PAIR OF 2" ENDS	+20°F SUCTION MIN. BTUs (75°F STORE, 55% RH, +35°F AVERAGE PRODUCT TEMP.)	-11°F SUCTION MIN. BTUs (75°F STORE, 55% RH, -3°F AVERAGE PRODUCT TEMP.)	-18°F SUCTION MIN. BTUs (75°F STORE, 55% RH, -12°F AVERAGE PRODUCT TEMP.)
	2 DOOR	3 DOOR	4 DOOR	5 DOOR				
2	1				65 ¹⁵ / ₁₆	2800	3300	3550
3		1			96 ³ / ₈	3750	4750	5125
4			1		126 ¹³ / ₁₆	4600	6150	6550
5				1	157 ¹ / ₄	5750	7625	8300
6		2			188 ³ / ₄	6900	9150	9960
7	1			1	219 ⁹ / ₁₆	8050	10,675	11,620
8		1		1	249 ⁵ / ₈	9200	12,200	13,280
9			1	1	280 ¹ / ₁₆	10,350	13,725	14,940
10				2	310 ¹ / ₂	11,500	15,250	16,600
11		2		1	342	12,650	16,775	18,260
12	1			2	372 ⁷ / ₁₆	13,800	18,300	19,920
13		1		2	402 ⁷ / ₈	14,950	19,825	21,580
14			1	2	433 ⁵ / ₁₆	16,100	21,350	23,240
15				3	463 ³ / ₄	17,250	22,875	24,900
16		2		2	495 ¹ / ₄	18,400	24,400	26,560
17	1			3	525 ¹¹ / ₁₆	19,550	25,925	28,220
18		1		3	556 ¹ / ₈	20,700	27,450	29,880
19			1	3	586 ⁹ / ₁₆	21,850	28,975	31,540
20				4	617	23,000	30,500	33,200
21		2		3	648 ¹ / ₂	24,150	32,025	34,860
22	1			4	678 ¹⁵ / ₁₆	25,300	33,550	36,520
23		1		4	709 ³ / ₈	26,450	35,075	38,180
24			1	4	739 ¹³ / ₁₆	27,600	36,600	39,840
25				5	770 ¹ / ₄	28,750	38,125	41,500

BID SPECIFICATIONS

Item no. TEM/TEL-____-30SC

Provide _____ () Endless Self-Contained Glass Door Merchandisers - Top Mounted model no. TEM/TEL-____-30SC.

Merchandiser to be constructed of baked-on polyester painted textured steel with 2" foamed-in-place "zero ODP" urethane insulation. Merchandiser may be used as a stand-alone unit or combined in a modular endless design.

Merchandiser will be equipped with standard electronically controlled monitoring system, LED lighting and five cantilever epoxy-coated welded wire shelves with price tag molding per door. In addition, a product stop feature will prevent product from falling

behind shelves. Other standard features to include:

- Condensate vaporizer and condensate pump
- Field installed, sound insulated 24 gauge steel shroud with finish matching cabinet exterior
- Standard joining kits when linking together multi-door modules

Glass doors will be supplied with self-closing door hinge and provision for easy adjustment of torsion and leveling. Merchandiser supplied with 30" wide glass doors.

Door and frame provided in standard black finish with optional colors available.

A pre-charged self-contained refrigeration

system will be furnished with quick connect fittings and lines. Each merchandiser will be equipped with a full-length heavy-duty copper tube evaporator coil and pre-mounted expansion valve. Electric defrost will be standard on low temp models. All models will use R-404A refrigerant.

Temperature range will be 34° to 41°F (1° to 5°C) for TEM models and 0° to -15°F (18° to -26°C) for TEL models.

Merchandiser to have standard limited two year parts and labor with additional three year coverage on compressor part.

Merchandiser to be UL listed and UL EPH classified.

NOTE: Cabinet designed for optimum performance in air-conditioned area at 75°F ambient and 55% relative humidity. All specifications subject to change without notice.



908 Highway 15 North • New Albany, MS 38652
PHONE: 800-647-1284 or 662-534-9061 • FAX: 800-232-3966 or 662-534-6049 • www.master-bilt.com

