



- 304 Stainless Steel top, ends, back and bottom.
- Die cast heavy duty 6" equipment legs with adjustable feet.
- Two (2) adjustable shelves.
- Custom lengths made to order.



Stainless Steel  
**MM-SK24GR**

### Features

**S** Stainless Steel for improved hygiene and durability.

**NSF** Constructed to meet NSF specifications.

# Specifications

Micro Matic reserves the right to change specifications without notice. **AUTOQUOTES**

Part No.	Description	Shipping Weight	Box Dimensions
<input type="checkbox"/> <a href="#">MM-SK24GR*</a>	Polished Stainless Steel	32 kg	TBD
	24" L x 21" D x 30" H	70 lbs.	TBD

\*  Certified

# Dimensions

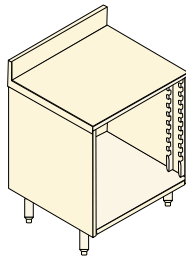
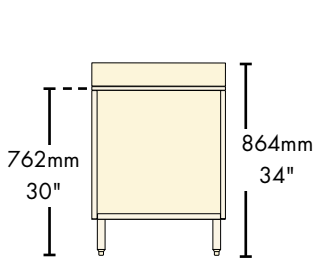
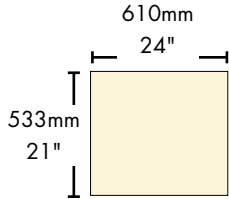

Copyright ©2012 Micro Matic USA, Inc. All Rights Reserved.

00604D0212



[www.micromatic.com](http://www.micromatic.com)

Toll Free: 1-(866) 327-4159

West	Central	Southeast	Northeast
19791 Bahama Street Northridge, CA 91324 Tel. (818) 701-9765 Fax. (818) 701-9844	10726 North Second Street Machesney Park, IL 61115 Tel. (815) 968-7557 Fax. (815) 968-0363	2364 Simon Court Brooksville, FL 34604 Tel. (352) 799-6331 Fax. (352) 796-2429	4601 Saucon Creek Road Center Valley, PA 18034 Tel. (610) 625-4464 Fax. (610) 625-4466