

HYDRA KOOL



PULL OUT
CONDENSING UNIT
ON SELF CONTAINED



PULL OUT EVAP PAN
FOR EASY CLEANING
ON SELF CONTAINED



REAR STORAGE

CURVED GLASS DELI CASE

MEDIUM TEMPERATURE
TILT OUT CURVED
TEMPERED FRONT GLASS
REAR TEMPERED
SLIDING DOORS
DESIGNED FOR DELI PRODUCTS
AND PACKAGED MEAT

MODELS

KPM - CG - (60,80,100) - S

KPM - CG - (60,80,100) - R



REMOTE AND SELF CONTAINED
404A REF - FORCED AIR REFRIGERATION



Tel.: 514.737.9701 / Toll Free: 888.275.4538

Fax: 514.342.3854 / Toll Free: 877.453.8832

sales@mvpgroupcorp.com

www.mvpgroupcorp.com



CURVED GLASS **HYDRA** **KOOL** DELI CASE

SELF CONTAINED	MODEL	O.A LENGTH INCHES	CASE TEMP	ELECTRICAL - 115 VOLTS					WEIGHT	NUMBER OF REAR DOORS
				COMPRESSOR		LIGHTS AND FANS	EVAP PAN	TOTAL AMPS		
				F.L.A.	L.R.A.					
	KPM-CG-60-S	60	32/40 F	8.4	41	1.6	3.3	13.3	470	1
	KPM-CG-80-S	77-1/2	32/40 F	8.4	41	1.6	3.3	13.3	575	2
	KPM-CG-100-S	101-1/8	32/40 F	9.9	49	2.1	3.3	15.6	714	3

REMOTE	MODEL	O.A LENGTH INCHES	CASE TEMP	** 115 VOLTS	B.T.U.	WEIGHT
				TOTAL		
				AMPS		
	KPM-CG-60-R	60	32/40 F	1.1	3260	414
	KPM-CG-80-R	77-1/2	32/40 F	1.2	4209	520
	KPM-CG-100-R	101-1/8	32/40 F	1.7	4845	659

THESE CASES ARE DESIGNED TO OPERATE USING R404A REFRIGERANT

B.T.U.'S CALCULATED AT +14° F EVAP AND 90° F AMBIENT

CASES ENGINEERED TO OPERATE AT 75° F AND 55% RH

** ON REMOTE CASES - IF NO FLOOR DRAIN IS PROVIDED -

AN EVAPORATIVE DRAIN PAN MUST BE ORDERED
ADD 3.3 AMPS WHEN USING A PAN

O.A. DIMENSIONS INCLUDE (2) ENDS - EACH 1-1/2"

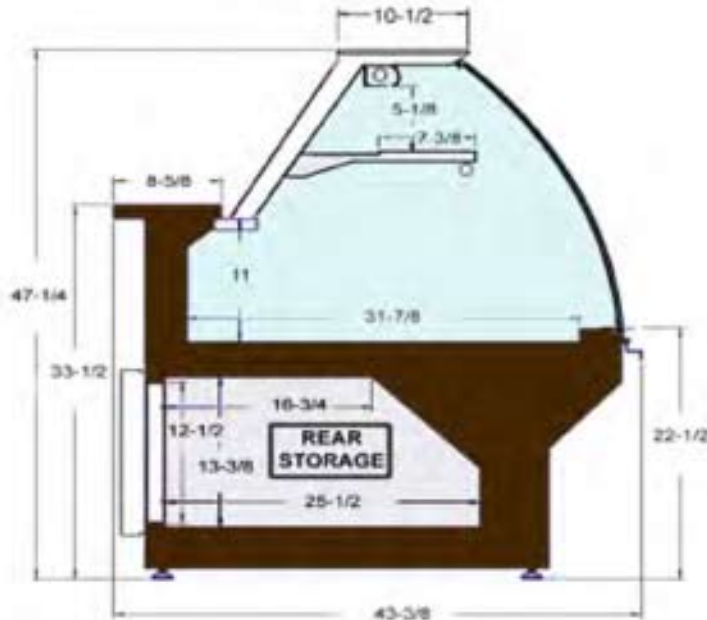

STANDARD FEATURES

- INSULATION - INJECTED FOAM
- INTERIOR - PVC COATED STEEL- GRAY
- EXTERIOR - PVC COATED STEEL-SILVER
- ENDS-FOAMED BLACK POLYSTYRENE
- TILT- FORWARD TEMPERED FRONT GLASS
- CORD AND PLUG
- CASES ARE MULTIPLEXIBLE
- TEMPERED GLASS NON- REFRIGERATED SHELF
- PULL-OUT CONDENSING UNIT -ON SIC ONLY
- REMOVABLE REAR TEMPERED GLASS SLIDING DOORS
- DEFR: ● INSULATION - INJECTED FOAM BY A DIGITAL CONTROLLER
- REMOVABLE EVAPORATIVE PAN FOR EASY CLEANING ON SIC ONLY
- LED LIGHTING IN CANOPY AND UNDER SHELF
- ANTI-CONDENSATE SYSTEM FOR FRONT GLASS
- ADJUSTABLE FEET
- ETL LISTED TO UL471 AND SANITATION CLASSIFIED TO NSF7

OPTIONAL FEATURES

- LIFT UP FRONT GLASS
- CASTERS - ADD 4-3/8" TO HEIGHT
- ADJUSTABLE STAINLESS STEEL LEGS- FROM 5-1/8" TO 7-5/8"
- OTHER COLORS AVAILABLE
- STAINLESS STEEL EXTERIOR
- STAINLESS STEEL INTERIOR
- EVAPORATIVE PAN FOR REMOTE CASES
- WHITE APOXY BI-LEVEL WIRE RACKS
- SCALE STAND WITH RECEPTACLE
- CUTTING BOARD
- (2) OR (3) LEVEL STEP SHAM
- KNIFE SUPPORT

WARRANTY

ONE YEAR PARTS AND LABOR WITH FOUR ADDITIONAL YEARS COMPRESSOR (PARTS ONLY)