

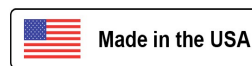

JOB:  
ITEM:  
QTY:



## 99660-MOBILE BANQUET CART

### APPLICATION:

This cart is designed to hold cup and glass racks to deliver and retrieve glasses at banquets.

### MATERIAL:

The framework is constructed out of 1 1/4"x1 1/4"x.070" wall tubing. Removable drip trays are constructed out of .080" aluminum sheet.

### CASTERS:

This cart comes equipped with four 5" medical grade casters, two with brake.

### GUARANTEE:

This cart carries a **Lifetime Guarantee** against rust and corrosion and a **Five-Year Guarantee** against workmanship and material defects.



**MODEL #99660**



Phone: 800-255-0104  
Fax: 877-877-7687  
[www.newageindustrial.com](http://www.newageindustrial.com)  
[sales@newageindustrial.com](mailto:sales@newageindustrial.com)

New Age Industrial reserves the right to modify or make changes at any time without notice to materials and specifications.

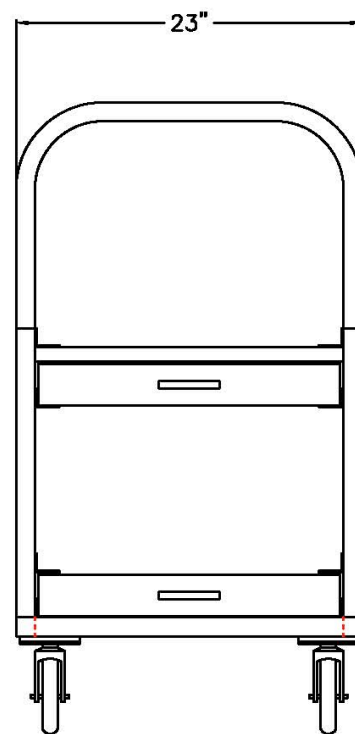
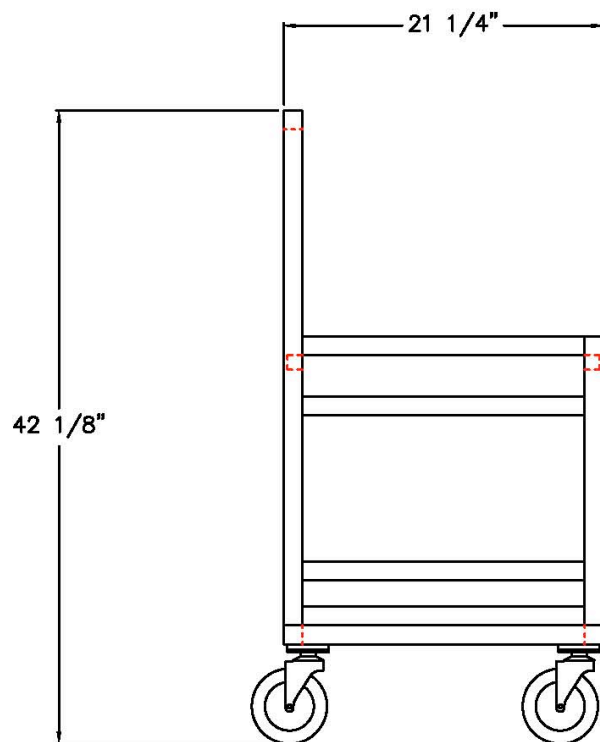

### MODEL #99660

Model No.	Size-W	Size-H	Size-D
99660	23"	42 1/8"	21 1/4"



**NEWAGE**  
INDUSTRIAL  
**NEWAGE**

Phone: 800-255-0104  
Fax: 877-877-7687  
[www.newageindustrial.com](http://www.newageindustrial.com)  
[sales@newageindustrial.com](mailto:sales@newageindustrial.com)

New Age Industrial reserves the right to modify or make changes at any time without notice to materials and specifications.