

NOR-LAKE, INCORPORATED
 727 Second Street
 P.O. Box 248
 Hudson, Wisconsin 54016

800-955-5253
 715-386-2323
 866-961-5253 Parts
 800-388-5253 Service
 715-386-6149 FAX
 www.norlake.com



ADVANTEDGE™ DIRECT DRAW BEER COOLERS



NLDD59

PROJECT:

ITEM NUMBER:

MODEL NUMBER:

DIRECT DRAW BEER COOLERS

SPECIFICATIONS FOR: NLDD24, NLDD59, NLDD69, NLDD79, NLDD95

- **Finish:** Heavy duty stainless steel top, black vinyl coated front, sides and back. Galvanized steel interior walls with stainless steel floor.
- **Insulation:** Foamed-in-place 1-1/2" CFC-Free polyurethane insulation.
- **Hardware:** Solid doors with locks, magnetic door gaskets, plastic breaker strips around door openings to limit the formation of any condensation. Interior fluorescent light (except NLDD24). 3" diameter stainless steel draft towers. Heavy duty stainless steel threshold. Casters standard on NLDD24 model only.
- **Electrical:** 115 volt, 60 Hz, 1 phase with cord and NEMA 5-15P Plug.
- **Refrigeration:** Self-contained forced air R-134a capillary tube refrigeration system. Temperature range from 33°F to 38°F. Draft towers cooled by continuous cold air circulation. Channel air distribution system. Adjustable temperature control.
- **Approvals:** ETL Safety and Sanitation listed

STANDARD FEATURES

- Adjustable temperature control
- Black vinyl steel front, sides and back
- Casters standard on NLDD24 model only
- Fluorescent interior light (except NLDD24)
- Free flowing refrigeration system at all times to ensure uniformly cooled product
- Heavy duty 18 gauge stainless steel top
- 3" diameter polished stainless steel draft tower
- 1 two-way gas manifold (NLDD59 & NLDD69), 1 three-way gas manifold (NLDD79), 1 four-way gas manifold (NLDD95)
- Slide out condensing unit
- Temperature range: 33°F to 38°F
- ETL Safety and Sanitation listed
- Warranties: 1 year parts & labor, 5 year compressor

OPTIONAL FEATURES

- Heavy Duty Mobility Kit (including 3" casters for support)
- Single, double and triple tap draft tower
- Floor rack



Nor-Lake, Inc.
 Registered to ISO 9001:2008
 File No. 10001816

SPECIFICATION
GUIDE

TOP

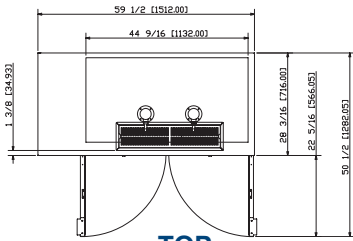

TOP
NLDD59

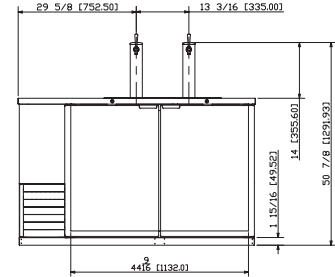

FRONT
NLDD59

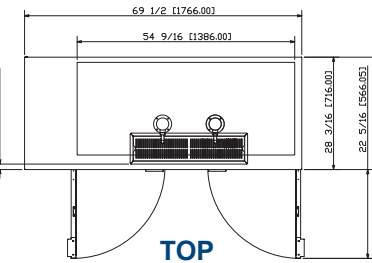

TOP
NLDD69

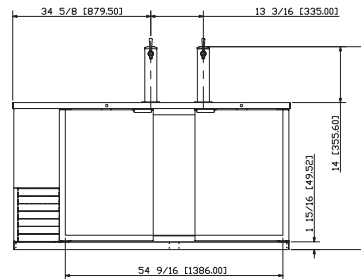

FRONT
NLDD69

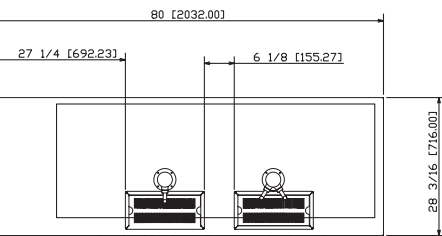

TOP
NLDD79

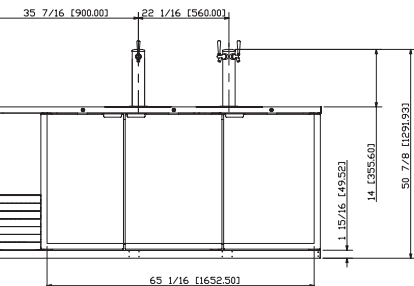

FRONT
NLDD79

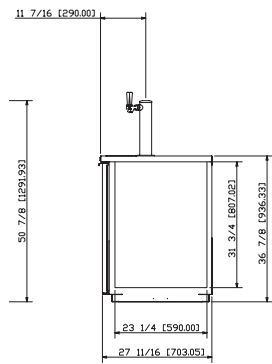

SIDE

NLDD59, 69, 79, 95

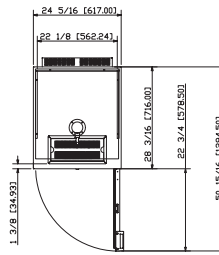

TOP
NLDD24

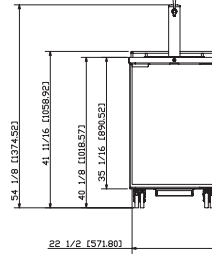

FRONT
NLDD24

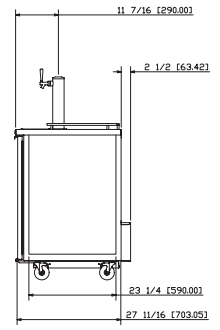

SIDE
NLDD24

SPECIFICATIONS

Model	NLDD24	NLDD59	NLDD69	NLDD79	NLDD95
Crated Height	43"	43"	43"	43"	43"
Crated Width	32-1/4"	60-1/2"	70-1/2"	81"	96-1/2"
Crated Depth	26-1/4"	30"	30"	30"	30"
Crated Weight (lbs.)	181	310	356	375	418
Interior Height	31-13/16"	31-3/4"	31-3/4"	31-3/4"	31-3/4"
Interior Width	20-3/4"	44-9/16"	54-9/16"	65-1/16"	80-9/16"
Interior Depth	20-3/16"	24-3/4"	24-3/4"	24-3/4"	24-3/4"
Overall Height	38-1/8"	36-7/8"	36-7/8"	36-7/8"	36-7/8"
Overall Width	24-1/4"	59-1/2"	69-1/2"	80"	95-1/2"
Overall Depth	30-11/16"	28-3/16"	28-3/16"	28-3/16"	28-3/16"
Gross Cubage (ft. ³)	8.4	23.7	28	30.8	39.2
Number of Towers	1 single	2 single	2 single	1 single 1 double	2 double
Number of Kegs	1	2**	3	4	5
Condensing Unit Size	1/6 HP	1/3 HP	1/3 HP	1/3 HP	1/3 HP
Refrigerant	R134a	R134a	R134a	R134a	R134a
Electrical Characteristics	115/60/1	115/60/1	115/60/1	115/60/1	115/60/1
Cord and Plug Furnished	Yes	Yes	Yes	Yes	Yes
Nema Plug Configuration	5-15P	5-15P	5-15P	5-15P	5-15P
Total Amp Draw	2.5	6.6	6.6	6.6	7.2

Specifications subject to change without notice.

** The NLDD59 will hold (2) 1/2 barrel kegs and (1) slim quarter barrel.

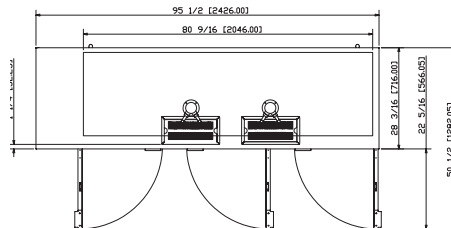

TOP
NLDD95

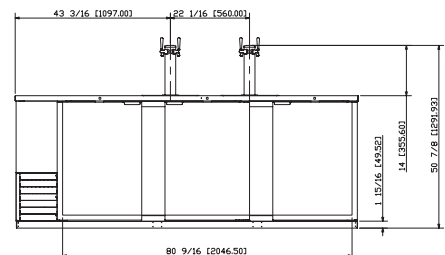

FRONT
NLDD95



NORLAKE®

Revision Date: 06/12
© 2012 NOR-LAKE, INC.
Printed in the U.S.A.
Part Number: 143585