

Perlick® **REFRIGERATED CABINETS**
SELF-CONTAINED DUAL-ZONE BACK BAR REFRIGERATORS



DZS60 shown



DZS36 shown



JOB	
AREA	
ITEM NO.	
MODEL NO.	

DZS60	2-Door Model
DZS36	1-Door Model

MODEL NUMBERS		DZS36	DZS60
NUMBER OF DOORS		1	2
EXTERIOR CABINET DIMENSIONS	Length - in. (mm)	36 (914)	60 (813)
	Depth - in. (mm)	24.75 (629)	24.75 (629)
	Height - in. (mm)	34.565 (878)	34.565 (878)
INTERIOR CABINET DIMENSIONS	Length - in. (mm)	20 (508)	44 (1118)
	Depth - in. (mm)	18.75 (476)	18.75 (476)
	Height - in. (mm)	28.5 (724)	28.5 (724)
INTERNAL VOLUME, Net. Cu. Ft. (liters)		7.1 (201)	15.0 (425)
SHIPPING WEIGHT, Lbs. (kg.)		305 (138)	380 (172)
ELECTRICAL SPECIFICATIONS	Electrical Supply	120 VAC/60 Hz/1 Ph	120 VAC/60 Hz/1 Ph
	Running Load Amps	3.2	5.5
	Electrical Connection	Cord Connected	Cord Connected
	Cord Plug Type	NEMA 5-15	NEMA 5-15
	Cord Length	8'	8'
	Defrost Initiation	Automatic	Automatic
	Defrost Type	Off Cycle	Off Cycle
	Thermostat	Digital Control	Digital Control
REFRIGERATION SPECIFICATIONS	Lighting Type	None	LED
	Horsepower	1/5	1/4
	Refrigerant	R134a	R134a
	Refrigerant Charge	6.5	7.0
	Factory Temperature Setting - Refrigerator	38F (3.3C)	38F (3.3C)
	Temperature Range - Refrigerator	34-42F (1.1-5.6C)	34-42F (1.1-5.6C)
	Factory Temperature Setting - White Wine	45F (7.2C)	45F (7.2C)
	Factory Temperature Setting - Red Wine	60F (15.6C)	60F (15.6C)
	Temperature Range - Wine	40-65F (4.4-18.3C)	44-65F (6.7-18.3C)
	Condensing Unit Location	Left or Right	Left or Right
	Expansion Device	Capillary Tube	Capillary Tube
	Pull-Out Condensing Unit	Yes	Yes
Front Vented	Yes	Yes	
PLUMBING	Floor Drain Included	No	Yes
	Evaporator Condensate	Automatically	Automatically

* These models are for storing non-potentially hazardous bottles and canned product only.



REFRIGERATED CABINETS
SELF-CONTAINED DUAL-ZONE BACK BAR REFRIGERATORS

60" DUAL ZONE

DZS60
 UNIT RIGHT

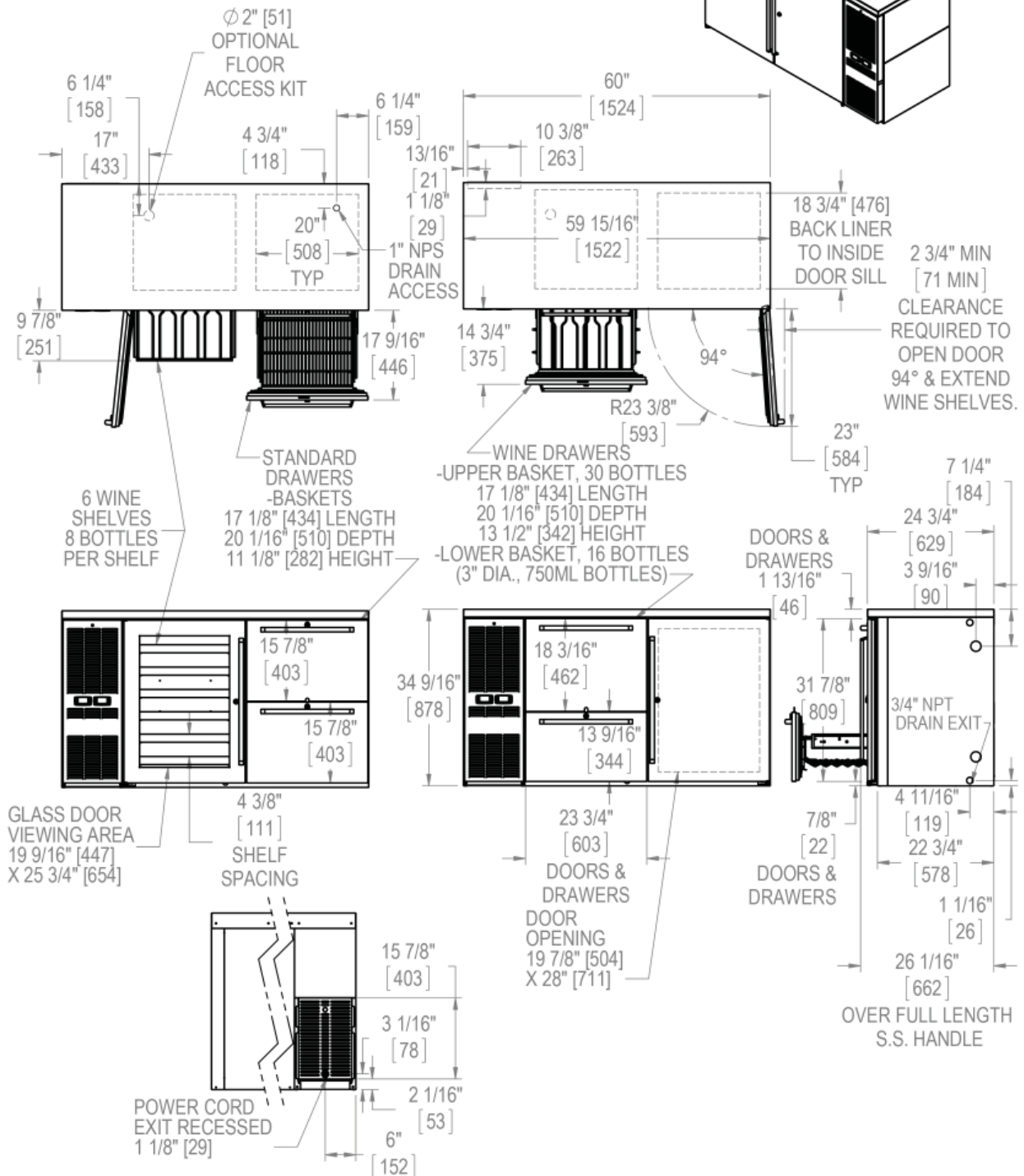

Perlick® REFRIGERATED CABINETS
SELF-CONTAINED DUAL-ZONE BACK BAR REFRIGERATORS

36" DUAL ZONE

DZS36
 UNIT LEFT
 with 4 faucet
 Tee Tower.

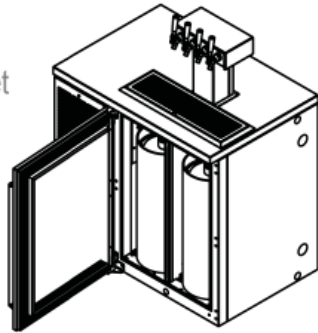

DZS36
 UNIT RIGHT
 with (2) 2 faucet
 Draft Arms.

